

## Career Programs

Career programs provide educational opportunities to pursue one or two-year programs designed to provide knowledge and skills, which will prepare you for immediate employment.

Agriculture Business Management (AAS)  
 Auto Technology (AAS, CERT3)  
 Business Management & Leadership (AAS)  
 Business Administrative Technology (AAS)  
 Business Technology (AAS)  
 Computer Networking Specialist (AAS, CERT2)  
 Corrections (AAS)  
 Criminal Justice (AAS)  
 Crop Protection (AAS, CERT1, CERT2)  
 Dietary Manager (CERT1)  
 Early Childhood (AAS)  
 Emergency Mgmt./Homeland Security (AAS, CERT2)  
 EMS Administration (AAS)  
 Fire Science Technology (AAS)  
 Graphic Design Specialist (AAS)  
 Hazardous Materials Management (AAS, CERT2)  
 Medical Administrative Technology (AAS)  
 Medical Assistant (AAS)  
 Medical Coding (CERT2)  
 Medical Lab Technician (AAS)  
 Medical Transcriptionist (CERT2)  
 Military Technology (CERT2)  
 Mobile Intensive Care Tech (AAS)  
 Natural Gas Trans/Distribution Tech (AAS, CERT1, CERT2)  
 Nursing - ADN (AAS)  
 Nursing - PN (CERT2)  
 Pharmacy Technician (CERT1)  
 Technical Accounting Specialist (AAS)

## Transfer Programs

Transfer programs are designed for students who plan to transfer to a four-year college or university.

Accounting (AA, AS)  
 Agribusiness (AS)  
 Agricultural Economics (AS)  
 Agricultural Education (AS)  
 Agriculture Communications (AS)  
 Agriculture Transfer Option (AS)  
 Agronomy (AS)  
 Animal Science (AS)  
 Anthropology Cultural Studies (AA, AS)  
 Architectural Engineering (AA, AS)  
 Architecture (AA, AS)  
 Art (AA, AS)  
 Art Education (AA, AS)  
 Athletic Training (AA, AS)  
 Auto Technology (AS)  
 Biology (AA, AS)  
 Chemistry (AA, AS)  
 Chiropractic (AA, AS)  
 Computer Forensics (AS)  
 Computer Information Systems (AS)  
 Computer Science (AA, AS)  
 Crime Scene Investigation (AS)  
 Criminal Justice (AS)  
 Cytotechnology (AA, AS)  
 Dance (AA, AS)  
 Dental Hygiene (AA, AS)  
 Dentistry (AA, AS)  
 Dietetics (AS)  
 Drama (AA, AS)  
 Early Childhood Education (AA, AS)  
 Economics (AA, AS)  
 Elementary Education (AA, AS)  
 Engineering (AA, AS)  
 Engineering Tech (AA, AS)  
 English (AA, AS)  
 Environmental Compliance Concentration (AS)  
 Exercise Science (AA, AS)  
 Finance (AA, AS)  
 Food Science (AS)  
 Forensic Science (AA, AS)  
 Forestry (AS)  
 General Business (AA, AS)  
 General Studies (AGS)  
 Geology (AA, AS)  
 Golf Course Management (AS)  
 Graphic Design (AA, AS)  
 Health Information Management (AA, AS)  
 History (AA)  
 Horticulture/Turf Management (AS)  
 Journalism (AA, AS)  
 Law (AA, AS)  
 Law Enforcement - Transfer (AS)  
 Liberal Studies (AA, AS)  
 Management (AA, AS)  
 Marketing (AA, AS)  
 Math Education (AA, AS)  
 Mathematics (AA, AS)  
 Medical Lab Technician (AS)  
 Medical Technology (AA, AS)  
 Medicine (AA, AS)  
 Milling Science (AS)  
 Modern Languages (AA, AS)

Mortuary Science (AA, AS)  
 Music (AA, AS)  
 Music Education (AA, AS)  
 Nursing - ADN (AS)  
 Nursing - Transfer (AA, AS)  
 Occupational Therapy (AA, AS)  
 Optometry (AA, AS)  
 Park Management & Conservation (AS)  
 Pharmacy (AA, AS)  
 Philosophy (AA, AS)  
 Photography (AA, AS)  
 Physical Education (AA, AS)  
 Physical Sciences (AA, AS)  
 Physical Therapy (AA, AS)  
 Physical Therapy Assistant (AA, AS)  
 Physicians Assistant (AA, AS)  
 Physics (AA, AS)  
 Political Science (AA, AS)  
 Pre-Nursing (AS)  
 Psychology (AA, AS)  
 Public Administration (AA, AS)  
 Radiology Technology (AA, AS)  
 Religion (AA, AS)  
 Respiratory Therapy (AA, AS)  
 Secondary Education (AA, AS)  
 Social Sciences (AA, AS)  
 Social Work (AA, AS)  
 Sociology (AA, AS)  
 Special Education (AA, AS)  
 Speech Communications (AA, AS)  
 Sports Administration (AA, AS)  
 Veterinary Medicine (AS)  
 Wildlife Science (AS)



## 2009-2010 Cost Information

LEGAL RESIDENCE IN KANSAS	
Tuition	\$49/credit hour
Fees	\$25/credit hour
LEGAL RESIDENCE OUTSIDE OF KANSAS	
Tuition	\$70/credit hour
Fees	\$25/credit hour
ANNUAL COST ESTIMATES (Kansas resident)	
Tuition & Fees	\$2,368 *based on 16 credit hours per semester
Books & Supplies	\$ 830 (estimated)
Residence Halls	\$4,392 (14 meals per week) *19 meal plan also available - \$4,472
<b>TOTAL</b>	<b>\$7,590 (*Based on 14 meal plan)</b>

The Barton Board of Trustees has the right to change tuition and fees without notice.

### PLANNING TIP

No one should rule out going to college because of cost!

- Fill out the free application for Federal Student Aid [www.fafsa.ed.gov](http://www.fafsa.ed.gov) (Barton's Code: 004608)
- Payment options also available

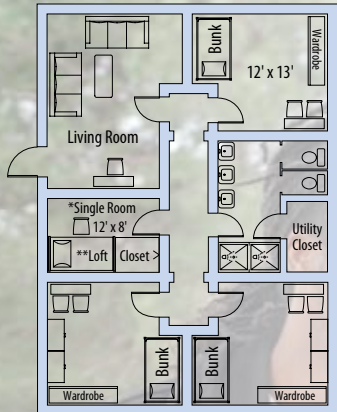

Phase I:  
 There will be some variation between units  
 \*12 Single rooms are located in Phase 1.  
 \*\*Beds must remain lofted.  
 "Community Style" (6-7 people per unit)

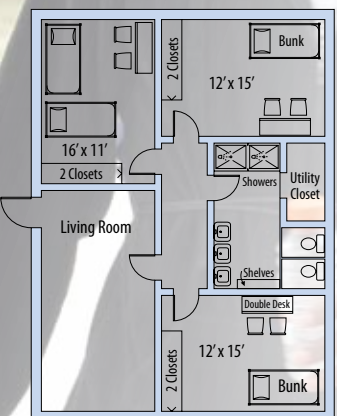

Phase II:  
 There will be some variation between units  
 "Community Style" (6-7 people per unit)

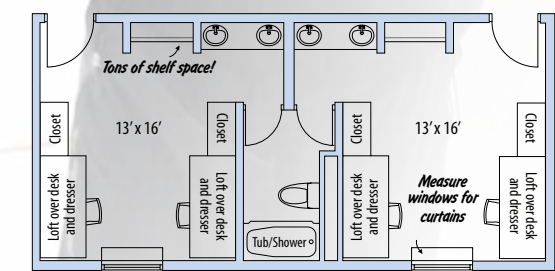

Phase IV: Handicap accessible rooms available  
 "Traditional Style" (2 people per room)

## Student Housing

**FREE** Cable  
 Laundry facilities  
 Internet Access  
 Parking  
 Movie Channel

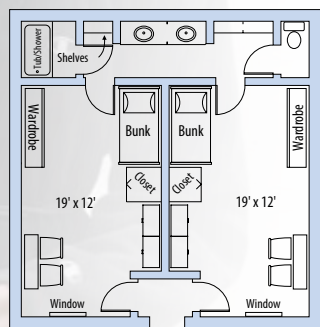

Phase III:  
 Two rooms, double occupancy  
 "Apartment Style" (2 people per room)



Tours are scheduled Monday through Friday, 8 a.m. - 3 p.m.  
 Tour times fill quickly, so don't delay! Give us at least a week's notice, and we'll get your visit scheduled to fit YOUR needs!  
 Call 800-722-6842 to schedule a tour today!



## Home to 54 National Championships!

### MEN'S SPORTS

Baseball  
 Basketball  
 Cheer Squad  
 Cross Country  
 Dance  
 Golf  
 Soccer  
 Tennis  
 Track

### WOMEN'S SPORTS

Basketball  
 Cheer Squad  
 Cross Country  
 Dance  
 Golf  
 Soccer  
 Softball  
 Tennis  
 Track  
 Volleyball



# WHAT DRIVES YOU?



# See You Soon!

## Cougar Checklist

**Campus Tour** - A great way to see if Barton is the place for you!

**Admissions/Scholarship Application** - Remember Barton's academic scholarship deadline is March 15. Application available online.

**Submit ACT Scores or ASSET test scores** - Haven't taken either of these assessment tests? No problem! Just give us a call and we'll get you taken care of.

**Submit completed transcripts** - Completed transcripts must be mailed directly to Barton Admissions Office to be official. Unofficial transcripts can be used for advising and obtaining academic information (GPA, ACT Scores, etc)

**Housing Application** - Submit application and deposit early to get your first choice! Application available online.

**Financial Aid** - Never rule out the cost of going to college. Visit [www.fatsa.ed.gov](http://www.fatsa.ed.gov) for federal assistance or call us with even more options!

For more information, call the Admissions Office at 1-800-722-6842 or (620) 792-9286

**Non-Discrimination Notice:** To provide equal employment, advancement and learning opportunities to all individuals, employment and student admission decisions at Barton will be based on merit, qualifications, and abilities. Barton County Community College does not discriminate on the basis of any characteristics protected by law in all aspects of employment and admission in its education programs or activities. Any person having inquiries concerning Barton County Community College's non-discrimination compliance policy, including the application of Equal Opportunity Employment, Titles IV, VI, VII, IX, Section 504 and the implementing regulations, is directed to contact the College's Compliance Officer, Barton County Community College, Room A-123, Great Bend, Kansas 67530 (620) 792-9234. Any person may also contact the Director, Office of Civil Rights, U.S. Department of Education, Washington, DC 20201.

## DIRECTORY INFORMATION

### WEB ADDRESS

[www.bartonccc.edu](http://www.bartonccc.edu)

### BARTON COUNTY CAMPUS (main campus)

#### Local

(620) 792-2701

#### Toll-Free

1-800-748-7594

#### Address

245 NE 30 RD  
Great Bend, KS 67530

### FORT RILEY CAMPUS

#### Local

(785) 784-6606

#### Toll-Free

1-877-620-6606

#### Address

R.O. Box 2463, Building 217  
Fort Riley, KS 66442

<http://fr.bartonccc.edu>

### GRANDVIEW PLAZA OUTREACH SITE

#### Local

(785) 238-8550

#### Toll-Free

1-877-771-0255

#### Address

100 Continental Avenue  
Grandview Plaza, KS 66441

### ONLINE LEARNING OPPORTUNITIES

[www.bartonline.org](http://www.bartonline.org)

1-877-620-6606

[www.edukan.org](http://www.edukan.org)

1-877-433-8526

**BARTON**  
40th Anniversary  
COMMUNITY COLLEGE  
1969-2009

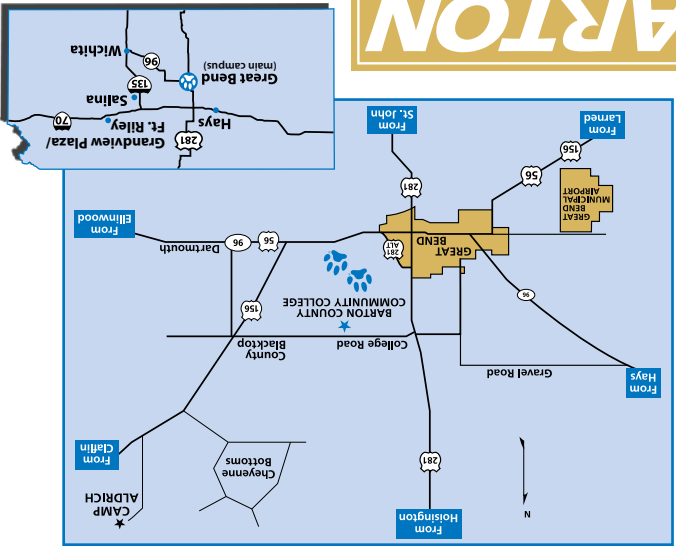

# BARTON

## COMMUNITY COLLEGE

WWW.BARTONCCC.EDU  
800-722-6842 • GREAT BEND, KS

# WHAT DRIVES YOU?