



WHAT

drives YOU?



BARTON

COMMUNITY COLLEGE

WWW.GOBARTON.COM

2010-11 Calendar Viewbook



Living the DREAM

Succeeding in class is important but so is succeeding in life. At Barton the knowledge you learn in the classroom will help you apply it to what really matters...real life.

There are many benefits for students choosing Barton and usually differ according to one's needs, desires, and what one wants from the Barton experience.



The convenience of Barton's class scheduling is a plus for others. Whether you want face-to-face traditional classroom settings, online classes adapting to your busy schedule, or hybrid classes which blend classroom and online instruction, Barton has classes to fit your needs and schedule.

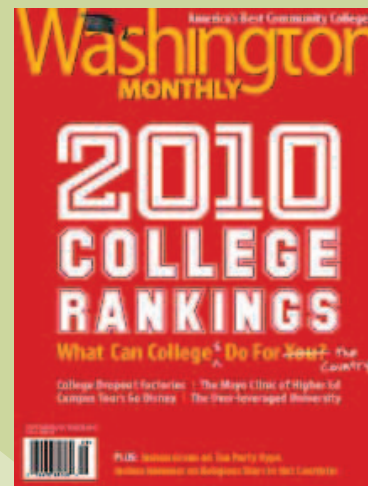

TOP 50 COMMUNITY COLLEGE IN AMERICA!

Barton Community College has been named one of America's 50 best community colleges by Washington Monthly magazine in its September '10 issue. Washington Monthly's top rankings are based upon what schools are doing for the country such as improving social mobility, producing research, and promoting public service.

Bolstered by its high percentage rate of students who went on to complete four-year degrees, Barton's 70% graduation rate ranks fifth among the colleges that made the list.

Barton also offers the opportunity to get job training quickly to help you either get to the workforce or improve your skills at your current workplace.





For some, it's knowing the faculty and staff at Barton truly care about you as a person first and foremost.

Shanna really cares about her students. You can tell she really wants you to understand the material she is teaching by going above and beyond to help you grasp how to find the solution to the problems. To her, you aren't just another student; she really cares about you as a person.

-Jessica Couture

INDEX

Living the Dream	
October Student Life
November Campus Visit
December Cougar Sports
January Career Programs
February Transfer Programs
March On-campus Housing Financial Aid
April Student Support
May Activities & Organizations
June Fitness
July Distance & Online Learning
August Local Opportunities
About our Campuses & Campus Map	
Campus Renovations & Enhancements	
Campus Directory	

If you have the desire to have a dynamic and fun college experience, Barton provides opportunities to get involved, perhaps even "re-inventing oneself." With over 30 clubs, organizations, and performance groups there is something for everyone to live the dream!



Barton has over 50 fun student activities planned throughout the year!

IMAGINE the fun!

Student life at Barton includes the planning of many on and off campus activities. Activities are planned to create a safe and friendly environment for our tight-knit student body to interact, including involvement with our surrounding communities. At Barton, there is a place for

EVERYONE to fit in.



Hawaiian Luau
Mardi Gras Celebration

Mix and Mingle Bingo
Homecoming

Bowling Nights
Drive-In Movies on Campus

The Dome Theatre Experience
Bongo Ball

\$3 Movie Nights

For those who feel like having a relaxing evening at home, Barton's exclusive CATV (channel 52), offers a variety of both "classics" and recently released movies to be viewed on a daily basis. You can enjoy 12 new movie releases per month without even leaving the comforts of your couch.

Memories for the making!

BARTON
COMMUNITY COLLEGE

OCTOBER

SEPTEMBER
S M T W T F S
1 2 3 4
5 6 7 8 9 10 11
12 13 14 15 16 17 18
19 20 21 22 23 24 25
26 27 28 29 30

NOVEMBER
S M T W T F S
1 2 3 4 5 6
7 8 9 10 11 12 13
14 15 16 17 18 19 20
21 22 23 24 25 26 27
28 29 30

20
10

SUNDAY	MONDAY	TUESDAY	WEDNESDAY	THURSDAY	FRIDAY	SATURDAY
						
		<i>Catch up on all the latest campus news and happenings at hilltopics.bartonccc.edu</i>				
3	4	5	6	7	8	9
Baseball All-Star Game at Kaufman Stadium Women's Soccer vs Johnson County 1 p.m. at Barton Men's Soccer vs Johnson County 3 p.m. at Barton Softball at Colby Tournament Women's Golf at Goodland	Volleyball vs Pratt 6:30 p.m. at Pratt Women's Golf at Goodland Men's Golf at Andover Fine Arts Sneak Preview 7:30 p.m. at Fine Arts Auditorium	Baseball vs Dodge City 4 p.m. at Dodge City	The Dome (Planetarium Theater) 3 - 9 p.m. Volleyball vs Hutchinson 6:30 p.m. at Barton	Women's Soccer vs Dodge City 2 p.m. at Barton Men's Soccer vs Dodge City 4 p.m. at Barton	Financial Aid Payout Volleyball vs Air Force Prep at Air Force Prep Baseball Sophomore Showcase at Kaufman Stadium Cross Country at ESU Invitational - Emporia	Baseball All-Star Game at Kaufman Stadium Softball at Colby Tournament Trips to the Salina Mall 11 a.m.-? Volleyball at Northern Oklahoma Tournament - Enid, OK Cross Country at McPherson Invitational - McPherson
10	11	12	13	14	15	16
	Columbus Day Volleyball vs Friends JV 6 p.m. at Barton		Baseball vs Dodge City 4 p.m. at Barton Volleyball vs Cloud 6:30 p.m. at Barton	\$3 Movie Night, Village Cinema	Financial Aid Payout Volleyball vs Air Force Prep at Air Force Prep	National Boss' Day Volleyball vs Air Force Prep at Air Force Prep Men's Soccer vs Kansas City 3 p.m. at Barton
17	18	19	20	21	22	23
Women's Soccer vs Hutchinson 3 p.m. at Barton Women's Golf at Coffeyville	Free Bingo 6 p.m., Union Women's Golf at Coffeyville	Volleyball vs Colby 6:30 p.m. at Colby		Fall Break (No Classes/Offices Open) All Faculty Meeting	Fall Break (No Classes/Offices Open) Volleyball vs Pratt 6 p.m. at Barton Baseball Alumni Weekend	Baseball Alumni Weekend
24/31	25	26	27	28	29	30
Baseball Alumni Weekend Halloween	\$3 Movie Night, Village Cinema Volleyball vs Seward 6:30 p.m. at Seward	Jack Kilby Science Day	Volleyball vs Garden City 6:30 p.m. at Garden City	Student Recital 7:30 p.m. in Morrison Chapel	Financial Aid Payout	

DISCOVERING new possibilities!



Why do YOU need to come on a tour at Barton?

You need to come and enjoy the personalized tour of Barton to guarantee with we are the perfect match for you! We want you to come visit with our Faculty and Staff, tour the Campus and Housing, eat a FREE lunch in our fabulous dining facility, and have a GREAT time! We welcome family and friends to come on the tour as well.

Tours are scheduled Monday - Friday, 8:30 a.m. - 3 p.m. Tour times fill quickly, so don't delay! Give us at least a week's notice, and we'll get your visit scheduled to fit YOUR needs! Call 800-722-6842 to schedule a tour today!

What Major are you interested in?

You will meet with an Academic Advisor to discuss all of the opportunities and possibilities for your future program of study and classes you will be taking.

How much will college cost?

We would be more than happy to go over any Financial Aid questions while you are here. Also, if you are looking for scholarship possibilities, we would be happy to arrange a visit with any sport, activity, or organization you might be interested in to see if scholarships are available for you!

How do I become a Barton Cougar?

A member of the Admissions Staff will visit with you regarding any questions you may have to help get you started on the path to becoming a Cougar.



When I came to Barton I had no idea where to start. Sherri Henry did a great job of explaining what classes I needed and helped me develop a game plan of what classes would be best for my major and my future.
-Jesus Loera

We'd love to meet you!



NOVEMBER

OCTOBER

S	M	T	W	T	F	S
					1	2
3	4	5	6	7	8	9
10	11	12	13	14	15	16
17	18	19	20	21	22	23
24	25	26	27	28	29	30
31						

DECEMBER

S	M	T	W	T	F	S
				1	2	3
4	5	6	7	8	9	10
11	12	13	14	15	16	17
18	19	20	21	22	23	24
25	26	27	28	29	30	31

20
10

SUNDAY	MONDAY	TUESDAY	WEDNESDAY	THURSDAY	FRIDAY	SATURDAY
	1 Men's BB vs Bethany JV 7 p.m. at Barton	2 Election Day Women's BB vs Bethany JV 6 p.m. at Barton	3 Volleyball Region IV Tourney TBA	4 Seminar Series: I.D. Thief 6:30 p.m., Union	5 Financial Aid Payout Last Day to Drop with Courses Recorded as "W" on Transcript Barton Forensics Tournament	6 Barton Forensics Tournament Volleyball Region IV Tourney TBA Men's BB vs Hesston College 7 p.m. at Hesston
7 Barton Forensics Tournament Volleyball Region IV Tourney TBA Daylight Savings Time Ends	8	9 Advisement Day (No Day Classes)	10 Spring 2011 Priority Registration Begins \$3 Movie Night, Village Cinema	11 Veteran's Day	12 Financial Aid Payout Barton Classic: Women's BB vs Coffeyville 5 p.m. at Barton Men's BB vs Quakerdale Prep 7 p.m. at Barton	13 Barton Classic: Women's BB vs Independence 5 p.m. at Barton Men's BB vs Frank Phillips 7 p.m. at Barton
14	15	16 Free Bingo 6 p.m., Union Men's BB vs Brown Mackie 7 p.m. at Barton Instrumental Concert 7:30 p.m. at Fine Arts Auditorium	17	18 Free Bowling 7:30-10:30 p.m., Eagle Lanes – Ellinwood	19 Financial Aid Payout Booster Club Classic: Women's BB vs Grayson County CC 5 p.m. at Barton Men's BB vs Quakerdale Prep 7 p.m. at Barton Fall Play: "Mass Appeal" 7:30 p.m. in Morrison Chapel	20 Booster Club Classic: Women's BB vs Labette 5 p.m. at Barton Men's BB vs Independence 7 p.m. at Barton Fall Play: "Mass Appeal" 7:30 p.m. in Morrison Chapel
21 Fall Play: "Mass Appeal" 2 p.m. in Morrison Chapel	22 Men's BB vs McPherson College 7 p.m. at Barton Smokey Hill Christmas Concert (taping) 7 p.m. at Fine Arts Auditorium	23 Women's BB vs Cowley 6 p.m. at Cowley	24 Thanksgiving Break (No Classes/Offices Closed) Shafer Gallery Closed	25 Thanksgiving Break (No Classes/Offices Closed) Shafer Gallery Closed	26 Thanksgiving Break (No Classes/Offices Closed) Shafer Gallery Closed Pratt Thanksgiving Classic: Women's BB vs Howard CC, 1 p.m. at Pratt Hutchinson Classic: Men's BB vs Hill College, 3p.m. at Hutch	27 Pratt Thanksgiving Classic: Women's BB vs Frank Phillips CC 1 p.m. at Pratt Hutchinson Classic: Men's BB vs Ranger 3 p.m. at Hutchinson
28	29 \$3 Movie Night, Village Cinema Men's BB vs New Creations Basketball Academy 7 p.m. at Barton	30 Women's BB vs Crowder 6 p.m. at Barton			<i>Catch up on all the latest campus news and happenings at hilltopics.bartonccc.edu</i>	
						

STRIVING for excellence

MEN'S SPORTS

- Baseball
- Basketball
- Cross Country
- Golf
- Soccer
- Tennis
- Track

WOMEN'S SPORTS

- Basketball
- Cross Country
- Golf
- Soccer
- Softball
- Tennis
- Track
- Volleyball

In **40** years of athletic competition,
 Barton has **55** national titles,
139 region or district championships,
154 conference championships,
 over **50** professional athletes,
22 Olympians, and
10 Olympic Medal winners.



Fletcher made my time at Barton enjoyable as he brought a great attitude to practice every day which carried over to everyone else. Not only was he energetic and encouraging on the basketball floor, but he placed education as his player's top priority.
 -Dennan Morrow

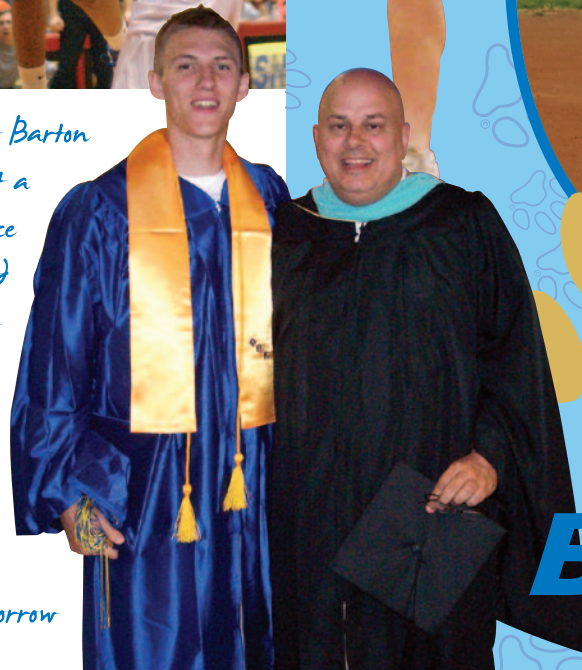

DECEMBER

NOVEMBER
S M T W T F S
1 2 3 4 5 6
7 8 9 10 11 12 13
14 15 16 17 18 19 20
21 22 23 24 25 26 27
28 29 30

JANUARY
S M T W T F S
1
2 3 4 5 6 7 8
9 10 11 12 13 14 15
16 17 18 19 20 21 22
23 24 25 26 27 28 29
30 31

20
10

SUNDAY	MONDAY	TUESDAY	WEDNESDAY	THURSDAY	FRIDAY	SATURDAY
<i>Hilltopics</i>	Catch up on all the latest campus news and happenings at hilltopics.bartonccc.edu		Men's BB vs Hesston College 7 p.m. at Barton	Student Recital 7:30 p.m. in Morrison Chapel	Financial Aid Payout Hutchinson Classic: Women's BB vs Friends JV 1:30 p.m. at Hutchinson	Hutchinson Classic: Women's BB vs Northwest Shoals CC 1:30 p.m. at Hutchinson Jingle Bell Swing 8 p.m. at American Legion
5	6	7	8	9	10	11
	Spring 2011 Regular Registration Begins Free Shoulder Massages 6-9 p.m., Union Men's and Women's BB vs Southwestern JV 5 p.m. at Barton 7 p.m. at Barton Holiday Concert 7:30 p.m. at Fine Arts Auditorium	Free Late Night Breakfast 10-11 p.m., Union	Final Exam Day	Final Exam Day	Financial Aid Payout Final Exam Day Close of Fall 2010 Semester Spring 2011 Priority Registration Ends	Women's BB vs Labette 5 p.m. at Labette
12	13	14	15	16	17	18
	No Classes/Offices Open	No Classes/Offices Open Summer 2011 Priority Registration Begins	No Classes/Offices Open	No Classes/Offices Open	No Classes/Offices Open	Campus Closed Shafer Gallery Closed
19	20	21	22	23	24	25
Campus Closed Shafer Gallery Closed	Campus Closed Shafer Gallery Closed	Campus Closed Shafer Gallery Closed Winter Begins	Campus Closed Shafer Gallery Closed	Campus Closed Shafer Gallery Closed	Campus Closed Shafer Gallery Closed Christmas Eve	Campus Closed Shafer Gallery Closed Christmas Day
26	27	28	29	30	31	
Campus Closed Shafer Gallery Closed	Campus Closed Shafer Gallery Closed	Campus Closed Shafer Gallery Closed	Campus Closed Shafer Gallery Closed	Campus Closed Shafer Gallery Closed	Campus Closed Shafer Gallery Closed New Year's Eve	

Put your **PASSION** to work!

Career Technical Education Programs

Career technical education programs offer you an opportunity to pursue certificate and degree programs designed to prepare you for employment in the workplace and/or transfer to a university.

DEGREE CODES

- AAS - Associate in Applied Science
- C- Certificate
- NDS - Non-degree seeking
- SAP - Stand alone program
- * - Emphasis of Study



You learn a lot from Darcy in class if you pay attention. He does a great job of explaining what we need to know and is always very thorough on answering questions.

-Anthony Phillips

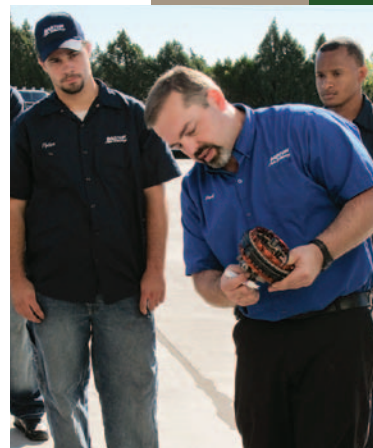

- Accounting - Technical Specialist (AAS)
- Administrative Assistant*
- Adult Health Care
 - Activity Director (NDS)
 - Certified Medication Aide (SAPP)
 - Certified Nurse Aide (SAPP)
 - Home Health Aide (SAPP)
 - Rehabilitation Aide (SAPP)
- Agriculture Business Management (AAS)
 - Crop or Livestock Production*
- Automotive Technology (AAS, C)
- Business Administrative Technology (AAS)
 - Administrative Assistant*
- Business Management and Leadership (AAS)
- Business Technology (AAS)
- Computer Networking Specialist (AAS, C)
- Corrections (AAS)
- Criminal Justice (AAS)
- Crop Protection (AAS, C)
- Dietary Manager (C)
- Early Childhood (AAS)
- Emergency Management/Homeland Security (AAS, C)
- Emergency Services Education
 - Emergency Medical Services Administration (AAS)
 - Emergency Medical Technician - Basic (SAPP)
 - Emergency Medical Technician - Intermediate (SAPP)
 - First Responder (SAPP)
 - Paramedic - Mobile Intensive Care Technician (AAS)

- Fire Science Technology (AAS)
 - Contact the EMS Office at (620) 792-9341 for details
- Hazardous Materials Management (AAS, C)
- Manufacturing Skills Certificate (SAPP)
- Medical Administrative Technology (AAS)
- Medical Assistant (AAS)
- Medical Coding (C)
- Medical Laboratory Technician (AAS)
- Medical Transcriptionist (C)
- Military Technology (C)
- Natural Gas Transmission & Distribution Technician (AAS, C)
- Nursing
 - IV Therapy (SAPP)
 - Practical Nursing - PN (C)
 - Associate Degree Nursing – ADN (AAS)
 - Students passing the state exams become a Licensed Practical Nurse or a Registered Nurse
- Pension Administration* (SAPP)
- Pharmacy Tech (C)
- Phlebotomy Training (SAPP)
- Tech Accounting Specialist (AAS)



BARTON

COMMUNITY COLLEGE

JANUARY

DECEMBER
S M T W T F S
1 2 3 4
5 6 7 8 9 10 11
12 13 14 15 16 17 18
19 20 21 22 23 24 25
26 27 28 29 30 31

FEBRUARY
S M T W T F S
1 2 3 4 5
6 7 8 9 10 11 12
13 14 15 16 17 18 19
20 21 22 23 24 25 26
27 28

20
11

SUNDAY	MONDAY	TUESDAY	WEDNESDAY	THURSDAY	FRIDAY	SATURDAY
						
2	3	4	5	6	7	8
Campus Closed Shafer Gallery Closed Men's BB vs Brown Mackie 2 p.m. at Brown Mackie	No Classes/Offices Open	No Classes/Offices Open	No Classes/Offices Open Professional Conference Day Women's BB vs Cloud 6 p.m. at Cloud Men's BB vs Cloud 8 p.m. at Cloud	No Classes/Offices Open Professional Conference Day	Spring 2011 Regular Registration Ends No Classes/Offices Open Professional Conference Day	Campus Closed Shafer Gallery Closed New Year's Day Women's BB vs Seward 6 p.m. at Seward Men's BB vs Seward 8 p.m. at Seward
9	10	11	12	13	14	15
	Spring 2011 Classes Begin Spring 2011 Late Registration Begins		Women's BB vs Dodge City 6 p.m. at Barton Men's BB vs Dodge City 8 p.m. at Barton	\$3 Movie Night, Village Cinema	Spring 2011 Late Registration Ends	Women's BB vs Garden City 5:30 p.m. at Garden City Men's BB vs Garden City 7:30 p.m. at Garden City
16	17	18	19	20	21	22
	Martin Luther King Jr. Day (No Classes/Offices Closed) Women's BB vs Butler 6 p.m. at Barton Men's BB vs Butler 8 p.m. at Barton		Women's BB vs Hutchinson 5:30 p.m. at Hutchinson Men's BB vs Hutchinson 7:30 p.m. at Hutchinson	Free Bowling 7:30-10:30 p.m., Eagle Lanes – Ellinwood	Last Day for Refund	
23/30	24/31	25	26	27	28	29
	\$3 Movie Night, Village Cinema Free Shoulder Massages 6-9 p.m., Union		Women's BB vs Colby 6 p.m. at Barton Men's BB vs Colby 8 p.m. at Barton			Women's BB vs Pratt 6 p.m. at Pratt Men's BB vs Pratt 8 p.m. at Pratt

Getting you to the **NEXT LEVEL**

Transfer Programs

Transfer programs are designed to prepare you for transferring from Barton to a four-year college or university.

DEGREE CODES

AS - Associate in Science

AA - Associate in Arts

AGS - Associate in General Studies

* - Emphasis of Study

Accounting (AS)
 Agribusiness (AS)
 Agricultural Economics (AS)
 Agricultural Education (AS)
 Agriculture Communications (AS)
 Agriculture Transfer Option (AS)
 Agronomy (AS)
 Animal Science (AS)
 Anthropology Cultural Studies (AA, AS)
 Architectural Engineering (AA, AS)
 Architecture (AA, AS)
 Art (AA, AS)
 Art Education (AA, AS)
 Athletic Training (AA, AS)
 Auto Technology (AS)
 Biology (AA, AS)
 Business (AS)
 Chemistry (AA, AS)
 Chiropractic (AA, AS)
 Computer Information Systems (AS)
 Computer Science (AS)
 Criminal Justice (AS)
 Dance (AA, AS)
 Dental Hygiene (AA, AS)
 Dentistry (AA, AS)
 Dietary Management (AS)
 Dietetics (AS)
 Drama (AA, AS)
 Early Childhood Education (AA, AS)
 Economics (AS)
 Elementary Education (AA, AS)
 Engineering (AA, AS)

Engineering Tech (AA, AS)
 English (AA, AS)
 Environmental Compliance Concentration (AS)
 Exercise Science (AA, AS)
 Finance (AS)
 Food Science (AS)
 Forensic Science (AA, AS)
 Forestry (AS)
 General Studies (AGS)
 Geology (AA, AS)
 Golf Course Management (AS)
 Graphic Design (AA)
 Health Information Management (AA, AS)
 History (AA)
 Horticulture/Turf Management (AS)
 Journalism (AA, AS)
 Law (AA, AS)
 Law Enforcement - Transfer (AS)
 Liberal Studies (AA, AS)
 Management (AS)
 Marketing (AS)
 Math Education (AA, AS)
 Mathematics (AA, AS)
 Medical Lab Technician (AS)
 Medicine (AA, AS)
 Military Studies (AGS)
 Milling Science (AS)
 Modern Languages (AA, AS)
 Mortuary Science (AA, AS)
 Music (AA, AS)
 Music Education (AA, AS)
 Nursing - ADN (AS)
 Nursing - Transfer (AA, AS)
 Occupational Therapy (AA, AS)
 Optometry (AA, AS)
 Park Management & Conservation (AS)
 Pharmacy (AA, AS)
 Philosophy (AA, AS)
 Photography (AA, AS)

Physical Education (AA, AS)
 Physical Sciences (AA, AS)
 Physical Therapy (AA, AS)
 Physical Therapy Assistant (AA, AS)
 Physicians Assistant (AA, AS)
 Physics (AA, AS)
 Political Science (AA, AS)
 Pre-Nursing (AS)
 Psychology (AA, AS)
 Public Administration (AA, AS)
 Radiology Technology (AA, AS)
 Religion (AA, AS)
 Respiratory Therapy (AA, AS)
 Secondary Education (AA, AS)
 Social Work (AA, AS)
 Sociology (AA, AS)
 Special Education (AA, AS)
 Speech Communications (AA, AS)
 Sports Administration (AA, AS)
 Veterinary Medicine (AS)
 Wildlife Science (AS)

Mrs. B is the BEST! - Morgan Riedl



BARTON

COMMUNITY COLLEGE

FEBRUARY





JANUARY

S	M	T	W	T	F	S
						1
2	3	4	5	6	7	8
9	10	11	12	13	14	15
16	17	18	19	20	21	22
23	24	25	26	27	28	29
30	31					

MARCH

S	M	T	W	T	F	S
		1	2	3	4	5
6	7	8	9	10	11	12
13	14	15	16	17	18	19
20	21	22	23	24	25	26
27	28	29	30	31		

20
11

SUNDAY	MONDAY	TUESDAY	WEDNESDAY	THURSDAY	FRIDAY	SATURDAY
6  Baseball vs Odessa at Odessa, TX	7 Free Bingo 6 p.m., Union Women's BB vs Dodge City 5:30 p.m. at Dodge City Men's BB vs Dodge City 7:30 p.m. at Dodge City	1 Homecoming Election 8-1 p.m., Union Priority Deadline to Apply for Spring 2011 Graduation	2 Groundhog Day Women's BB vs Cloud 6 p.m. at Barton Men's BB vs Cloud 8p.m. at Barton	3	4 Baseball vs Odessa at Odessa, TX	5 Women's BB vs Seward 6 p.m. at Barton Men's BB vs Seward 8 p.m. at Barton Homecoming (crowning between games) Baseball vs Odessa at Odessa, TX
13	14 Valentine's Day	8	9 Women's BB vs Garden City 6 p.m. at Barton Men's BB vs Garden City 8 p.m. at Barton	10 \$2 Movie Night, Village Cinema (Homecoming Special)	11	12 Baseball vs Northern Oklahoma 2 p.m. at Enid, OK Women's BB vs Butler 5:30 p.m. at Butler Men's BB vs Butler 7:30 p.m. at Butler
20 Baseball vs McCook 1 p.m. at Barton Softball at Midland College Tournament	21 President's Day \$3 Movie Night, Village Cinema	15	16 Women's BB vs Hutchinson 6 p.m. at Barton Men's BB vs Hutchinson 8 p.m. at Barton	17 Free Bowling 7:30-10:30 p.m., Eagle Lanes – Ellinwood	18 Financial Aid Payout Baseball vs Western Nebraska 2 p.m. at Barton	19 Baseball vs Western Nebraska 1 p.m. at Barton Softball at Midland College Tournament
27 Softball vs Cloud Noon & 2 p.m. at Barton	28 Baseball vs Garden City 1 p.m. at Garden City	22 Video Dance Homecoming Party 9 p.m.-1 a.m., Union	23 Softball vs Pratt 2 p.m. & 4 p.m. at Pratt Women's BB vs Colby 6 p.m. at Colby Men's BB vs Colby 8 p.m. at Colby	24	25 Softball vs Western Nebraska 2 p.m. & 4 p.m. at Barton	26 Baseball vs Garden City 1 p.m. at Garden City Women's BB vs Pratt 6 p.m. at Barton Men's BB vs Pratt 8 p.m. at Barton
		Hilltopics	<i>Catch up on all the latest campus news and happenings at hilltopics.bartonccc.edu</i>			

IMAGINE the fun!

Nothing spells fun more than living in a community of 292 of your fellow classmates from all across the world. You will have the opportunity to meet new people, begin life-long friendships, and develop life learning skills.

Barton considers Student Housing an important part of your total education. Comfortable living conditions have a major influence on your academics, habits, attitudes and ideals. Your social life, loyalty to the college, attitude toward others, and your sense of belonging evolve from the community you'll join in Student Housing.

FEATURES

- Wireless internet campus-wide including student housing
- Two FREE Laundromats
- Meal plan includes 19 meals per week
- Housing for 292 students including 12 single rooms
- Phone service
- FREE cable available in each room including free movie channels
- Plenty of spaces in student housing parking lots and no additional fee for a parking permit
- Tennis courts
- Vending machines for snacks, beverages and laundry supplies
- A study desk and wardrobe area as well as extra long twin beds, bunked or lofted, in each room
- Community meeting room with big-screen color television and a Wii game console
- Special accommodations for students with disabilities
- Do-it-yourself kitchen areas available with stove, microwave, refrigerator and ice machine
- Housing complex area storm shelter
- 24-hour security and camera surveillance
- Two Eco-friendly drinking water stations

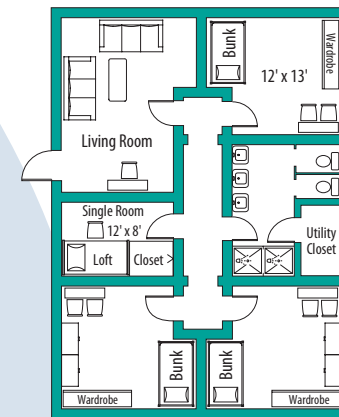

Bluestem Halls:
There will be some variation between units "Community Style" (6-7 people per unit)

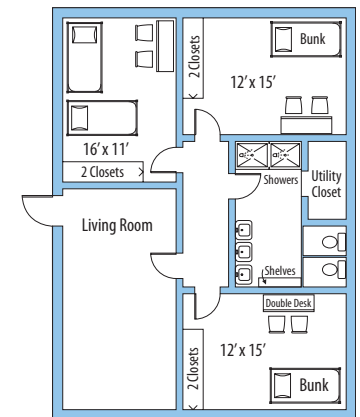

Meadowlark Halls:
There will be some variation between units "Community Style" (6-7 people per unit)

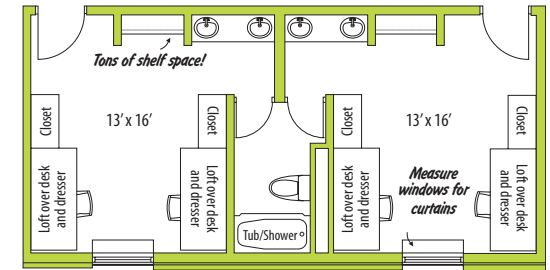

Cottonwood Hall: Handicap accessible rooms available "Traditional Style" (2 people per room)

All four unique layout designs offer the benefit of relaxed living while maintaining your privacy.

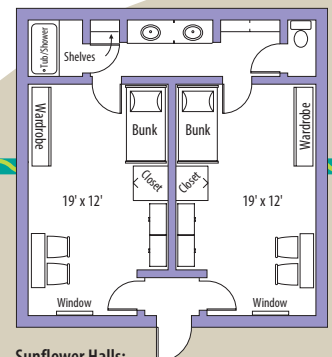

Sunflower Halls:
Two rooms, double occupancy "Apartment Style" (2 people per room)

MARCH

FEBRUARY
S M T W T F S
1 2 3 4 5
6 7 8 9 10 11 12
13 14 15 16 17 18 19
20 21 22 23 24 25 26
27 28

APRIL
S M T W T F S
1 2
3 4 5 6 7 8 9
10 11 12 13 14 15 16
17 18 19 20 21 22 23
24 25 26 27 28 29 30

20
11

SUNDAY	MONDAY	TUESDAY	WEDNESDAY	THURSDAY	FRIDAY	SATURDAY
<i>Hilltopics</i>	<i>Catch up on all the latest campus news and happenings at hilltopics.bartonccc.edu</i>	1 Softball vs Kansas Wesleyan JV 2 and 4 p.m. at Salina	2 Baseball vs Bethany JV 4 p.m. at Barton	3 Softball vs Hutchinson 2 p.m. & 4 p.m. at Hutchinson	4 Financial Aid Payout	5 Baseball vs Hutchinson 1 p.m. at Barton Softball at Cloud Tournament TBA
6 Baseball vs Hutchinson 1 p.m. at Barton Softball at Cloud Tournament TBA	7 Free Bingo, 6 p.m., Union	8 Mardi Gras Celebration 11-1:15 p.m., Union	9 Ash Wednesday Softball vs Sterling JV 2 p.m. & 4 p.m. at Barton	10 Softball vs Brown Mackie 2 p.m. & 4 p.m. at Barton Free Bowling 7:30-10:30 p.m., Eagle Lanes – Ellinwood	11 Financial Aid Payout	12 Softball at Broken Arrow, OK Tournament TBA
13 Daylight Saving Time Begins Softball at Broken Arrow, OK Tournament TBA	14 Baseball vs Iowa Western 1 p.m. at Barton	15 Baseball vs Otero 1 p.m. at Barton	16 \$3 Movie Night, Village Cinema Baseball vs Otero 1 p.m. at Barton Softball vs South Western College 3 p.m. & 5 p.m. at Winfield	17 St. Patrick's Day	18 Financial Aid Payout	19 Baseball vs Pratt 1 p.m. at Pratt
20 Spring Begins Baseball vs Pratt 1 p.m. at Pratt Softball vs Colby 12 & 2 p.m. at Colby Women's Golf at Winfield	21 Spring Break (No Classes/Offices Open) Women's Golf at Winfield	22 Spring Break (No Classes/Offices Open)	23 Spring Break (No Classes/Offices Open) Baseball vs Brown Mackie 4 p.m. at Salina Softball vs Garden City at Garden City	24 Spring Break (No Classes/Offices Closed)	25 Spring Break (No Classes/Offices Closed)	26 Baseball vs Seward 1 p.m. at Barton
27 Baseball vs Seward 1 p.m. at Barton Softball vs Seward 2 & 4 p.m. at Seward	28 Men's Golf at Junction City	29	30 \$3 Movie Night, Village Cinema Softball vs Butler 3 p.m. & 5 p.m. at Barton Baseball vs Brown Mackie 4 p.m. at Barton	31		

Make your DREAMS happen!

Barton is driven to help make college affordable for everyone. With *low tuition rates* and various ways to help students, Barton wants to help ensure your focus is on your future.

With *over \$8.8 million paid last year*, opportunities exist to help ease your financial burden. Barton offers awards based on your academic achievement, involvement in student activities and organizations, as well as, offering student employment opportunities.

Students interested in applying for academic scholarships, activity scholarships, departmental scholarships, and federal financial aid are encouraged to apply early. Barton's academic scholarship deadline is March 15 so don't delay...apply today!

For more information about financial opportunities at Barton, see our Financial Aid brochure or contact the Financial Aid Office at (620) 792-9270.

CAMPUS EMPLOYMENT

Campus employment provides employment opportunities that enable you to *earn money* to fund your education. Campus-based, Federal Work Study awards are based on documented need and availability of funds. To the extent possible, Barton will attempt to provide employment that complements and reinforces your educational and vocational career goals. For additional information, contact the Career Center at (620) 792-9349.

ACADEMIC SCHOLARSHIPS

You must be a Kansas High School graduate (or a Kansas Resident with a GED) to be eligible for the Academic Scholarship. The award is based upon the higher of your high school GPA or ACT score. To *be awarded* a scholarship, you must complete and submit a Barton Admissions & Scholarship Application by March 15 for the 2012-13 aid year.

The scholarship will be available for six full-time semesters and will renew annually with your most current Barton GPA.

Jayhawk Conference rules state that if you are receiving an athletic books and tuition scholarship, you must meet a 3.5 GPA criteria upon high school graduation to accept a Barton Academic Scholarship in addition to the Barton Athletic Scholarship.



2011-2012 Cost Information



PLANNING TIP

No one should rule out going to college because of cost!

- Fill out the free application for Federal Student Aid at www.fafsa.gov (Barton's Code: 004608)
- Payment options also available

Legal Residence in Kansas

Tuition	\$57/credit hour
Fees	\$30/credit hour

Legal Residence Outside of Kansas

Tuition	\$88/credit hour
Fees	\$30/credit hour

Annual Cost Estimates (Kansas resident)

Tuition & Fees	\$2,784 *based on 16 credit hours per semester
Books & Supplies	\$ 830 (estimated)
Residence Halls	\$4,784 (19 meals per week)
Total	\$8,398

The Barton Board of Trustees has the right to change tuition and fees without notice.
*A scholarship of \$3 per credit hour applies to Barton County residents.

The scholarship deadline is **March 15, 2012** for the 2012-13 aid year.

FINANCIAL Opportunities

Barton's Academic Scholarships will be available for six full-time semesters. It will annually renew with your most current Barton GPA.

Payment options available.

Academic Scholarships

*Additional Activity and Performance scholarships are available!
Automatic award if admissions application is received by March 15, 2012.

Award	Award Amount	Kansas HS GPA	GED Score	ACT Score
Excellence Award	\$1,000	3.5 and above	3500+	26+
Honor Award	\$800	3.0 - 3.49	3250 - 3490	24 - 25
Achievement Award	\$500	2.5 - 2.99	3000 - 3240	22 - 23
Merit Award	\$250	2.0 - 2.49	2750 - 2990	20 - 21



ACTIVITY AND DEPARTMENTAL AWARDS

Activity and Departmental Awards are offered by instructors or staff from various Barton programs. Selection is made for *special skills and/or performing abilities* with the student expected to complete specified obligations. The sponsor administering the award determines contract obligations and award amounts. Areas offering Activity and Departmental awards include: Band, Vocal, Agriculture, Drama, Journalism, Forensics, Honors, Student Senate, Admissions, Athletic, Student Trainers, Dance Line, and Cheerleading.

SCHOLARSHIPS

Ken Henderson gives great instructions and teaches you in a very hands on manner. Being an Athletic Trainer has been a great experience, not only have I met some great friends in the training room, the books and tuition scholarship helped out a great deal when it came to paying my bill.
-Wayne Ratley

Over \$1 million dollars awarded in scholarships.



In addition to Barton, check with your local high school counselor, chamber of commerce, churches, and civic organizations for additional scholarship opportunities.

Everyone should take the time to fill out the FREE Application for Federal Student Aid. You may find out you qualify for federal grants, loans, and/or student employment.

Simply go to:
www.fafsa.gov
Barton's FAFSA code is:
004608

BARTON
COMMUNITY COLLEGE

We provide the support to assist you
Set goals and evaluate regularly © Know where to find help

but SUCCESS begins with you!
Know what it takes to be successful © Know yourself

SUPPORTING you when you need it

Barton offers a wide variety of Student Services dedicated to assisting you in achieving greatness. Our services are designed to directly enhance student learning and support students' social and personal growth.

We are continually inspired by the energy, the diversity, and the possibility our students bring to Barton. *We can't wait to discover what you will create at Barton!*



Academic Advising

A student-centered, advisor-driven system designed to increase student success and retention by promoting close and continuous contact between students, advisors, and the Barton student support structure.

Campus Security

Text messaging, surveillance cameras, and 24 hour security officers help support a safe campus life experience.

TRiO Programs

Provides free services for eligible students to assist in meeting educational and personal goals.

- Student Support Services
- Educational Opportunity Center
- Upward Bound Programs

Tutoring

FREE peer and professional tutoring during regular Learning Resource Center hours.

Counseling Services

Professional and personal counseling is available to assist students with personal or academic challenges.

Health Services

Free basic services are provided by a full-time registered nurse Monday through Friday with after-hours emergency service available.

FINDING WHAT DRIVES YOU

Barton's Career Center provides resources to help you find part-time jobs, internships, and prepare you for life beyond college. More importantly, we want to help you DISCOVER YOUR POTENTIAL.



We've got your back!

BARTON
COMMUNITY COLLEGE

APRIL

MARCH
S M T W T F S
1 2 3 4 5
6 7 8 9 10 11 12
13 14 15 16 17 18 19
20 21 22 23 24 25 26
27 28 29 30 31

MAY
S M T W T F S
1 2 3 4 5 6 7
8 9 10 11 12 13 14
15 16 17 18 19 20 21
22 23 24 25 26 27 28
29 30 31

20
11

SUNDAY	MONDAY	TUESDAY	WEDNESDAY	THURSDAY	FRIDAY	SATURDAY
<i>Hilltopics</i>	<i>Catch up on all the latest campus news and happenings at hilltopics.bartonccc.edu</i>				April Fool's Day Financial Aid Payout	Baseball vs Colby 1 p.m. at Colby
3 Baseball vs Colby 1 p.m. at Colby Women's Golf at Great Bend	4 Women's Golf at Great Bend	5 Advisement Day (No day classes) Softball vs McCook 2 p.m. & 4 p.m. at McCook, NE	6 Last Day to Drop with Courses Recorded as "W" on Transcript	7 Student Senate Election Free Bowling, 7:30-10:30 p.m., Eagle Lanes – Ellinwood	8 Financial Aid Payout	9 Baseball vs Cloud 1 p.m. at Barton
10 Baseball vs Cloud 1 p.m. at Barton	11 \$3 Movie Night, Village Cinema Softball vs Pratt 3 p.m. & 5 p.m. at Barton Men's Golf at Hesston	12	13 4th Annual Hawaiian Luau Softball vs Garden City 3 p.m. & 5 p.m. at Barton	14 Softball vs McCook 2 p.m. & 4 p.m. at McCook, NE	15 Financial Aid Payout	16 Baseball vs Butler 1 p.m. at Butler Softball at Colby Tournament TBA
17 Palm Sunday Baseball vs Butler 1 p.m. at Butler Softball at Colby Tournament TBA Women's Golf at Goodland	18 Fall 2011 Priority Registration Begins Women's Golf at Goodland Men's Golf Conference Finals at Newton Free Bingo, 6 p.m., Union	19 Men's Golf Conference Finals at Newton	20 Softball vs Colby 3 p.m. & 5 p.m. at Barton Baseball vs Cowley 7 p.m. at Barton	21 Administrative Professionals' Day	22 Earth Day Good Friday (No Classes/Offices Closed) Softball vs Seward 2 and 4 p.m. at Barton	23 Baseball vs SE Nebraska 2 p.m. at Barton
24 Easter Sunday Baseball vs SE Nebraska 2 p.m. at Barton	25 Easter Monday (No Classes/Offices Closed)	26	27 \$3 Movie Night, Village Cinema Softball vs Butler 3 p.m. & 5 p.m. at Butler Baseball vs Cowley 7 p.m. at Cowley	28	29	30 Baseball vs Dodge City 1 p.m. at Barton

College is what **YOU** make of it

Student Activities & Organizations

- Campus Christian Fellowship
- Cheer Squad
- Collegiate Farm Bureau
- Collegiate Music Educators National Conference
- Community Student Organization
- Computer Club
- Concert Band
- Concert Choir
- Cougar Dance Team
- Da Capo
- Debate
- Dolce
- Forensics

- Hispanic American Leadership Organization (HALO)
- Honors Program
- Journalism Crew
- Lambda Alpha Epsilon
- Multicultural Society
- National Honor Societies
- Nursing Club
- Orchestra
- Pep Band
- St. Justa Pottery Guild
- Stage Band
- Student Ambassadors
- Student Senate
- Technical Arts Club
- The Hilltop Singers
- The Interrobang



MAY

APRIL

S	M	T	W	T	F	S
					1	2
3	4	5	6	7	8	9
10	11	12	13	14	15	16
17	18	19	20	21	22	23
24	25	26	27	28	29	30

JUNE

S	M	T	W	T	F	S
				1	2	3
4	5	6	7	8	9	10
11	12	13	14	15	16	17
18	19	20	21	22	23	24
25	26	27	28	29	30	

2011

SUNDAY	MONDAY	TUESDAY	WEDNESDAY	THURSDAY	FRIDAY	SATURDAY
1 Women's Golf Regional at Hutchinson Baseball vs Dodge City 1 p.m. at Barton	2 Women's Golf Regional at Hutchinson Men's Golf Regional at Gothenburg Free Massages 6-9 p.m., Union	3 Women's Golf Regional at Hutchinson	4 Men's Golf Regional at Gothenburg	5 Cinco De Mayo Celebration 11 a.m.-1 p.m., Union	6 Financial Aid Payout	7 Softball at Regional Tournament TBA at Wichita
8 Mother's Day Softball at Regional Tournament TBA at Wichita	9 Final Examination Day	10 Final Examination Day	11 Final Examination Day	12 Close of Spring 2011 Semester Commencement	13 Summer 2011 Priority Registration Ends	14
15	16 Summer 2011 Regular Registration Begins Summer hours begin Offices open 7 a.m. - 5:30 p.m. Monday - Thursday	17	18	19	20 Campus Closed, Summer Hours Summer 2011 Regular Registration Ends	21 Armed Forces Day
22	23 Summer 2011 Classes Begin	24	25 Last Day for Late Registration for 1st 4-Week & 8-Week session	26 Last Day for Refund for 1st 4-Week & 8-Week Session	27 Campus Closed, Summer Hours	28
29	30 Memorial Day (No Classes/Offices Closed)	31				<i>Catch up on all the latest campus news and happenings at hilltopics.bartonccc.edu</i>

YEAR-ROUND Fitness

Kirkman Student Activity Center

The Kirkman Activity Center is a 45,250 square foot multilevel building giving our students the combination of a free access, year-round fitness facility and student services.



The lower level

includes newly renovated Student Weight Room, Cheer and Dance practice areas, basketball and volleyball courts, batting cages, indoor track, training room, indoor shooting/rifle range, classrooms, and the Athletic Department offices.

The upper level

is home to the Thelma Faye Harms state-of-the-art Wellness Center, indoor pool, and Student Services Offices which includes Admissions, Financial Aid, Housing, Enrollment Services, Business Office, and Human Resources.



JUNE

MAY
 S M T W T F S
 1 2 3 4 5 6 7
 8 9 10 11 12 13 14
 15 16 17 18 19 20 21
 22 23 24 25 26 27 28
 29 30 31

JULY
 S M T W T F S
 1 2
 3 4 5 6 7 8 9
 10 11 12 13 14 15 16
 17 18 19 20 21 22 23
 24 25 26 27 28 29 30
 31

20
11

SUNDAY	MONDAY	TUESDAY	WEDNESDAY	THURSDAY	FRIDAY	SATURDAY
			1	2	3	4
HillTopics	Catch up on all the latest campus news and happenings at hilltopics.bartonccc.edu		Priority Deadline to Apply for Summer 2011 Graduation		Campus Closed, Summer Hours	
5	6	7	8	9	10	11
					Campus Closed, Summer Hours	
12	13	14	15	16	17	18
	No Drop/Withdrawals for 1st 4-Week Session	Flag Day		Financial Aid Payout	Campus Closed, Summer Hours	
19	20	21	22	23	24	25
Father's Day		Summer Begins Last Day of Classes for 1st 4-Week Session	First Day of Classes for 2nd 4-Week Session	Last Day for Late Registration for 2nd 4-Week Sessions	Campus Closed, Summer Hours	
26	27	28	29	30		
			Last Day for Refund for 2nd 4-Week Session	Financial Aid Payout		

LEARNING wherever you are

HIGH SCHOOL "JUMP START" COURSES

Barton provides high school sophomores, juniors, seniors, and gifted underclassmen college classes while in high school.

Dual Credit/Concurrent Classes (College Advantage Program) - Barton offers college classes in your high school (within Barton's seven county service area).

Get Ahead Program (GAP) - Barton on-campus afternoon college courses are designed to give high school students a sneak peek of what to expect in a college class environment and coursework.

OUTREACH PROGRAMS

College courses are available in our seven-county service area and the Grandview Plaza/Junction City area. Degree completion programs are available at participating sites.

Guy Causey is an awesome teacher. I took online chemistry class from him and he was so helpful to me. When I went to campus he helped me with some assignments I was having trouble with. He is the best online or off line instructor I have ever had and he should be recognized.

- Dauna Herman

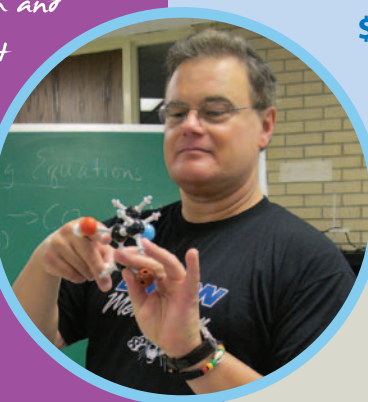

ONLINE LEARNING

We think you will find the overall cost very reasonable when compared to traveling and living on-campus at some colleges. Remember, you can be employed and study at the same time, because online courses can be taken around your busy schedule.

Each online learning entity charges one flat rate per semester credit hour, plus the cost of textbooks and additional materials. This fee is the same for all online students regardless of Kansas residency.

BARTONline.org

BARTONline: 877-620-6606
\$130 per semester credit hour

BARTONline.org provides you the opportunity to earn or complete an Associate Degree online. Courses taken at other colleges and universities, plus any military and work experience, may be applied towards degree completion requirements at Barton.

eduKan

EduKan: 877-433-8526
\$125 per semester credit hour

EduKan.org is an online consortium consisting of Barton and five other community colleges. EduKan provides you another opportunity within the Barton family to obtain your Associate Degree online.

 **k-state** AT BARTON

K-STATE AT BARTON

The Kansas State University Wildcats and the Barton Community College Cougars have joined together to form a K-State at Barton partnership. The Cats and Cougars are working together to provide high quality, full service educational opportunities to people in Central Kansas.

The K-State at Barton Partnership brings education closer by:

- Offering distance education courses, bachelor's degree and master's degree programs to Central Kansas
- Developing 2+2 partnerships between Barton and K-State
- Assisting current Barton students with admission to Kansas State University
- Providing area residents with opportunities for certification and degree completion as well as professional development

For more information, contact Jennifer Pfortmiller at (620) 786-1188 or bartondce@ksu.edu, or visit the K-State at Barton website at www.dce.k-state.edu/affiliations/2+2/barton

BARTON

COMMUNITY COLLEGE

JULY

JUNE
S M T W T F S
1 2 3 4
5 6 7 8 9 10 11
12 13 14 15 16 17 18
19 20 21 22 23 24 25
26 27 28 29 30

AUGUST
S M T W T F S
1 2 3 4 5 6
7 8 9 10 11 12 13
14 15 16 17 18 19 20
21 22 23 24 25 26 27
28 29 30 31

2011

SUNDAY	MONDAY	TUESDAY	WEDNESDAY	THURSDAY	FRIDAY	SATURDAY
<i>Hilltopics</i>	Catch up on all the latest campus news and happenings at hilltopics.bartonccc.edu				Campus Closed, Summer Hours	
3	4 Independence Day (No Classes/Offices Closed)	5 No Drops/Withdrawals for 8-Week Session	6	7	8 Campus Closed, Summer Hours	9
10	11 No Drops/Withdrawals for 2nd 4-Week Session	12	13	14 Financial Aid Payout	15 Campus Closed, Summer Hours	16
17	18	19 Last Day of Classes for 8-Week Session	20 Last Day of Classes for 2nd 4-Week Session	21	22 Campus Closed, Summer Hours Fall 2011 Priority Registration Ends	23
24/31 Parent's Day	25 Fall 2011 Regular Registration Begins	26	27	28 Financial Aid Payout	29 Campus Closed, Summer Hours	30

LOCAL Opportunities

City of Great Bend

Listed as a "Best Places" city by U.S. News & World Report, come spend a day with great people in a great place ... Great Bend!!

With over 15,000 residents, visit Great Bend and find a wide variety of things to do while enjoying a small town with all the amenities of a small city.

COMMUNITY EVENTS

- 3i Agriculture Show
- Cinco de Mayo Celebration
- Championship Drag Racing
- The Barton County Fair with Fireworks Extravaganza
- Juneteenth - Celebration of African American freedom and heritage
- Polka Days
- Community Theatre in the historic Crest Theatre
- Barton County Historical Museum and Village
- Big Bend Bike Rally

BRIT SPAUGH PARK

- Britt Spaugh Zoo
- Skateboard park
- BMX bike park
- Baseball and softball diamonds
- Tennis courts
- Horseshoe pits
- Wetlands Aquatic Park

VETERAN'S MEMORIAL PARK

- Fishing lake
- Limited boating: canoe, kayak
- Ball field complex
- Baseball and softball fields
- Tennis courts
- Physical fitness trail
- Walking trail with floating bridge
- Floating fishing dock
- Argonne Forest
- Assorted play equipment
- Sand beach
- Sand beach volleyball



The L. E. "Gus" and Eva Shafer Memorial Art Gallery has been referred to as the "Gem of the Campus" at Barton. With 7,700 square feet of exhibit space, the gallery has over 7,000 annual visitors. Including the works of Shafer, the exhibit displays art from various artists, students, and exhibits from around the country.



OTHER

Wetlands

Aquatic Park

Zoom down the slides, soak in the sun, or kick back and relax in the shade at the Wetlands Aquatic Park. The Wetlands featuring 8 slides, 39 spray features, a 10,000sq. foot swimming pool, Water Wars, and **ONE BIG BUCKET** dropping over **300** gallons of water over the top of anyone daring to stand below.

Trail of Lights

The award-winning Trail of Lights holiday displays are like coming home to a perfect little Midwestern Christmas village.

Cheyenne Bottoms Wildlife Refuge

Designated a "Wetland of International Importance," the refuge is a 41,000-acre basin-like lowland and is considered the largest marsh in the interior of the United States.



©

AUGUST



JULY

S	M	T	W	T	F	S
					1	2
3	4	5	6	7	8	9
10	11	12	13	14	15	16
17	18	19	20	21	22	23
24	25	26	27	28	29	30
31						

SEPTEMBER

S	M	T	W	T	F	S
					1	2
3	4	5	6	7	8	9
10	11	12	13	14	15	16
17	18	19	20	21	22	23
24	25	26	27	28	29	30

20
11

SUNDAY	MONDAY	TUESDAY	WEDNESDAY	THURSDAY	FRIDAY	SATURDAY
	1	2	3	4	5 Campus Closed, Summer Hours	6
						
7	8	9	10 Professional Conference Day	11 Professional Conference Day	12 Fall 2011 Regular Registration Ends Professional Conference Day	13
14	15 Fall 2011 Classes Start Fall 2011 Late Registration Begins	16	17	18	19 Fall 2011 Late Registration Ends	20
21	22	23	24/31	25	26 Last Day for Refunds	27
28	29	30	31			
					Catch up on all the latest campus news and happenings at hilltopics.bartonccc.edu	

About our campuses

Great Bend Campus

<http://bartonccc.edu>

The Great Bend campus serves as the main campus for Barton. We are located high atop a hill on 160 acres three miles northeast of Great Bend across the road from Bissells Point. The campus includes eight buildings in the main section of campus with four phases of student housing, the Cougar fields, and the Midwest Utility Pipeline Training Center located on the outskirts.

Learning facilities include numerous science labs as well as specially equipped labs for specific programs. Barton's attention to technology can be found in its ITV rooms, 35 SMART (hightech) classrooms, numerous computer labs, and technical program labs. A 40-foot dome theater with 66 seats, the Planetarium is equipped to recreate the night sky in amazing detail and offers programs free of charge as a public service.

The Mission of Barton Community College is to provide quality educational opportunities that are accessible, affordable, continuously improving and student focused. Barton is driven to provide an educational system that is learning-centered, innovative, meets workforce needs, and strengthens communities.



Fort Riley Campus

<http://fortriley.bartonccc.edu>

Fort Riley, home of "The Big Red One," is known for its excellent training, abundant recreational opportunities, rich history, and tremendous relations with surrounding communities. Barton Community College's proud association with Fort Riley and the U.S. Army began in 1984 with a single training contract and has continued to grow in support of the Army, its soldiers, their families, and the Junction City community.

The Barton Community College Fort Riley campus provides education and training, as well as selected specialized education and training to the entire state. In addition, Bartonline, Barton's premier site for online courses, is administered from the Fort Riley campus.

The Fort Riley campus administration building is located in Building 217 on the main post of Fort Riley.

This main office and two of the computer labs are across from the Fort Riley Museum and the Custer House. The campus also provides instructional services for Troop School, BSEP and LSEC which are located on Custer Hill.

Courses also are offered at a nearby outreach site located at Grandview Plaza. The Grandview

Plaza outreach site is home to the Hazardous Materials Handling and Emergency Management programs, Emergency Medical Technician, and Paramedic programs.

The "Trooper Bill" statue stands as a tribute to the U. S. Cavalry symbolizing a man, a soldier, and of a service living on after him. Situated on the Cavalry Parade Field just north of the Barton-Fort Riley campus, this statue's base is also the resting place of "Chief" - the last horse carried on Army rolls as a cavalry mount. "Chief" died in 1968 and was buried with full military honors.



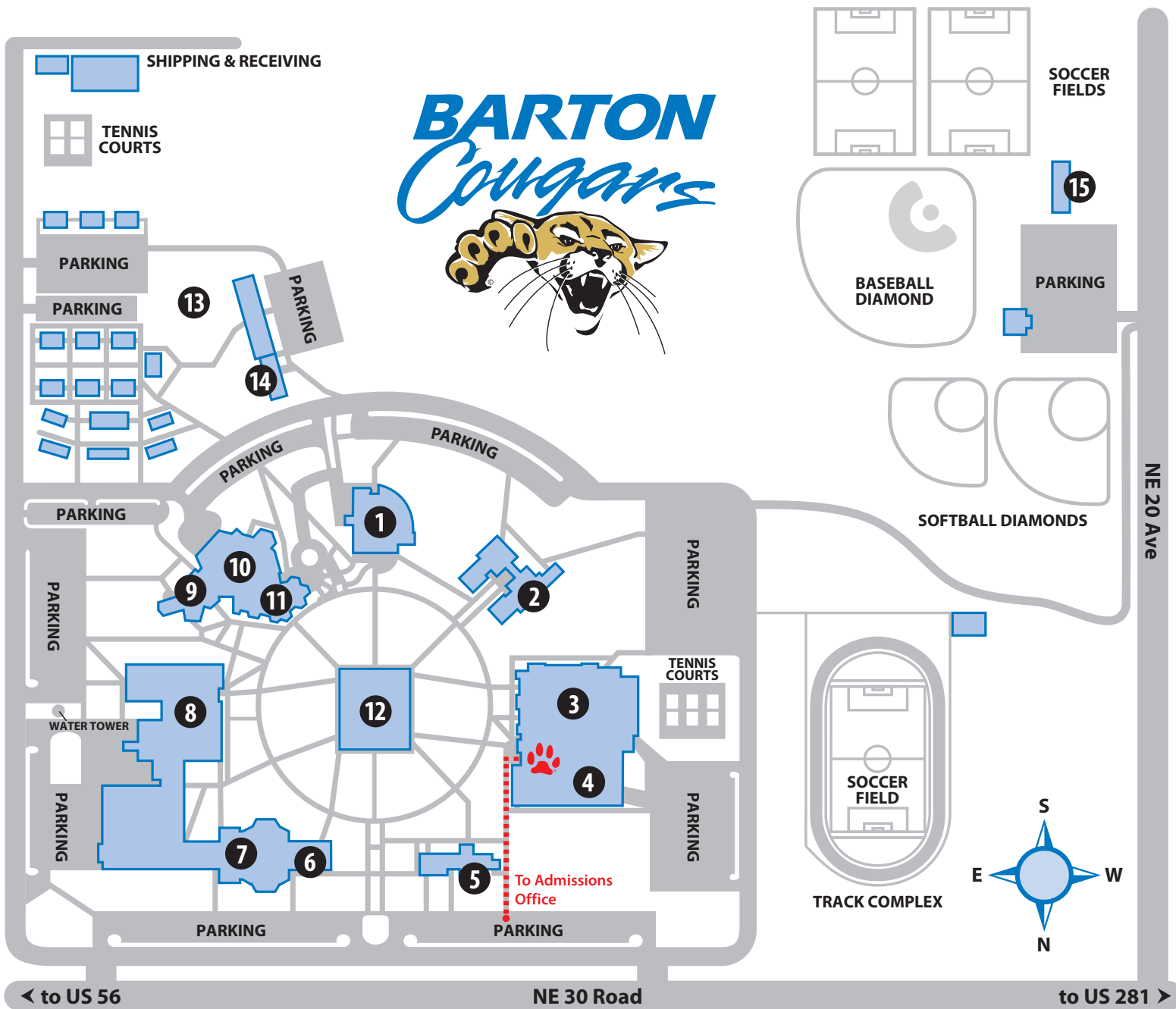

- 1 U-Building Union
- 2 C-Building Classroom
- 3 P-Building Physical Education
- 4 Kirkman Student Activity Center
- 5 A-Building Administration
- 6 Planetarium
- 7 S-Building Science & Math
- 8 T-Building Technical Education
- 9 F-30 Seminar Room
- 10 F-Building Fine Arts
- 11 Shafer Gallery
- 12 L-Building Learning Resources Center
- 13 Student Housing
- 14 Child Development Center
- 15 Midwest Utility Pipeline Training Center

BARTON
COMMUNITY COLLEGE

245 NE 30 RD • Great Bend, KS 67530
www.bartonccc.edu • 800-722-6842

RENOVATIONS

Three buildings on the Barton County campus have undergone a major transformation during the past year. These changes and upgrades are major improvements and enhancements to support student learning.

Health Care Programs

Includes classroom and lab expansion, more use of high technology, more use of real life simulation labs



Agriculture

New and expanded classrooms for Agriculture related programs



Case New Holland

Expanded facility for training Case New Holland employees from across the United States



Automotive

Expanded more than double its previous size to increase automotive program and specializations



Track & Soccer Complex

The new Cougar sports complex is home to our nationally ranked athletic programs, as well as, provides a 1st class training facility for all our students



Learning Resource Center



Students and staff enjoy refreshments in The Coffee Cove



Kick back and relax while reading or working on your laptop



Bring your own laptop or use one of the many computers throughout the LRC facility



Meeting room equipped with large TV, fireplace, and food/beverage kitchenette



Need research? Everything a student needs is located in the library with access to over 30,000 print resources to over 60,000 electronic books, magazines, newspapers, and journals



Expanded facility for student support services such as advisement, career exploration, computer lab, and tutoring services



The Cohen Center for Kansas History room is a dedicated resource room for Kansas history and culture



See You Soon!

Cougar Checklist



Campus Tour - A great way to see if Barton is the place for you!



Admissions/Scholarship Application - Remember Barton's academic scholarship deadline is March 15. Application available online.



Submit ACT Scores or ASSET test scores - Haven't taken either of these assessment tests? No problem just give us a call and we'll get you taken care of.



Submit completed transcript(s) - Completed transcripts must be mailed directly to Barton Admissions Office to be official. Unofficial transcripts can be used for advising and obtaining academic information (GPA, ACT Scores, etc)



Housing Application - Submit application and deposit early to get your first choice! Application available online.



Financial Aid - Never rule out the cost of going to college. Visit www.fafsa.ed.gov for federal assistance or call us with even more options!

For more information, call the Admissions Office
at 1-800-722-6842 or (620) 792-9286

Non-Discrimination Notice: To provide equal employment, advancement and learning opportunities to all individuals, employment and student admission decisions at Barton will be based on merit, qualifications, and abilities. Barton County Community College does not discriminate on the basis of any characteristic protected by law in all aspects of employment and admission in its education programs or activities. Any person having inquiries concerning Barton County Community College's non-discrimination compliance policy, including the application of Equal Opportunity Employment, Titles IV, VI, VII, IX, Section 504 and the implementing regulations, is directed to contact the College's Compliance Officer, Barton County Community College, Room A-123, Great Bend, Kansas 67530 (620) 792-9234. Any person may also contact the Director, Office of Civil Rights, U.S. Department of Education, Washington, DC 20201.



Follow us!

YouTube™

twitter

facebook

flickr™

myspace®
a place for friends

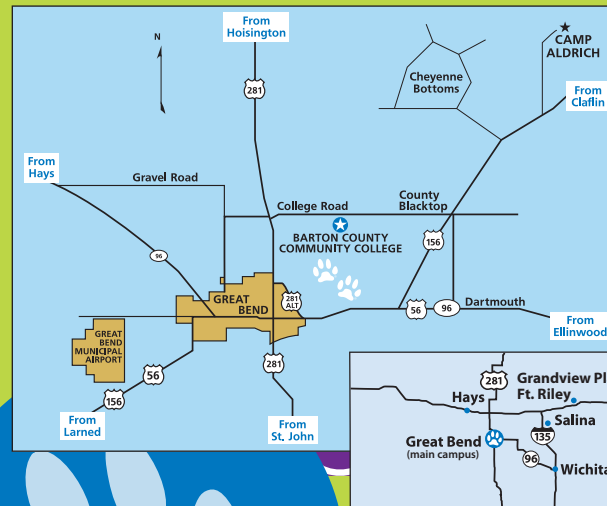

Directory Information

WEB ADDRESS

www.bartonccc.edu

BARTON COUNTY CAMPUS (main campus)

Local
(620) 792-2701

Toll-Free
1-800-748-7594

Address
245 NE 30 RD
Great Bend, KS 67530

FORT RILEY CAMPUS

Local
(785) 784-6606

Toll-Free
1-877-620-6606

Address
P.O. Box 2463, Building 217
Fort Riley, KS 66442
<http://fr.bartonccc.edu>

GRANDVIEW PLAZA OUTREACH SITE

Local
(785) 238-8550

Toll-Free
1-877-771-0255

Address
100 Continental Avenue
Grandview Plaza, KS 66441

ONLINE LEARNING OPPORTUNITIES

www.bartononline.org
1-877-620-6606

www.edukan.org
1-877-433-8526