

WHAT DRIVES YOU?

2012-13 Calendar Viewbook

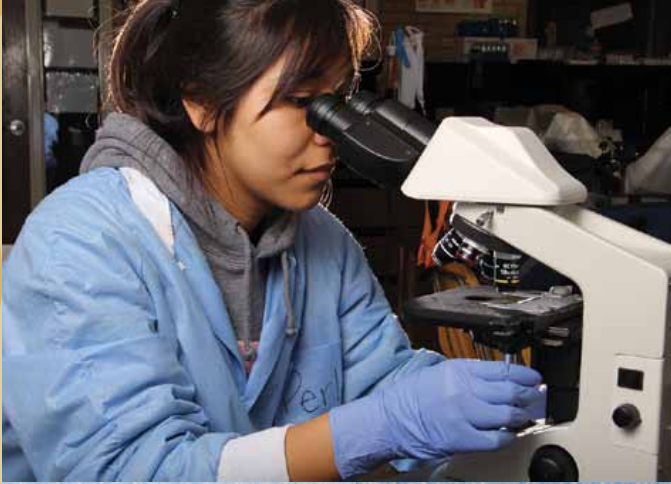

GoBarton.com



Imagine the fun!

Student life at Barton includes the planning of many on and off campus activities. Activities are planned to create a safe and friendly environment for our tight-knit student body to interact, including involvement with our surrounding communities. At Barton, there is a place for EVERYONE to fit in.



Barton has over 50 fun student activities planned throughout the year!



Memories for the making!

- | | |
|------------------------|------------------------|
| Hawaiian Luau | Casino Night |
| \$3 Movie Nights | Homecoming |
| Free Shoulder Massages | Late Night Breakfasts |
| Bowling Nights | Mardi Gras Celebration |
| Mix and Mingle Bingo | |



For those who feel like having a relaxing evening at home, Barton's exclusive CATV (channel 52), offers a variety of both "classics" and recently released movies to be viewed on a daily basis. You can enjoy 12 new movie releases per month without even leaving the comforts of your couch.

2012 SEPTEMBER

August 2012						
S	M	T	W	T	F	S
			1	2	3	4
5	6	7	8	9	10	11
12	13	14	15	16	17	18
19	20	21	22	23	24	25
26	27	28	29	30	31	

October 2012						
S	M	T	W	T	F	S
	1	2	3	4	5	6
7	8	9	10	11	12	13
14	15	16	17	18	19	20
21	22	23	24	25	26	27
28	29	30	31			

SUNDAY

MONDAY

TUESDAY

WEDNESDAY

THURSDAY

FRIDAY

SATURDAY



CollegeNEWS
news.bartonccc.edu

Catch up on all the latest campus news and happenings!



Priority Deadline to Apply for Fall 2012 Graduation
Student Trip to Winter Park, Colorado (1st-3rd) – Contact Joe Thornton
Cross Country at Wichita State University 9 a.m.

Women's Soccer vs Western Nebraska
11 a.m. at Barton
Men's Soccer vs Western Nebraska
1 p.m. at Barton

2

Labor Day
(No Classes/Offices Closed)

3

Women's Soccer vs Dodge City
2 p.m. at Barton
Men's Soccer vs Dodge City
4 p.m. at Barton
Volleyball vs Garden City
6:30 p.m. at Garden City

5

Women's Soccer vs MCC-Maple Woods
2 p.m. at Barton
Free Bowling 7:30-10 p.m.
Eagle Lanes, Ellinwood

6

Senate Election for Freshman Positions 8 a.m.-1 p.m., Union
Volleyball vs College of Southern Idaho 11 a.m. at Twin Falls, ID
Volleyball vs TBA, Twin Falls, ID

7

Men's Soccer vs Iowa Lakes 12 p.m. at Council Bluffs, IA
Student Trip to State Fair: 1 p.m. Departure, Sign up at Student Life
Volleyball vs TBA, Twin Falls, ID

8

Men's Soccer vs Iowa Western
1 p.m. at Council Bluffs, IA

9

Men's Golf at Hesston

10

Women's Soccer vs Coffeyville
5 p.m. at Coffeyville
Volleyball vs Pratt
6:30 p.m. at Barton
Men's Soccer vs Coffeyville
7 p.m. at Coffeyville

12

\$3 Movie Night, Village Cinema

13

Women's Soccer vs Allen
2 p.m. at Allen
Men's Soccer vs Allen
4 p.m. at Allen

14

15

Women's Golf vs TBA

16

Constitution Day
11 a.m. - 1:30 p.m.
Voter's Registration, Union
Volleyball vs Dodge City
6:30 p.m. at Barton
Women's Golf vs TBA

17

Women's Soccer vs Hutchinson
2 p.m. at Barton

18

Bingo 6 p.m., Union
Volleyball vs Cloud
6:30 p.m. at Cloud

19

Free Shoulder Massages
6-9 p.m., Union

20

Volleyball at Hutchinson Tournament

21

Fall Begins
Student Trip to Topeka shopping: Contact Joe Thornton
Cross Country at Tabor Invitational 10:45 a.m. at Newton
Women's Soccer vs Neosho
4 p.m. at Neosho
Men's Soccer vs Neosho 6 p.m. at Neosho
Volleyball at Hutchinson Tournament

22

Women's Soccer vs Independence
1 p.m. at Independence
Men's Soccer vs Independence
3 p.m. at Independence

23/30

Men's Golf at Auburn Hills
8 a.m. at Wichita
Volleyball vs Hutchinson
6:30 p.m. at Hutchinson
Meet & Greet
8 p.m., Commons/Housing

24

Financial Aid Payout

25

Women's Soccer vs Northern Oklahoma
2 p.m. at Northern Oklahoma
Men's Soccer vs Northern Oklahoma
4 p.m. at Northern Oklahoma
Volleyball vs Colby
6:30 p.m. at Barton

26

\$3 Movie Night, Village Cinema
Barton Theatre
Mainstage Production
7:30 p.m., Fine Arts Auditorium

27

Cross Country at Emporia State Open
5 p.m. at ESU
Barton Theatre
Mainstage Production
7:30 p.m., Fine Arts Auditorium

28

Women's Soccer vs Cowley
6 p.m. at Great Bend HS
Men's Soccer vs Cowley
8 p.m. at Great Bend HS
Barton Foundation's 34th Annual Big Benefit Auction

29

Discovering new possibilities!

Why do YOU need to come on a tour at Barton?

You need to come and enjoy the personalized tour of Barton to guarantee that we are the perfect match for you! We want you to come visit with our Faculty and Staff, tour the Campus and Housing, eat a FREE lunch in our fabulous dining facility, and have a GREAT time! We welcome family and friends to come on the tour as well.

What Major are you interested in?

You will meet with an Academic Advisor to discuss all of the opportunities and possibilities for your future program of study and classes you will be taking.

How much will college cost?

We would be more than happy to go over any Financial Aid questions while you are here. Also, if you are looking for scholarship possibilities, we would be happy to arrange a visit with any sport, activity, or organization you might be interested in to see if scholarships are available for you!

How do I become a Barton Cougar?

A member of the Admissions Staff will visit with you regarding any questions you may have to help get you started on the path to becoming a Cougar.

Free parking!
Free application for admission!
Free t-shirt! ☺ Free lunch!
☺ Free smiles! ☺



WE'D LOVE TO MEET YOU!

Tours are scheduled
Monday - Friday,
8:30 a.m. - 3 p.m.
Tour times fill quickly,
so don't delay! Give us at
least a week's notice, and
we'll get your visit scheduled
to fit YOUR needs!
Call (800) 722-6842
to schedule a tour today!



2012 OCTOBER

September 2012						
S	M	T	W	T	F	S
						1
2	3	4	5	6	7	8
9	10	11	12	13	14	15
16	17	18	19	20	21	22
23	24	25	26	27	28	29
30						

November 2012						
S	M	T	W	T	F	S
						1 2 3
4	5	6	7	8	9	10
11	12	13	14	15	16	17
18	19	20	21	22	23	24
25	26	27	28	29	30	

SUNDAY

MONDAY

TUESDAY

WEDNESDAY

THURSDAY

FRIDAY

SATURDAY



Women's Golf at Coffeyville

1

2

Women's Soccer vs Johnson
2 p.m. at Barton
Men's Soccer vs Johnson
4 p.m. at Barton
Volleyball vs Seward
6:30 p.m. at Seward

3

Free Bowling 7:30-10 p.m.
Eagle Lanes, Ellinwood

4

Last Day of 1st 8-Week Session
Student Trip to Rolling Hills Zoo & Salina: 1 p.m. Departure,
Sign up at Student Life
Student Trip to Albuquerque, New Mexico Internat'l Balloon Fiesta (5th-7th): Contact Joe Thornton

5

Men's BB at Dallas Juco Jamboree Scrimmage
Cross Country at Fort Hays State

6

Women's Soccer vs Butler
7:30 p.m. at Butler

7

Columbus Day
First Day of 2nd 8-Week Session
Men's Golf at Manhattan Country Club
8 a.m.
Volleyball vs Garden City
6:30 p.m. at Barton

8

Financial Aid Payout

9

\$3 Movie Night, Village Cinema
Women's Soccer vs Pratt
5 p.m. at Pratt
Volleyball vs Dodge City
6:30 p.m. at Dodge City
Men's Soccer vs Pratt
7 p.m. at Pratt

10

11

Women's BB Scrimmage at Frisco, TX
Volleyball at MSU-West Plains, MO

12

Cross Country at McPherson Invitational
10:15 a.m.
Women's Soccer vs Cloud 2 p.m. at Barton
Men's Soccer vs Cloud 4 p.m. at Barton
Men's BB at Coffeyville Jamboree Scrimmage
Volleyball at MSU-West Plains, MO

13

Women's Golf at Mariah Hills,
Dodge City

14

Women's Golf at Mariah Hills,
Dodge City
Women's Soccer vs Garden City
4 p.m. at Barton
Meet & Greet 8 p.m.,
Commons/Housing

15

Volleyball vs Pratt
6:30 p.m. at Pratt

16

Women's Soccer vs KCK CC
2 p.m. at Barton
Men's Soccer vs KCK CC
4 p.m. at Barton
Bingo
6 p.m., Union

17

Fall Break (No Classes/Offices Open)
Student Trip to Yellowstone Nat'l
Park/Jackson Hole, WY (18th-21st):
Contact Joe Thornton
Jack Kilby Science Day
Volleyball vs Cloud,
6:30 p.m. at Barton

18

Fall Break (No Classes/Offices Open)
Cross Country at Butler CC
Invitational

19

Women's BB scrimmage at Wichita

20

21

22

Financial Aid Payout
Volleyball vs Hutchinson
6:30 p.m. at Barton
Women's Soccer Region VI Playoffs-
Quarterfinals
Men's Soccer Region VI Playoffs-
Quarterfinals

23

24

Volleyball vs Colby
6:30 p.m. at Colby

25

26

Student Trip to Kansas City
Weekend (27th-28th): Contact Joe
Thornton
Women's Soccer Region VI Playoffs-
Semi-Finals
Men's Soccer Region VI Playoffs-
Semi-Finals

27

Women's Soccer Region VI Playoffs-
Finals
Men's Soccer Region VI Playoffs-
Finals

28

Volleyball – Region VI Tournament
Cross Country – Region VI
Championships

29

30

Halloween
Halloween Dance & Costume
Contest, 9 p.m.-Midnight, Union

31



CollegeNEWS
news.bartonccc.edu

Catch up on all the
latest campus news
and happenings!

Striving for excellence



Watch and listen to all basketball games live on the Internet! Check out the latest game schedules at bartonsports.com

In **42** years of athletic competition,
Barton has **55** national titles,
145 region or district championships,
158 conference championships,
over **50** professional athletes,
29 Olympians, and
10 Olympic Medal winners.



WOMEN'S SPORTS

Basketball
Cross Country
Golf
Soccer
Softball
Tennis
Track
Volleyball

MEN'S SPORTS

Baseball
Basketball
Cross Country
Golf
Soccer
Tennis
Track

2012 NOVEMBER

October 2012						
S	M	T	W	T	F	S
	1	2	3	4	5	6
7	8	9	10	11	12	13
14	15	16	17	18	19	20
21	22	23	24	25	26	27
28	29	30	31			

December 2012						
S	M	T	W	T	F	S
						1
2	3	4	5	6	7	8
9	10	11	12	13	14	15
16	17	18	19	20	21	22
23	24	25	26	27	28	29
30	31					

SUNDAY

MONDAY

TUESDAY

WEDNESDAY

THURSDAY

FRIDAY

SATURDAY



CollegeNEWS
news.bartoncc.edu
Catch up on all the latest campus news and happenings!



Last Day to Drop with Courses Recorded as "W" on Transcript
Barton Classic:
Women's BB vs Midland College 5 p.m. at Barton
Men's BB vs Fort Scott 7 p.m. at Barton

Barton Classic:
Women's BB vs Coffeyville 5 p.m. at Barton
Men's BB vs Northwest KS Technical College, 7 p.m. at Barton
Volleyball Region IV Tournament at Wichita

Volleyball Region IV Tournament at Wichita
4

\$3 Movie Night, Village Cinema
5

Election Day
Financial Aid Payout
Spring 2013 Registration Begins
Advisement Day (No Day Classes)
Women's BB vs Bethany College JV 5 p.m. at Barton

7

Men's BB vs Ottawa University JV 7 p.m. at Fort Riley
Bingo 6 p.m., Union
8

Brown Mackie Classic:
Women's BB vs Kansas Wesleyan JV 1 p.m. at Salina
9

Brown Mackie Classic:
Women's BB vs Bethel College JV 1 p.m. at Salina
Cross Country Nationals at Ina, IL
10

Veterans Day
11

Veterans Day Holiday
12

Women's BB vs KCK CC 5 p.m. at Kansas City
Men's BB vs KCK CC TBA at Kansas City
13

14

Free Bowling 7:30-10 p.m. Eagle Lanes, Ellinwood
Barton Theatre Student Production 7:30 p.m., Fine Arts Auditorium
15

Men's BB vs KSU-Salina 3 p.m. at Salina
Barton Theatre Student Production 7:30 p.m., Fine Arts Auditorium
16

Student Trip to Kansas Cosmosphere 1 p.m. Departure, Sign up at Student Life
Men's BB vs Northwest KS Tech. College 3 p.m. at Salina
17

18

19

Women's BB vs Cowley 5 p.m. at Barton
Men's BB vs McPherson JV 7 p.m. at Barton
20

Thanksgiving Break (No Classes/Offices Closed)
21

Thanksgiving (No Classes/Offices Closed)
22

Thanksgiving Break (No Classes/Offices Closed)
Barton Classic:
Women's BB vs Southwestern CC (IA) 5 p.m. at Barton
Men's BB vs Neosho 7 p.m. at Barton
23

Barton Classic:
Women's BB vs Neosho 5 p.m. at Barton
Men's BB vs Hill College (TX) 7 p.m. at Barton
24

25

\$3 Movie Night, Village Cinema
26

Women's BB vs McPherson College JV 5 p.m. at Barton
27

Free Shoulder Massages 6-9 p.m., Union
Barton Theatre Auditions 7:30 p.m., Fine Arts Auditorium
28

29

Student Trip Christmas in Georgetown, Colorado (30th-2nd): Contact Joe Thornton
Cowley Classic: Women's BB vs Bethel College JV, 5 p.m. at Arkansas City
Highland Classic: Men's BB vs North Central Missouri College TBA at Highland
30



Put your passion to work!



WHAT DRIVES YOU?

Find your passion and put it to work! Undecided students are encouraged to contact Barton's Career Center.

PROGRAMS OF STUDY

Transfer Programs

Transfer programs are designed to prepare you for transferring to a four-year college or university.

Career Programs

Career programs offer you an opportunity to pursue certificate and degree programs designed to prepare you for employment in the workplace and/or transfer to a university.

DEGREE CODES

AAS - Associate in Applied Science
C- Certificate
NDS - Non-degree seeking
SAP - Stand alone program
* - Emphasis of Study

AGRICULTURE

Agribusiness (AS)
Agricultural Economics (AS)
Agricultural Education (AS)
Agriculture Business Mgmt (AAS)*
Agriculture Communications (AS)
Agriculture Transfer Option (AS)
Agronomy (AS)
Animal Science (AS)
Crop Protection (CERT1, CERT2, AAS)
Food Science (AS)
Forestry (AS)
Golf Course Management (AS)
Horticulture/Turf Management (AS)
Milling Science (AS)
Park Mgmt & Conservation (AS)

AUTOMOTIVE TECHNOLOGY

Automotive Technology (CERT3, AAS)

BUSINESS/ECONOMICS

Accounting (AS)
Agribusiness (AS)
Agricultural Economics (AS)
Agriculture Business Mgmt (AAS*)
Bus Management & Leadership (AAS, ONLINE)
Business (AS, ONLINE)
Business Admin Technology (AAS*, ONLINE*)
Business Technology (AAS, ONLINE)
Economics (AS, ONLINE)
Finance (AS)
Golf Course Management (AS)
Management (AS)
Marketing (AS)
Park Mgmt & Conservation (AS)
Pension Administration (SAPP*)
Public Administration (AA, AS)
Tech Accounting Specialist (AAS, ONLINE)

COMMUNICATION

English (AA, AS)
Journalism (AA, AS)
Modern Languages (AA, AS)
Speech Communications (AA, AS)

COMPUTER/INFORMATION TECHNOLOGY

Computer Aided Drafting (CERT1)
Computer Information Systems (AS)
Computer Networking Specialist (CERT2, ONLINE)
Computer Science (AS)

EARLY CHILDHOOD

Early Childhood (AAS, ONLINE)
Early Childhood Education (AA, AS, ONLINE)

EDUCATION

Art Education (AA, AS)
Early Childhood Education (AA, AS, ONLINE)
Elementary Education (AA, AS)
Infant/Toddler Education & Care (CERT1)
Math Education (AA, AS)
Music Education (AA, AS)
Physical Education (AA, AS)
Preschool Education (CERT1)
Secondary Education (AA, AS)
Special Education (AA, AS)

FINE AND PERFORMING ARTS

Art (AA, AS)
Art Education (AA, AS)
Dance (AA, AS)
Graphic Design (AA)
Music (AA, AS)
Music Education (AA, AS)
Photography (AA, AS)
Theatre (AA, AS)

GENERAL STUDIES

General Studies (AGS, ONLINE)
Military Studies Emphasis (AGS*)

HEALTH PROFESSIONS

Certified Medication Aide (SAPP++)
Certified Nurse Aide (SAPP++)
Dietary Management (AS, ONLINE)
Dietary Manager (CERT1, ONLINE)
Dietetics (AS)
Emergency Medical Responder (SAPP++)
EMS Administration (AAS)
EMT (SAPP+)
EMT: Intermediate (SAPP++)
Home Health Aide (SAPP++)
IV Therapy (SAPP++)
Medical Admin Technology (AAS, ONLINE)
Medical Assistant (AAS, CERT3)
Medical Coding (CERT2, ONLINE)
Medical Lab Technician (AS, AAS, ONLINE)
Medical Transcriptionist (CERT2, ONLINE)
Nursing - ADN (AAS)
Nursing - PN (CERT2)
Nursing - Transfer (AA, AS)
Paramedic (AAS)
Pharmacy (AA, AS)
Pharmacy Technician (CERT1)
Phlebotomy Training (SAPP+)
Physical Therapy (AA, AS)
Pre-Nursing (AS)

2012 DECEMBER

November 2012						
S	M	T	W	T	F	S
			1	2	3	
4	5	6	7	8	9	10
11	12	13	14	15	16	17
18	19	20	21	22	23	24
25	26	27	28	29	30	

January 2013						
S	M	T	W	T	F	S
		1	2	3	4	5
6	7	8	9	10	11	12
13	14	15	16	17	18	19
20	21	22	23	24	25	26
27	28	29	30	31		

SUNDAY

MONDAY

TUESDAY

WEDNESDAY

THURSDAY

FRIDAY

SATURDAY

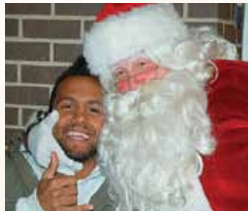

CollegeNEWS
news.bartoncc.edu
Catch up on all the latest campus news and happenings!



Cowley Classic:
Women's BB vs Southwestern
College JV 5 p.m. at Arkansas City
Highland Classic:
Men's BB vs Midland JV
TBA at Highland **1**

2

Final Examination Day
Free Late Night Breakfast
10-11 p.m., Union **3**

Financial Aid Payout
Final Examination Day
Women's BB vs KCK CC
5 p.m. at Barton
Men's BB vs KCK CC
7 p.m. at Barton **4**

Final Examination Day **5**

Final Examination Day
Close of Fall 2012 Semester **6**

Airport Transportation
10 a.m. Departure to Wichita,
Sign up at Student Life **7**

8

Women's BB vs Northwest
Technical College TBA at Goodland **9**

Summer 2013 Registration Begins
No Classes/Offices Open **10**

Financial Aid Payout
No Classes/Offices Open **11**

No Classes/Offices Open **12**

No Classes/Offices Open **13**

No Classes/Offices Open
Student Trip to Jackson Hole, WY
Ski/Snowboarding Trip (14th-17th):
Contact Joe Thornton **14**

15

16

No Classes/Offices Open **17**

No Classes/Offices Open **18**

Campus Closed **19**

Campus Closed **20**

Winter Begins
Campus Closed **21**

Campus Closed **22**

Campus Closed
23/30

Christmas Eve
Campus Closed
New Year's Eve
Campus Closed **1/31**

Christmas Day
Campus Closed **25**

Campus Closed **26**

Campus Closed **27**

Campus Closed **28**

Campus Closed **29**

Getting you to the next level

HEALTH, PHYSICAL EDUCATION, RECREATION

Athletic Training (AA, AS)
Exercise Science (AA, AS)
Physical Education (AA, AS)
Sports Administration (AA, AS)

HUMANITIES AND SOCIAL SCIENCES

Anthropology Cultural Studies (AA, AS)
History (AA, ONLINE)
Philosophy (AA, AS)
Political Science (AA, AS, ONLINE)
Psychology (AA, AS, ONLINE)
Religion (AA, AS)
Sociology (AA, AS)

INDUSTRIAL & ENERGY TECHNOLOGY

Computer Aided Drafting (CERT1)
Gas Measurement (CERT2)
Manufacturing Skills Cert (SAPP++)
Natural Gas Trans/Distrib Tech (CERT1, CERT2, AAS)

LIBERAL STUDIES

Liberal Studies (AA, AS, ONLINE)

MILITARY STUDIES/LEADERSHIP

Military Technology (CERT2++)

PRE-PROFESSIONAL

Architectural Engineering (AA, AS)
Architecture (AA, AS)
Chiropractic (AA, AS)
Dental Hygiene (AA, AS)
Dentistry (AA, AS)
Engineering Tech (AA, AS)
Health Information Mgmt (AA, AS)
Law (AA, AS)
Medicine (AA, AS)
Mortuary Science (AA, AS)
Occupational Therapy (AA, AS)
Optometry (AA, AS)
Physical Therapy (AA, AS)
Physical Therapy Asst (AA, AS)
Physicians Asst (AA, AS)
Radiology Tech (AA, AS)
Respiratory Therapy (AA, AS)
Social Work (AA, AS)
Veterinary Medicine (AS)
Wildlife Science (AS)

DEGREE CODES

AAS - Associate in Applied Science
C- Certificate
NDS - Non-degree seeking
SAP - Stand alone program
* - Emphasis of Study

PUBLIC SAFETY, CORRECTIONS AND SECURITY

Corrections (CERT1, AAS)
Criminal Justice (AS, AAS, CERT3, ONLINE)
Emerg Mgmt/Homeland Security (CERT2, AAS, ONLINE)
Emergency Medical Responder (SAPP++)
EMS Administration (AAS)
EMT (SAPP+)
EMT: Intermediate (SAPP++)
Fire Science Technology (CERT3, NDS)
Hazardous Materials Mgmt (CERT2, AAS, ONLINE)
Law Enforcement - Transfer (AS*)
Paramedic (AAS)

SCIENCE AND MATH

Biology (AA, AS)
Chemistry (AA, AS)
Engineering (AA, AS)
Geology (AA, AS)
Mathematics (AA, AS)
Physical Sciences (AA, AS)
Physics (AA, AS)
Wildlife Science (AS)

WHAT DRIVES YOU?

Undecided students are encouraged to contact Barton's Career Center.

PROGRAMS OF STUDY

Transfer Programs

Transfer programs are designed to prepare you for transferring to a four-year college or university.

Career Programs

Career programs offer you an opportunity to pursue certificate and degree programs designed to prepare you for employment in the workplace and/or transfer to a university.

2013 JANUARY

December 2012						
S	M	T	W	T	F	S
						1
2	3	4	5	6	7	8
9	10	11	12	13	14	15
16	17	18	19	20	21	22
23	24	25	26	27	28	29
30	31					

February 2013						
S	M	T	W	T	F	S
						1 2
3	4	5	6	7	8	9
10	11	12	13	14	15	16
17	18	19	20	21	22	23
24	25	26	27	28		

SUNDAY

MONDAY

TUESDAY

WEDNESDAY

THURSDAY

FRIDAY

SATURDAY



New Year's Day
Campus Closed

1

No Classes/Offices Open

2

No Classes/Offices Open

3

No Classes/Offices Open

4

Women's BB vs Seward
6 p.m. at Seward
Men's BB vs Seward
8 p.m. at Seward

5

6

No Classes/Offices Open
Women's BB vs Dodge City
5:30 p.m. at Barton
Men's BB vs Dodge City
7:30 at Barton

7

No Classes/Offices Open

8

No Classes/Offices Open
Women's BB vs Garden City
5:30 p.m. at Garden City
Men's BB vs Garden City
7:30 p.m. at Garden City

9

No Classes/Offices Open

10

Spring 2013 Registration Ends
No Classes/Offices Open
Airport Transportation, 2:30 p.m.
Pickup from Wichita, Sign up at
Student Life

11

Women's BB vs Butler
5:30 p.m. at Barton
Men's BB vs Butler
7:30 p.m. at Barton

12

13

Spring 2013 Classes Begin
Spring 2013 Late Registration
Begins
Meet & Greet – 8 p.m.,
Commons/Housing

14

15

Women's BB vs Hutchinson
5:30 p.m. at Hutchinson
Men's BB vs Hutchinson
7:30 p.m. at Hutchinson

16

\$3 Movie Night, Village Cinema

17

Spring 2013 Late Registration Ends
Student Trip to Aspen, CO Ski/
Snowboarding (18th-21st): Contact
Joe Thornton

18

19

20

Martin Luther King Jr. Day
(No Classes/Offices Closed)

21

22

Women's BB vs Colby
5:30 p.m. at Barton
Men's BB vs Colby
7:30 p.m. at Barton

23

Free Bowling, 7:30-10 p.m.
Eagle Lanes, Ellinwood

24

Last Day for Refund

25

Women's BB vs Pratt
6 p.m. at Pratt
Men's BB vs Pratt
8 p.m. at Pratt

26

27

Bingo
6 p.m., Union

28

29

Women's BB vs Cloud
5:30 p.m. at Barton
Men's BB vs Cloud
7:30 p.m. at Barton

30

\$3 Movie Night, Village Cinema

31



CollegeNEWS
news.bartonccc.edu
Catch up on all the
latest campus news
and happenings!

Supporting you when you need it

Academic Advising

A student-centered, advisor-driven system designed to increase student success and retention by promoting close and continuous contact between students, advisors, and the Barton student support structure.

Campus Security

Text messaging, surveillance cameras, and 24-hour security officers help support a safe campus life experience.

TRiO Programs

Provides free services for eligible students to assist in meeting educational and personal goals.

- Student Support Services
- Educational Opportunity Center
- Upward Bound Programs

Tutoring

FREE peer and professional tutoring during regular Learning Resource Center hours.

Counseling Services

Professional and personal counseling is available to assist students with personal or academic challenges.

Health Services

Free basic services are provided by a full-time registered nurse Monday through Friday with after-hours emergency service available.



FINDING WHAT DRIVES YOU

Barton's Career Center provides resources to help you find part-time jobs, internships, and prepare you for life beyond college. More importantly, we want to help you **DISCOVER YOUR POTENTIAL.**

Barton offers a wide variety of Student Services dedicated to assisting you in achieving greatness. Our services are designed to directly enhance student learning and support students' social and personal growth. We are continually inspired by the energy, diversity, and possibility our students bring to Barton.



2013 FEBRUARY

January 2013						
S	M	T	W	T	F	S
			1	2	3	4
6	7	8	9	10	11	12
13	14	15	16	17	18	19
20	21	22	23	24	25	26
27	28	29	30	31		

March 2013						
S	M	T	W	T	F	S
						1
3	4	5	6	7	8	9
10	11	12	13	14	15	16
17	18	19	20	21	22	23
24	25	26	27	28	29	30
31						

SUNDAY

MONDAY

TUESDAY

WEDNESDAY

THURSDAY

FRIDAY

SATURDAY



Priority Deadline to Apply for Spring 2013 Graduation

Women's BB vs Seward
5:30 p.m. at Barton
Men's BB vs Seward
7:30 p.m. at Barton

Super Bowl Party TBA, Housing

Homecoming Elections
8 a.m.-1:30 p.m., Union

Homecoming Finalist Elections
8 a.m.-1:30 p.m., Union
Barton Theatre Presents "Flyin' West"
3 p.m., Fine Arts Auditorium
Women's BB vs Dodge City
6 p.m. at Dodge City
Men's BB vs Dodge City 8 p.m. at Dodge City

Free Shoulder Massages
6-9 p.m., Union

Baseball vs Odessa at Odessa, TX

Women's BB vs Garden City
5:30 p.m. at Barton
Homecoming Crowning
7:30 p.m., Gym
Men's BB vs Garden City
7:30 p.m. at Barton
Baseball vs Odessa at Odessa, TX

Baseball vs Odessa at Odessa, TX

\$3 Movie Night, Village Cinema
Women's BB vs Butler
6 p.m. at Butler
Men's BB vs Butler
8 p.m. at Butler

Mardi Gras Celebration
11 a.m.-1:15 p.m., Union

Women's BB vs Hutchinson
5:30 p.m. at Barton
Men's BB vs Hutchinson
7:30 p.m. at Barton

Valentine's Day

Baseball vs Hutchinson

Baseball vs Southeast (NE) CC
2 p.m. at Barton

President's Day
Bingo
6 p.m., Union

Women's BB vs Colby
6 p.m. at Colby
Men's BB vs Colby
8 p.m. at Colby

Free Bowling, 7:30-10 p.m.
Eagle Lanes, Ellinwood

Baseball vs Western Nebraska
at Barton

SENIOR DAY
Baseball vs Western Nebraska
at Barton
Women's BB vs Pratt
5:30 p.m. at Barton
Men's BB vs Pratt
7:30 p.m. at Barton

Baseball vs Western Nebraska
at Barton

\$3 Movie Night, Village Cinema

Financial Aid Payout

Baseball vs Bethany JV
5 p.m. at Barton
Women's BB vs Cloud
5:30 p.m. at Cloud
Men's BB vs Cloud
7:30 p.m. at Cloud



CollegeNEWS
news.bartonccc.edu
Catch up on all the latest campus news and happenings!

Make your dreams happen

Barton is driven to help make college affordable for everyone. With low tuition rates and various ways to help students, Barton wants to ensure your focus is on your future.

With over \$10.7 million paid last year, opportunities exist to help ease your financial burden. Barton offers awards based on your academic achievement, involvement in student activities and organizations, as well as, offering student employment opportunities.

Students interested in applying for academic scholarships, activity scholarships, departmental scholarships, and federal financial aid are encouraged to apply early. Barton's academic scholarship deadline is March 15 for the fall semester and November 15 for the spring semester so don't delay... apply today!

For more information about financial opportunities at Barton, see our Financial Aid brochure or contact the Financial Aid Office at (620) 792-9270.

Campus employment

Campus employment provides employment opportunities that enable you to earn money to fund your education. Campus-based, Federal Work Study awards are based on documented need and availability of funds. To the extent possible, Barton will do its best to provide employment that complements and reinforces your educational and vocational career goals. For additional information, contact the Career Center at (620) 792-9349.

The scholarship deadline is March 15 for the fall semester and November 15 for the spring semester.



2012-2013 COST INFORMATION



PLANNING TIP: *Cost should not be a reason to rule out college!*

☛ Fill out the free application for Federal Student Aid at fafsa.ed.gov (Barton's Code: 004608)

☛ Payment options also available

Legal Residence in Kansas

Tuition	\$57/credit hour
Fees	\$30/credit hour

Legal Residence Outside of Kansas

Tuition	\$88/credit hour
Fees	\$30/credit hour

Annual Cost Estimates (Kansas resident)

Tuition & Fees	\$2,784 *based on 16 credit hours per semester
Books & Supplies	\$ 830 (estimated)
Residence Halls	\$4,880 (19 meals per week)
Total	\$8,494

The Barton Board of Trustees has the right to change tuition and fees without notice.
*A scholarship of \$3 per credit hour applies to Barton County residents.



The scholarship deadline is March 15 for the fall semester and November 15 for the spring semester.

Financial Opportunities

 In addition to Barton, check with your local high school counselor, chamber of commerce, churches and civic organizations for additional scholarship opportunities.

 Barton's Academic Scholarships will be available for six full-time semesters. They will annually renew with your most current Barton GPA.

 Payment options available.

 Over \$1 million dollars awarded annually in scholarships.

 Everyone should take the time to fill out the Free Application for Federal Student Aid. You may find out you qualify for federal grants, loans, and/or student employment. Simply go to www.fafsa.gov. Barton's FAFSA code is: 004608

Academic Scholarships

You must be a Kansas High School graduate (or a Kansas resident with a GED) to be eligible for the Academic Scholarship. The award is based upon the higher of your high school GPA or ACT score. To be awarded a scholarship, you must complete and submit a Barton Admissions & Scholarship Application by March 15 for the fall semester and November 15 for the spring semester for the 2012-13 aid year.

The scholarship will be available for six full-time semesters and will renew annually with your most current Barton GPA.

Jayhawk Conference rules state that if you are receiving an athletic books and tuition scholarship, you must meet a 3.5 GPA criteria upon high school graduation to accept a Barton Academic Scholarship in addition to the Barton Athletic Scholarship.

Activity and Departmental Scholarships

Activity and Departmental Scholarships are offered by instructors or staff from various Barton programs. Selection is made for special skills and/or performing abilities with the student expected to complete specified obligations. The sponsor administering the award determines contract obligations and award amounts. Areas offering Activity and Departmental awards include: Band, Vocal, Agriculture, Drama, Journalism, Forensics, Student Government, Admissions, Athletic Student Trainers, Dance Line and Cheerleading.

Foundation Scholarships

As part of its mission, the Barton Community College Foundation provides and funds a large number of scholarships to traditional or non-traditional students attending Barton for educational opportunities or training. Thanks to the generosity of many donors, endowments and annually funded scholarships with a wide variety of criteria are available

BARTON'S ACADEMIC SCHOLARSHIPS

**Additional Activity and Performance scholarships are available! Automatic award if admissions application is received by March 15 for the fall semester and November 15 for the spring semester.*

Award	Award Amount	Kansas HS GPA	GED Score	ACT Score
Excellence Award	\$1,000	3.5 and above	3500+	26+
Honor Award	\$800	3.0 - 3.49	3250 - 3490	24 - 25
Achievement Award	\$500	2.5 - 2.99	3000 - 3240	22 - 23
Merit Award	\$250	2.0 - 2.49	2750 - 2990	20 - 21

There are many options to find campus jobs as office worker, bookstore employee, art gallery attendant, lifeguard, maintenance worker, computer lab monitor and more!



257 students were awarded a total of \$192,955 in scholarships from the Barton Foundation.



\$10.7 million in financial aid was paid to Barton Students during the 2011-2012 school year.

to assist students. Scholarship application priority deadline is June 1 prior to the academic year. The application can be found at bartonccfoundation.org.



Building a community of friendships

Nothing spells fun more than living in a community of 292 of your fellow classmates from all across the world. You will have the opportunity to meet new people, begin life-long friendships, and develop life learning skills.

Barton considers Student Housing an important part of your total education. Comfortable living conditions have a major influence on your academics, habits, attitudes and ideals. Your social life, loyalty to the college, attitude toward others, and your sense of belonging evolve from the community you'll join in Student Housing.

FEATURES

- Wireless internet campus-wide including student housing
- Two FREE Laundromats
- Meal plan includes 19 meals per week
- Housing for 292 students including 12 single rooms
- Phone service
- FREE cable available in each room including free movie channels
- Plenty of spaces in student housing parking lots and no additional fee for a parking permit
- Tennis courts
- Vending machines for snacks, beverages and laundry supplies
- A study desk and wardrobe area as well as extra long twin beds, bunked or lofted, in each room
- Community meeting room with big-screen color television and a Wii game console
- Special accommodations for students with disabilities
- Do-it-yourself kitchen areas available with stove, microwave, refrigerator and ice machine
- Housing complex area storm shelter
- 24-hour security and camera surveillance
- Two Eco-friendly drinking water stations
- Sand volleyball pit

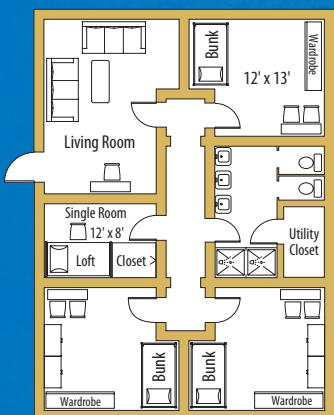

Bluestem Halls:
There will be some variation between units "Community Style" (6-7 people per unit)

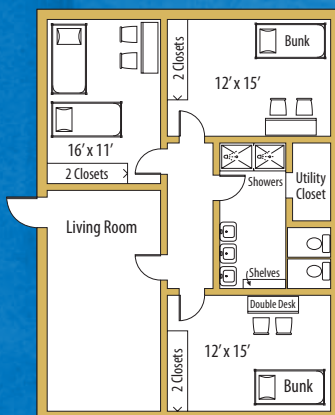

Meadowlark Halls:
There will be some variation between units "Community Style" (6-7 people per unit)

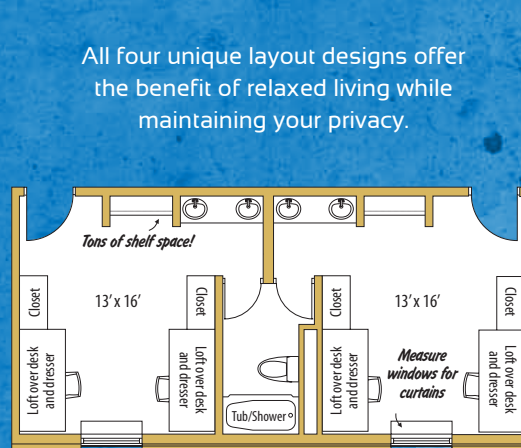

Cottonwood Hall: Handicap accessible rooms available "Traditional Style" (2 people per room)

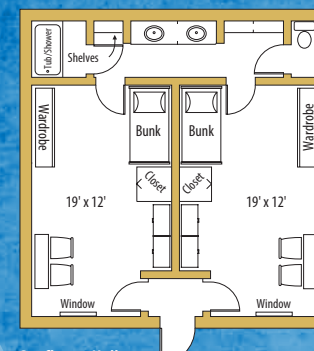

Sunflower Halls:
Two rooms, double occupancy "Apartment Style" (2 people per room)

Free wireless Internet!

Free unlimited laundry service for our housing students!

2013 MARCH

February 2013						
S	M	T	W	T	F	S
					1	2
3	4	5	6	7	8	9
10	11	12	13	14	15	16
17	18	19	20	21	22	23
24	25	26	27	28		

April 2013						
S	M	T	W	T	F	S
1	2	3	4	5	6	
7	8	9	10	11	12	13
14	15	16	17	18	19	20
21	22	23	24	25	26	27
28	29	30				

SUNDAY

MONDAY

TUESDAY

WEDNESDAY

THURSDAY

FRIDAY

SATURDAY



CollegeNEWS
news.bartonccc.edu
Catch up on all the latest campus news and happenings!



Baseball vs Pratt
3 p.m. at Pratt

1

Student Trip to Eisenhower Museum (Abilene): 1 p.m. Departure, Contact Joe Thornton
Baseball vs Pratt
2 p.m. at Pratt

2

Baseball vs Pratt
2 p.m. at Pratt

3

Meet & Greet 8 p.m., Commons/Housing

4

5

Baseball vs FHSU JV
4 p.m. at Hays

6

Free Bowling 7:30-10 p.m.
Eagle Lanes, Ellinwood

7

Last Day of 1st 8-Week Session
Barton Theatre Mainstage
Production/Musical 7:30 p.m., Fine Arts Auditorium

8

Barton Theatre Mainstage
Production/Musical 7:30 p.m., Fine Arts Auditorium
Baseball vs Seward
1 p.m. at Barton

9

Barton Theatre Mainstage
Production/Musical 2 p.m., Fine Arts Auditorium
Baseball vs Seward
1 p.m. at Barton

10

First Day of 2nd 8-Week Session
Free Shoulder Massages
6-9 p.m., Union

11

Financial Aid Payout
Baseball vs Brown Mackie
4 p.m. at Brown Mackie

12

Softball vs Colby at Barton
\$3 Movie Night, Village Cinema

13

14

15

Baseball vs Colby
1 p.m. at Colby

16

Baseball vs Colby
1 p.m. at Colby

17

Spring Break
(No Classes/Offices Open)

18

Spring Break
(No Classes/Offices Open)
Baseball vs Iowa Western
at Barton

19

Spring Begins
Spring Break
(No Classes/Offices Open)
Softball vs Garden City at Barton

20

Spring Break
(No Classes/Offices Closed)

21

Spring Break
(No Classes/Offices Closed)

22

Baseball vs Cloud
1 p.m. at Barton
Softball vs Seward at Seward

23

Baseball vs Cloud
1 p.m. at Barton

24/31
Easter

Men's Golf at Emporia Municipal
8 a.m.

25

Financial Aid Payout
Baseball vs Bethany JV
5 p.m. at Barton
\$3 Movie Night, Village Cinema

26

Softball vs Butler at Butler

27

28

Good Friday
(No Classes/Offices Closed)
Baseball vs Butler
1 p.m. at Butler

29

Baseball vs Butler
1 p.m. at Butler

30

College is what you make of it

Enhance your college experience!
Have fun! ☺ Meet new people!
Get involved!

Student Activities & Organizations

Campus Christian Fellowship

Cheer Squad

Collegiate Farm Bureau

Collegiate Music Educators National Conference

Community Student Organization

Computer Club

Concert Band

Concert Choir

Cougar Dance Team

Da Capo

Debate

Dolce

Forensics

Hispanic American Leadership Organization (HALO)

International and Multicultural Society

Jazz Band

Journalism Crew

Lambda Alpha Epsilon

National Honor Societies

Nursing Club

Orchestra

Pep Band

Phi Theta Kappa

St. Justa Pottery Guild

Student Ambassadors

Student Government Association

The Hilltop Singers

The Interrobang



2013 APRIL

March 2013						
S	M	T	W	T	F	S
				1	2	
3	4	5	6	7	8	9
10	11	12	13	14	15	16
17	18	19	20	21	22	23
24	25	26	27	28	29	30
31						

May 2013						
S	M	T	W	T	F	S
				1	2	3
4	5	6	7	8	9	10
11	12	13	14	15	16	17
18	19	20	21	22	23	24
25	26	27	28	29	30	31

SUNDAY

MONDAY

TUESDAY

WEDNESDAY

THURSDAY

FRIDAY

SATURDAY



Easter Monday
(No Classes/Offices Closed)
Women's Golf at StoneRidge
(Great Bend)

1

Women's Golf at StoneRidge
(Great Bend)

2

Bingo
6 p.m., Union

3



Last Day to Drop with Courses
Recorded as "W" on Transcript

5

Student Trip to Wichita Zoo 1 p.m.
Departure, Sign up at Student Life
Baseball vs Longview
2 p.m. at Longview

6

Baseball vs Longview
1 p.m. at Longview

7

Men's Golf at Salina Municipal
8 a.m.
Meet & Greet 8 p.m.,
Commons/Housing

8

Financial Aid Payout

9

Baseball vs Hesston
6:30 p.m. at Hesston
Softball vs Garden City
at Garden City

10

Senate Election for
Sophomore Positions
8 a.m.-1 p.m., Union
\$3 Movie Night, Village Cinema

11



Baseball vs Dodge City
1 p.m. at Barton

13

Baseball vs Dodge City
1 p.m. at Barton
Women's Golf at Salina Municipal

14

Fall 2013 Registration Begins
Women's Golf at Salina Municipal

15

Advisement Day (No Day Classes)

16

Baseball vs Brown Mackie
6 p.m. at Junction City
Softball vs Colby at Colby

17

Free Bowling 7:30-10 p.m.
Eagle Lanes, Ellinwood

18



Baseball vs Garden City
1 p.m. at Garden City
Softball vs Seward at Barton

20

Baseball vs Garden City
1 p.m. at Garden City
Women's Golf at Hesston
Women's Golf at Carey Park
(Hutchinson)

21

Men's Golf at Sand Creek (Newton)
8 a.m.
Women's Golf at Hesston
Women's Golf at Carey Park
(Hutchinson)

22

Financial Aid Payout
Baseball vs Brown Mackie
4 p.m. at Barton

23

6th Annual Hawaiian Luau &
Dance, Union
Softball vs Butler at Barton

24

\$3 Movie Night, Village Cinema

25

Baseball vs Hutchinson
6 p.m. at Barton

26

Baseball vs Hutchinson
2 p.m. at Barton

27

Baseball vs Hutchinson
2 p.m. at Barton

28



CollegeNEWS
news.bartonccc.edu

Catch up on all the
latest campus news
and happenings!

Learning wherever you are

HIGH SCHOOL "JUMP START" COURSES

Barton provides high school sophomores, juniors, seniors, and gifted underclassmen college classes while in high school.

Dual Credit/Concurrent Classes (College Advantage Program) -

Barton offers college classes in your high school (within Barton's seven county service area).

Get Ahead Program (GAP) -

Barton's on-campus afternoon college courses are designed to give high school students a sneak peek of what to expect in a college class environment and coursework.

BARTonline and EduKan offer seven sessions and more than 400 course selections per semester for your online degree.



BARTonline: (877) 620-6606

\$133 per semester credit hour

BARTonline.org provides you the opportunity to earn or complete an Associate Degree online. Courses taken at other colleges and universities, plus any military and work experience, may be applied towards degree completion requirements at Barton.



EduKan: (877) 433-8526

\$130 per semester credit hour

EduKan.org is an online consortium consisting of Barton and five other community colleges. EduKan provides you another opportunity within the Barton family to obtain your Associate Degree online.

ONLINE LEARNING

We think you will find the overall cost very reasonable when compared to traveling and living on-campus at some colleges. Remember, you can be employed and study at the same time, because online courses can be taken around your busy schedule.

Each online learning entity charges one flat rate per semester credit hour, plus the cost of textbooks and additional materials. This fee is the same for all online students regardless of Kansas residency.

Costs for online courses are subject to change.



K-STATE AT BARTON

The Kansas State University Wildcats and the Barton Community College Cougars have joined together to form a K-State at Barton partnership. The Cats and Cougars are working together to provide high quality, full service educational opportunities to people in Central Kansas.

The K-State at Barton Partnership brings education closer by:

- Offering distance education courses, bachelor's degree and master's degree programs to Central Kansas
- Developing transfer and articulation agreements between Barton and K-State
- Assisting current Barton students with admission to Kansas State University
- Providing area residents with opportunities for certification and degree completion as well as professional development

For more information, contact Jennifer Pfortmiller at (620) 786-1188 or bartondce@ksu.edu, or visit the K-State at Barton website at dce.k-state.edu/affiliations/2+2/barton.

2013 MAY

April 2013						
S	M	T	W	T	F	S
	1	2	3	4	5	6
7	8	9	10	11	12	13
14	15	16	17	18	19	20
21	22	23	24	25	26	27
28	29	30				

June 2013						
S	M	T	W	T	F	S
						1
2	3	4	5	6	7	8
9	10	11	12	13	14	15
16	17	18	19	20	21	22
23	24	25	26	27	28	29
30						

SUNDAY

MONDAY

TUESDAY

WEDNESDAY

THURSDAY

FRIDAY

SATURDAY



CollegeNEWS
news.bartonccc.edu
Catch up on all the latest campus news and happenings!



1

Free Shoulder Massages
6-9 p.m., Union
2

3

Student Trip to Hays & Victoria
1 p.m. Departure, Sign up at Student Life
Baseball Region VI Playoffs
4

Baseball Region VI Playoffs
5

\$3 Movie Night, Village Cinema
Baseball Region VI Playoffs
6

7

Bingo
6 p.m., Union
Financial Aid Payout
8

9

Barton Theatre's "A Night in the Theatre" 8 p.m.-8 a.m., Fine Arts Auditorium
10

Baseball Regional Championship
11

Mother's Day
Baseball Regional Championship
12

Final Examination Day
Baseball Regional Championship
Free Late Night Breakfast
10-11 p.m., Union
13

Final Examination Day
14

Final Examination Day
Financial Aid Payout
15

Final Examination Day
Close of Spring 2013 Semester
16

Commencement
17

Airport Transportation 10 a.m.
Departure to Wichita, Sign up at Union
18

19

Summer Hours Begin
Offices Open 7:30 a.m.-5 p.m.
Monday-Thursday - Closed Fridays
20

21

22

23

Campus Closed, Summer Hours
24

25

26

Memorial Day (Offices Closed)
27

28

29

Summer 2013 Registration Ends
30

Campus Closed, Summer Hours
31

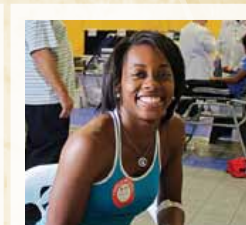

Campus Improvements

Student Union

The union has never been remodeled since its construction in 1972. The list of renovations include the following: completely remodeled bathrooms, automatic sliding glass doors on the north entryway, new tile upstairs and in the bookstore, dining area in the bookstore, a remodel of the cafeteria including new tables and chairs for the dining area and closed-circuit flat-screen televisions. The crow's nest area received computers and plush seating and various areas received new windows, carpet and paint.

"Education is the most powerful weapon with which to change the world."

Nelson Mandela



Student Union Remodel
Ribbon Cutting - August 3, 2012



Coffee Cove

Enjoy a cup of coffee located in the Learning Resource Center.



Gym

The Kirkman gym has also seen improvements over the past year. Not only has it received a fresh coat of paint, but an electronic scores table has also been added to make the gym have a more dynamic atmosphere.



2013 JUNE

May 2013						
S	M	T	W	T	F	S
			1	2	3	4
5	6	7	8	9	10	11
12	13	14	15	16	17	18
19	20	21	22	23	24	25
26	27	28	29	30	31	

July 2013						
S	M	T	W	T	F	S
			1	2	3	4
5	6	7	8	9	10	11
12	13	14	15	16	17	18
19	20	21	22	23	24	25
26	27	28	29	30	31	

SUNDAY

MONDAY

TUESDAY

WEDNESDAY

THURSDAY

FRIDAY

SATURDAY

				<p><i>CollegeNEWS</i> news.bartoncc.edu</p> <p>Catch up on all the latest campus news and happenings!</p>		<p>Priority Deadline to Apply for Summer 2013 Graduation</p> <p>1</p>				
2	Summer 2013 Classes Begin	3	Last Day for Late Registration for 1st 4-Week & 8-Week Sessions	4	Last Day for Refund for 1st 4-Week & 8-Week Sessions	5	Campus Closed, Summer Hours	6	7	8
9	10	11	12	13	14	15	Campus Closed, Summer Hours	16	17	18
Father's Day	17	18	19	20	21	22	Campus Closed, Summer Hours	23/30	24	25
23/30	No Drops/Withdrawals for 1st 4-Week Session	26	27	Last Day of Classes for 1st 4-Week Session Financial Aid Payout	28	29	Campus Closed, Summer Hours			

Local Opportunities

Our campus and community are growing and improving!
Great places ... Great people ... Great Bend!

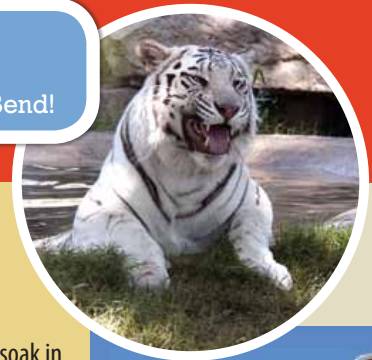

City of Great Bend

Listed as a “Best Places” city by *U.S. News & World Report*, come spend a day with great people in a great place ... Great Bend!!

With more than 15,000 residents, visit Great Bend and find a wide variety of things to do while enjoying a small town with all the amenities of a small city.

COMMUNITY EVENTS

- Cinco de Mayo Celebration
- Championship Drag Racing
- The Barton County Fair with Fireworks Extravaganza
- Juneteenth - Celebration of African American freedom and heritage
- Polka Days
- Community Theatre in the historic Crest Theatre
- Barton County Historical Museum and Village
- Big Bend Bike Rally

BRIT SPAUGH PARK

- Brit Spaugh Zoo
- Skateboard park
- BMX bike park
- Baseball and softball diamonds
- Tennis courts
- Horseshoe pits
- Wetlands Aquatic Park

VETERAN'S MEMORIAL PARK

- Fishing lake
- Limited boating: canoe, kayak
- Ball field complex
- Baseball and softball fields
- Tennis courts
- Physical fitness trail
- Walking trail with floating bridge
- Floating fishing dock
- Argonne Forest
- Assorted play equipment
- Sand beach
- Sand beach volleyball
- Dog park

OTHER

Wetlands

Aquatic Park

Zoom down the slides, soak in the sun, or kick back and relax in the shade at the Wetlands Aquatic Park. The Wetlands features 8 slides, 39 spray “features,” a 10,000 sq. foot swimming pool, Water Wars, and ONE BIG BUCKET dropping more than 300 gallons of water over the top of anyone daring to stand below.

Trail of Lights

The award-winning Trail of Lights holiday displays are like coming home to a perfect little Midwestern Christmas village.

Cheyenne Bottoms Wildlife Refuge

Designated a “Wetland of International Importance,” the refuge is a 41,000-acre basin-like lowland and is considered the largest marsh in the interior of the United States.



The L. E. “Gus” and Eva Shafer Memorial Art Gallery has been referred to as the “Gem of the Campus” at Barton. With 7,700 square feet of exhibit space, the gallery sees more than 7,000 annual visitors. Including the works of Shafer, the exhibit displays art from various artists, students, and exhibits from around the country.

2013 JULY

June 2013						
S	M	T	W	T	F	S
						1
2	3	4	5	6	7	8
9	10	11	12	13	14	15
16	17	18	19	20	21	22
23	24	25	26	27	28	29
						30

August 2013						
S	M	T	W	T	F	S
						1 2 3
4	5	6	7	8	9	10
11	12	13	14	15	16	17
18	19	20	21	22	23	24
25	26	27	28	29	31	

SUNDAY

MONDAY

TUESDAY

WEDNESDAY

THURSDAY

FRIDAY

SATURDAY



First Day of Classes for 2nd 4-Week Session

1

2

3

4

5

6

Independence Day
(No Classes/Offices Closed)

Campus Closed, Summer Hours

Last Day for Late Registration for 2nd 4-Week Session

7

8

9

10

11

12

13

Campus Closed, Summer Hours

14

15

16

17

18

19

20

No Drops/Withdrawals for 8-Week Session
Financial Aid Payout

Campus Closed, Summer Hours

21

22

23

24

25

26

27

No Drops/Withdrawals for 2nd 4-Week Session

Campus Closed, Summer Hours

28

29

30

31

Last Day of Classes for 8-Week Session
Last Day of Classes for 2nd 4-Week Session



CollegeNEWS
news.bartonccc.edu

Catch up on all the latest campus news and happenings!

Living the Dream

Succeeding in class is important but so is succeeding in life. At Barton, the knowledge you learn in the classroom will help you apply it to what really matters...real life.

The Barton Experience is flexible, agile and ready to accommodate students from all walks of life!



If you have the desire to have a dynamic and fun college experience, Barton provides opportunities to get involved, perhaps even "RE-INVENTING ONESELF." With more than 30 clubs, organizations, and performance groups there is something for everyone to live the dream!



Barton also offers the opportunity to get job training quickly to help you either **GET TO THE WORKFORCE OR IMPROVE YOUR SKILLS** at your current workplace.



For some, it's knowing that the faculty and staff at Barton **TRULY CARE ABOUT YOU AS A PERSON** first and foremost.

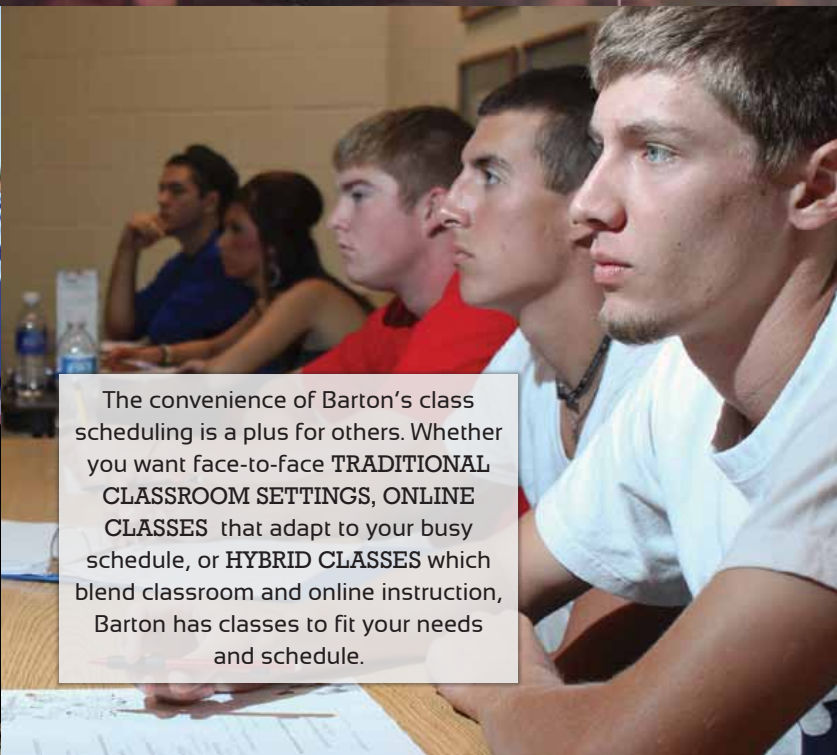

The convenience of Barton's class scheduling is a plus for others. Whether you want face-to-face **TRADITIONAL CLASSROOM SETTINGS**, **ONLINE CLASSES** that adapt to your busy schedule, or **HYBRID CLASSES** which blend classroom and online instruction, Barton has classes to fit your needs and schedule.

About our campuses

Great Bend Campus

bartonccc.edu

Barton's main campus is located high atop a hill on 160 acres three miles northeast of Great Bend. The main campus includes eight primary buildings, four phases of student housing, the Cougar fields, and the Midwest Utility Pipeline Training Center.

Fort Riley Campus

fortriley.bartonccc.edu

Barton's proud association with Fort Riley and the U.S. Army began in 1984 with a single training contract. The Fort Riley campus administration building is located in Building 217 on the main post of Fort Riley. The campus also provides instructional services for Troop School, BSEP and LSEC, which are located on Custer Hill.

In addition, BARTonline, Barton's premier site for online courses, is administered from the Fort Riley campus.

Courses also are offered at a nearby outreach site located at Grandview Plaza, which is home to the Hazardous Materials Handling and Emergency Management, Emergency Medical Technician, and Paramedic programs.

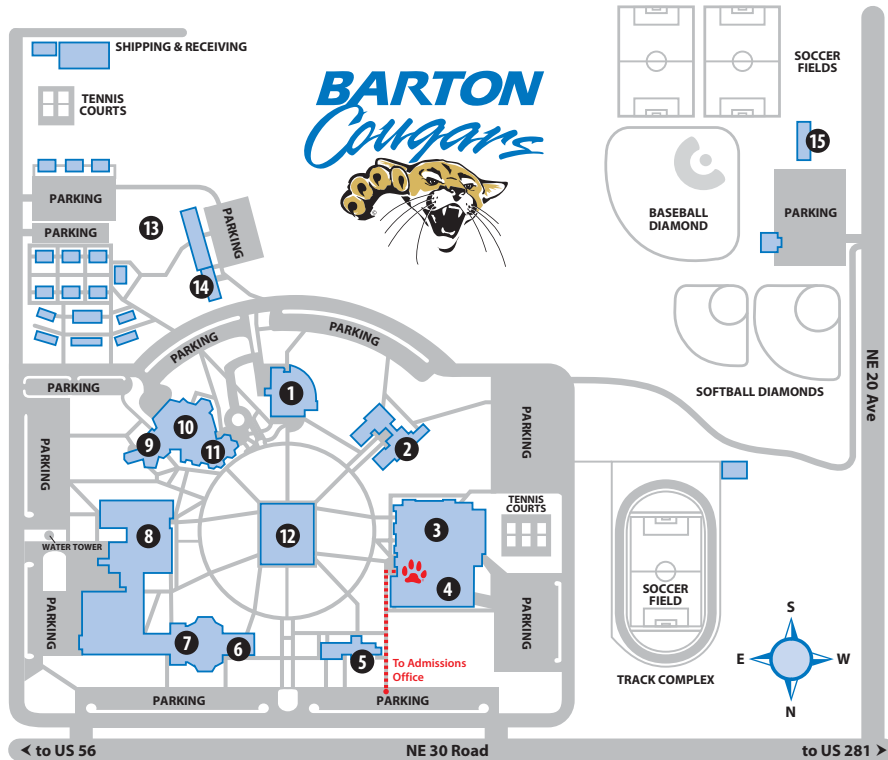

- | | |
|-----------------------------------|---|
| 1 U-Building, Union | 9 F-30, Seminar Room |
| 2 C-Building, Classroom | 10 F-Building, Fine Arts |
| 3 P-Building, Physical Education | 11 Shafer Gallery |
| 4 Kirkman Student Activity Center | 12 L-Building, Learning Resources Center |
| 5 A-Building, Administration | 13 Student Housing |
| 6 Planetarium | 14 Child Development Center |
| 7 S-Building, Science & Math | 15 Midwest Utility Pipeline Training Center |
| 8 T-Building, Technical Education | |

The Mission of Barton Community College is to provide quality educational opportunities that are accessible, affordable, continuously improving and student focused. Barton is driven to provide an educational system that is learning-centered, innovative, meets workforce needs, and strengthens communities.

BARTON

COMMUNITY COLLEGE

245 NE 30 RD • Great Bend, KS 67530-9251

(800) 722-6842 • GoBarton.com



The "Trooper Bill" statue stands as a tribute to the U. S. Cavalry symbolizing a man, a soldier, and of a service living on after him. Situated on the Cavalry Parade Field just north of the Barton-Fort Riley campus, this statue's base is also the resting place of "Chief" — the last horse carried on Army rolls as a cavalry mount. "Chief" died in 1968 and was buried with full military honors.

Cougar Checklist



Campus Tour - A great way to see if Barton is the place for you!



Admissions/Scholarship Application - Remember Barton's academic scholarship deadline is March 15 for the fall semester and November 15 for the spring semester. Application available online.



Submit ACT Scores or ASSET test scores - Haven't taken either of these assessment tests? No problem! Just give us a call and we'll get you taken care of.



Submit completed transcript(s) - Completed transcripts must be mailed directly to the Barton Admissions Office to be official. Unofficial transcripts can be used for advising and obtaining academic information (GPA, ACT Scores, etc.)



Housing Application - Submit application and deposit early to get your first choice! Application available online.



Financial Aid - Cost should not be a reason to rule out college! Visit fafsa.ed.gov for federal assistance or call us for even more options!

For more information, call the Admissions Office at (800) 722-6842 or (620) 792-9286

Non-Discrimination Notice: To provide equal employment, advancement and learning opportunities to all individuals, employment and student admission decisions at Barton will be based on merit, qualifications, and abilities. Barton County Community College does not discriminate on the basis of any characteristic protected by law in all aspects of employment and admission in its education programs or activities. Any person having inquiries concerning Barton County Community College's non-discrimination compliance policy, including the application of Equal Opportunity Employment, Titles IV, VI, VII, IX, Section 504 and the implementing regulations, is directed to contact the College's Compliance Officer, Barton County Community College, Room A-123, Great Bend, Kansas 67530, (620) 792-2701. Any person may also contact the Director, Office of Civil Rights, U.S. Department of Education, Washington, DC 20201.

For more information about our graduation rates, the median debt of students who completed the program, and other important information, please visit our website at ge.bartonccc.edu

See You Soon!

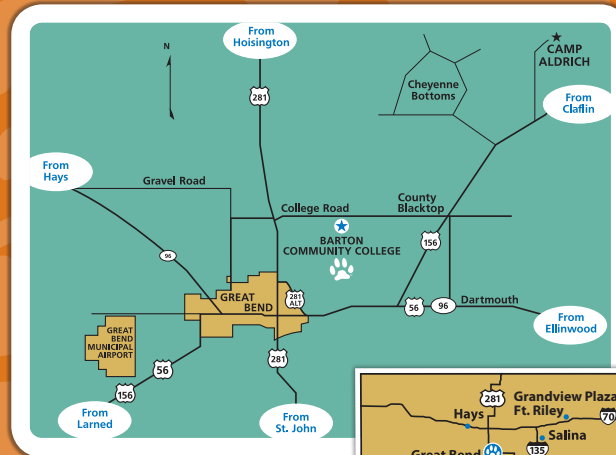

Want to get started?

Follow us!



Directory Information



WEB ADDRESS

GoBarton.com



BARTON COUNTY CAMPUS (main campus)

Local

(620) 792-2701

Toll-Free

(800) 748-7594

Address

245 NE 30 RD
Great Bend, KS 67530



FORT RILEY CAMPUS

Local

(785) 784-6606

Toll-Free

(877) 620-6606

Address

P.O. Box 2463, Building 217
Fort Riley, KS 66442
fr.bartonccc.edu



GRANDVIEW PLAZA OUTREACH SITE

Local

(785) 238-8550

Toll-Free

(877) 771-0255

Address

100 Continental Avenue
Grandview Plaza, KS 66441



ONLINE LEARNING OPPORTUNITIES

BARTonline.org

(877) 620-6606

edukan.org

(877) 433-8526