

2013-14 Calendar Viewbook



BARTON

COMMUNITY COLLEGE

WHAT DRIVES YOU?

GoBarton.com



Imagine the fun!



Barton has over 50 fun student activities planned through the year!

Memories for the making!

Hawaiian Luau, \$3 Movie Nights, Free Shoulder Massages, Bowling Nights, Mix and Mingle Bingo, Casino Night, Homecoming, Late Night Breakfasts, Mardi Gras Celebration



CATv 52: 12 new movie releases per month without even leaving the comforts of your dorm!

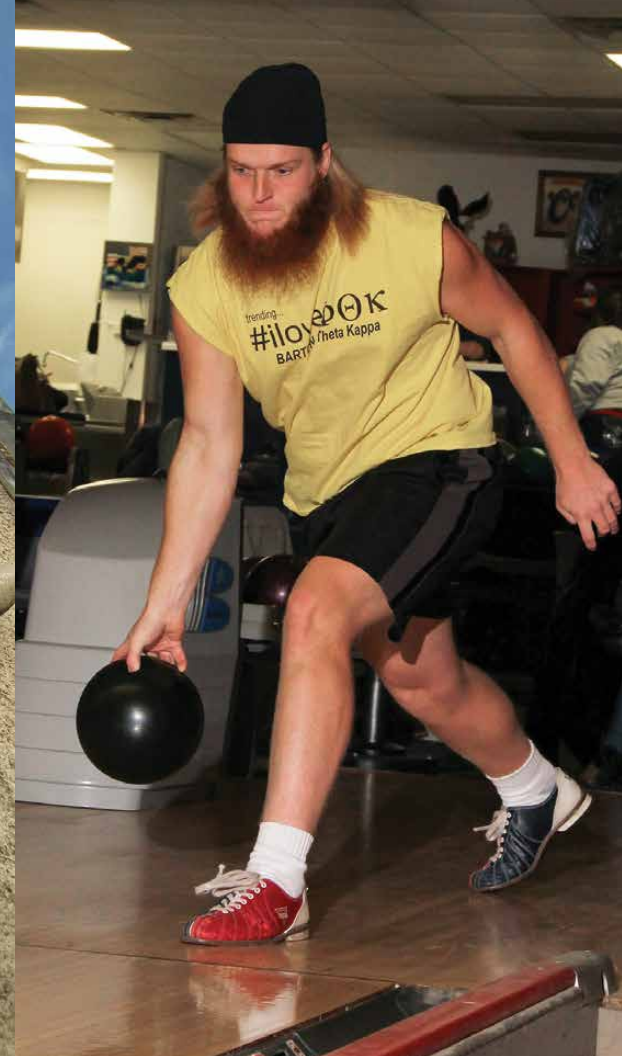

2013

September

August 2013						
S	M	T	W	T	F	S
			1	2	3	
4	5	6	7	8	9	10
11	12	13	14	15	16	17
18	19	20	21	22	23	24
25	26	27	28	29	30	31

October 2013						
S	M	T	W	T	F	S
			1	2	3	4
5	6	7	8	9	10	11
12	13	14	15	16	17	18
19	20	21	22	23	24	25
26	27	28	29	30	31	

SUNDAY	MONDAY	TUESDAY	WEDNESDAY	THURSDAY	FRIDAY	SATURDAY
1 Priority Deadline to Apply for Fall 2013 Graduation	2 Labor Day (No Classes/Offices Closed)	3	4 Volleyball vs Seward CC 6:30 p.m.	5 Women's Soccer at Cowley CC 5 p.m. Casino Night 6 p.m., Union Men's Soccer at Cowley CC 7 p.m.	6 Cross Country at Colby CC Invitational 6 p.m. M/W Tennis at Seminole State College Invitational, Oklahoma City, OK	7 State Fair Trip 1 p.m., Union Volleyball at Garden City CC 2 p.m. M/W Tennis at Seminole State College Invitational, Oklahoma City, OK
8 Women's Soccer vs Coffeyville CC 1 p.m. Men's Soccer vs Coffeyville CC 3 p.m.	9 Men's Golf at Quail Ridge 8 a.m., Winfield Free Bingo 6 p.m., Union	10	11	12 Student Government Elections, 10 a.m.-1:30 p.m., Union Women's Soccer at Cloud CC 2 p.m. Men's Soccer at Cloud CC 4 p.m. \$3 Movie Night, Golden Belt Cinema 6	13 Volleyball at Pizza Hut Invitational, Sterling, CO	14 Volleyball at Pizza Hut Invitational, Sterling, CO Cross Country at Blue Dragon Invitational 10 a.m., Hutchinson
15 Women's Golf at Meadow Lake 8 a.m., Colby Women's Soccer at KCKCC 1 p.m. Men's Soccer at KCKCC 3 p.m.	16 Women's Golf at Meadow Lake 8 a.m., Colby Meet & Greet 8 p.m., Commons/Housing	17 Constitution Day - Voter's Registration 11 a.m.-1:30 p.m., Union	18 Women's Soccer at Dodge City CC 1 p.m. Men's Soccer at Dodge City CC 3:30 p.m. Volleyball vs Pratt CC 6:30 p.m.	19 Free Bowling 7:30-10 p.m. Walnut Bowl	20 Volleyball at Wyo-Braska Shootout, Scottsbluff, NE Women's Tennis at Bethany Invitational, Lindsborg Men's Tennis at Bethany Invitational, Salina	21 Volleyball at Wyo-Braska Shootout, Scottsbluff, NE Women's Soccer vs Allen CC 2 p.m. Men's Soccer vs Allen CC 4 p.m. Women's Tennis at Bethany Invitational, Lindsborg Men's Tennis at Bethany Invitational, Salina
22 Fall Begins Women's Golf at Mariah Hills 8 a.m., Dodge City	23 Women's Golf at Mariah Hills 8 a.m., Dodge City Men's Golf at Turkey Creek 8 a.m., McPherson Book Fair 9 a.m.-4 p.m., Union \$3 Movie Night, Golden Belt Cinema 6	24 Financial Aid Payout	25 Volleyball vs Cloud CC 6:30 p.m.	26 Free Massages 6-9 p.m., Union	27 Barton Theatre Production of "A Piece of My Heart"	28 Volleyball vs Colby CC 6:30 p.m. Barton Theatre Production of "A Piece of My Heart"
29 Women's Soccer vs Neosho CC 2 p.m. Men's Soccer vs Neosho CC 4 p.m. Meet the Cougars 6 p.m., Great Bend	30					

CollegeNEWS
news.bartonccc.edu

Catch up on all the
latest campus news
and happenings!



Discovering new possibilities!

Why do you need to come on a tour at Barton?

- Enjoy a personalized tour of Barton to guarantee we are the perfect match for you! We want you to visit with our faculty and staff, tour our campus and student housing, eat a FREE lunch in our fabulous dining facility and have a GREAT time!
- Appointments available with Financial Aid and any sport, activity or organization you might be interested in!
- FREE parking! FREE Lunch! FREE Smiles! FREE T-shirt! FREE application for admission!

We'd Love
to Meet
You!



Tours are scheduled
Monday-Friday 8:30 a.m. - 3 p.m.
Give us at least a week's
notice and we will get your visit
scheduled to fit YOUR needs!
Go online to
GoBarton.com/prospective
or call (800) 722-6842 to
schedule a tour today!



2013

October

September 2013						
S	M	T	W	T	F	S
1	2	3	4	5	6	7
8	9	10	11	12	13	14
15	16	17	18	19	20	21
22	23	24	25	26	27	28
29	30					

November 2013						
S	M	T	W	T	F	S
						1 2
3	4	5	6	7	8	9
10	11	12	13	14	15	16
17	18	19	20	21	22	23
24	25	26	27	28	29	30

SUNDAY	MONDAY	TUESDAY	WEDNESDAY	THURSDAY	FRIDAY	SATURDAY
		1	2 Volleyball vs Hutchinson CC 6:30 p.m.	3 Free Bingo 6 p.m., Union	4 Volleyball at Seward CC 1 p.m. Women's Soccer vs Butler CC 4 p.m. Volleyball vs Western Texas College 5 p.m., Seward CC Men's Soccer vs Richland College 6:30 p.m.	5 Volleyball vs Vernon College 11 a.m., Seward CC Volleyball vs Frank Phillips College 3 p.m., Seward CC Men's BB at Dallas Jamboree Scrimmage
6 Men's Soccer vs Tyler Junior College 12 p.m., Dallas, TX Women's BB at Heartland Jamboree, Kansas City	7 Men's Golf at Alvamar 8 a.m., Lawrence	8 Financial Aid Payout Women's Soccer vs Independence CC 2 p.m. Men's Soccer vs Independence CC 4 p.m.	9 Volleyball vs Garden City CC 6:30 p.m.	10 \$3 Movie Night, Golden Belt Cinema 6	11 Last Day of 1st 8-Week Session Women's BB at Shalin Hoops Scrimmage, Frisco, TX	12 Cross Country at FHSU Tiger Invitational 9 a.m., Victoria Women's Soccer at Johnson CC 1:30 p.m. Men's Soccer at Johnson CC 3:30 p.m. Men's BB at Coffeyville Jamboree Scrimmage
13 Start of Decorate your door for Halloween Oct. 13-28, Housing Women's Golf at Coffeyville CC 8 a.m.	14 Columbus Day First Day of 2nd 8-Week Session Women's Golf at Coffeyville CC 8 a.m. Meet & Greet 8 p.m., Commons/Housing Barton Music Sneak Preview Concert	15 Volleyball at Dodge City CC 6:30 p.m.	16 Women's Soccer vs Northern Oklahoma 2 p.m. Men's Soccer vs Northern Oklahoma 4 p.m.	17 Fall Break (No Classes/Offices Open) Jack Kilby Science Day Volleyball at Pratt CC 6:30 p.m.	18 Fall Break (No Classes/Offices Open) Women's Golf at Pines Country Club 8 a.m., Valley, NE Cross Country at Ollie Isom Invitational 4 p.m., El Dorado	19 Women's Soccer vs Pratt CC 2 p.m. Men's Soccer vs Pratt CC 4 p.m. Women's BB at JUCO Jam Scrimmage, Wichita
20	21	22 Financial Aid Payout Volleyball at Cloud CC 6:30 p.m.	23 Women's Soccer at Garden City CC 6 p.m. \$3 Movie Night, Golden Belt Cinema 6	24 Volleyball at Colby CC 6:30 p.m. Free Bowling 7:30-10 p.m. Walnut Bowl	25 Men's BB Scrimmage at Fort Hays State 1 p.m.	26
27	28 Cross Country - Region VI Championship	29	30	31 Halloween Halloween Costume Dance 8-11 p.m., Union	 <p><i>Catch up on all the latest campus news and happenings!</i></p> 	

Striving for excellence

- 55 National Championships, 186 region and district championships, 113 conference championships, over 50 professional athletes, 33 Olympians and 10 Olympic medal winners
- **Women's sports:** Basketball, Cross Country, Golf, Soccer, Softball, Tennis, Track, Volleyball
- **Men's sports:** Baseball, Basketball, Cross Country, Golf, Soccer, Tennis, Track



Follow the Cougars year-round at BartonSports.com, social media and broadcast events via the internet.



2013

November

October 2013						
S	M	T	W	T	F	S
			1	2	3	4
6	7	8	9	10	11	12
13	14	15	16	17	18	19
20	21	22	23	24	25	26
27	28	29	30	31		

December 2013						
S	M	T	W	T	F	S
1	2	3	4	5	6	7
8	9	10	11	12	13	14
15	16	17	18	19	20	21
22	23	24	25	26	27	28
29	30	31				

SUNDAY	MONDAY	TUESDAY	WEDNESDAY	THURSDAY	FRIDAY	SATURDAY
	 <p><i>Catch up on all the latest campus news and happenings!</i></p>				<p>1 Last Day to Drop with Courses Recorded as "W" on Transcript Women's BB vs Arizona Western 5:30 p.m. Men's BB vs Fort Scott CC 7:30 p.m.</p>	<p>2 Women's BB vs McCook CC 5:30 p.m. Men's BB vs Raleigh 7:30 p.m.</p>
<p>3 Daylight Saving Time Ends</p>	<p>4 Free Bingo 6 p.m., Union</p>	<p>5 Financial Aid Payout Advisement Day (No Day Classes) Spring 2014 Registration Begins Men's BB vs Sterling 7:30 p.m.</p>	<p>6</p>	<p>7 \$3 Movie Night, Golden Belt Cinema 6</p>	<p>8 Women's BB vs St. Mary's JV 1 p.m., Salina Volleyball – Region VI Championship Men's BB vs Allen CC at Coffeyville CC</p>	<p>9 Women's BB at Kansas Wesleyan JV 1 p.m. Cross Country – NJCAA Nationals Volleyball – Region VI Championship Men's BB at Coffeyville CC</p>
<p>10</p>	<p>11 Veterans' Day</p>	<p>12</p>	<p>13 Women's BB at Hesston 6 p.m. Men's BB at Hesston 8 p.m. Free Massages 6-9 p.m., Union</p>	<p>14</p>	<p>15 Priority deadline for Barton Academic Scholarship for Spring 2014 Semester Women's BB vs Allen CC 12:30 p.m., Chanute Men's BB vs Northwest Kansas Tech 3 p.m., Salina</p>	<p>16 Men's BB vs Southeast Nebraska 1 p.m., Salina Women's BB vs Neosho CC 5:30 p.m., Chanute</p>
<p>17</p>	<p>18 Meet & Greet 8 p.m., Commons/Housing</p>	<p>19 Financial Aid Payout</p>	<p>20</p>	<p>21 Free Bowling 7:30-10 p.m. Walnut Bowl Volleyball – NCAA Div. I Championship</p>	<p>22 Men's BB at Indian Hills CC 7 p.m. Volleyball – NCAA Div. I Championship</p>	<p>23 Men's BB vs Marshalltown CC 4:30 p.m., Ottumwa, IA Volleyball – NCAA Div. I Championship</p>
<p>24</p>	<p>25 Prairie Winds Concert</p>	<p>26 Women's BB vs Tabor College JV 5:30 p.m. Men's BB vs McPherson College 7:30 p.m.</p>	<p>27 Thanksgiving Break (No Classes/Offices Closed)</p>	<p>28 Thanksgiving Day (No Classes/Offices Closed)</p>	<p>29 Thanksgiving Break (No Classes/Offices Closed) Women's BB vs Neosho CC 5:30 p.m. Men's BB vs Neosho CC 7:30 p.m.</p>	<p>30 Women's BB vs Independence CC 5:30 p.m. Men's BB vs Independence CC 7:30 p.m.</p>

Put your passion to work!

AGRICULTURE

Agribusiness (AS)
Agricultural Economics (AS)
Agricultural Education (AS)
Agriculture Business Mgmt (AAS)
Agriculture Communications (AS)
Agriculture Transfer Option (AS)
Agronomy (AS)
Animal Science (AS)
Beef Cattle Production (CERT1, CERT2)
Crop Protection (CERT1, CERT2, AAS)
Food Science (AS)
Forestry (AS)
Golf Course Management (AS)
Horticulture/Turf Management (AS)
Milling Science (AS)
Park Mgmt & Conservation (AS)

AUTOMOTIVE TECHNOLOGY

Automotive Technology (CERT3, AAS)

BUSINESS/ECONOMICS

Accounting (AS, ONLINE)
Agribusiness (AS)
Agricultural Economics (AS)
Agriculture Business Mgmt (AAS)
Bus Management & Leadership (AAS, ONLINE)
Business (AS, ONLINE)

Business Admin Technology (AAS, ONLINE)
Business Technology (AAS, ONLINE)
Economics (AS, ONLINE)
Finance (AS, ONLINE)
Golf Course Management (AS)
Management (AS, ONLINE)
Marketing (AS, ONLINE)
Park Mgmt & Conservation (AS)
Pension Administration (SAPP)
Public Administration (AS)
Qualified 401K Administrator (SAPP)
Retirement Plan Fundamentals (SAPP)
Tax Exempt Administrator (SAPP)
Tech Accounting Specialist (AAS, ONLINE)

COMMUNICATION

English (AA)
Journalism (AA)
Modern Languages (AA)
Speech Communications (AA)

COMPUTER/INFORMATION TECHNOLOGY

Computer Aided Drafting (CERT1)
Computer Information Systems (AS)
Computer Networking Specialist (AAS, CERT2, ONLINE)
Computer Science (AS)

EARLY CHILDHOOD

Early Childhood (AAS, ONLINE)
Early Childhood Education (AS, ONLINE)

EDUCATION

Art Education (AA, AS)
Early Childhood Education (AS, ONLINE)
Elementary Education (AS)
Infant/Toddler Education & Care (CERT1, ONLINE)
Math Education (AS)
Music Education (AA, AS)
Physical Education (AS)
Preschool Education (CERT1, ONLINE)
Secondary Education (AS)
Special Education (AS)

FINE AND PERFORMING ARTS

Art (AA)
Art Education (AA)
Dance (AA)
Graphic Design (AA)
Music (AS)
Music Education (AA)
Photography (AA)
Theatre (AA)

GENERAL STUDIES

General Studies (AGS, ONLINE)
Military Studies Emphasis (AGS)

HEALTH PROFESSIONS

Advanced Emergency Med Tech AEMT (SAPP)
Certified Medication Aide (SAPP)
Certified Nurse Aide (SAPP)
Dietary Management (AS, ONLINE)
Dietary Manager (CERT1, ONLINE)
Dietetics (AS, ONLINE)
Emergency Medical Responder (SAPP)
EMS Instructor Coordinator (SAPP)
EMS Training Officer I (SAPP)
EMS Training Officer II (SAPP)
EMT (SAPP)
Medical Admin Technology (AAS, ONLINE)
Medical Assistant (AAS, CERT3)
Medical Coding (CERT3, ONLINE)
Medical Lab Technician (AAS, ONLINE)
Medical Transcriptionist (CERT2, ONLINE)
Nursing - PN (CERT2)
Nursing - Transfer (AS)
Paramedic (AAS)
Pharmacy (AS)
Pharmacy Technician (CERT1, ONLINE)
Phlebotomy Training (SAPP)
Physical Therapy (AS)
Pre-Nursing (AS)
Registered Nursing (AAS)



PROGRAMS OF STUDY

Transfer programs are designed to prepare you for transferring to a four-year college or university.

Career programs offer you an opportunity to pursue certificate and degree programs designed to prepare you for employment in the workplace and/or transfer to a university.

WHAT DRIVES YOU?

Find your passion and put it to work! Undecided students are encouraged to contact Barton's Career Center.

2013

December

November 2013						
S	M	T	W	T	F	S
						1
3	4	5	6	7	8	9
10	11	12	13	14	15	16
17	18	19	20	21	22	23
24	25	26	27	28	29	30

January 2014						
S	M	T	W	T	F	S
						1
5	6	7	8	9	10	11
12	13	14	15	16	17	18
19	20	21	22	23	24	25
26	27	28	29	30	31	

SUNDAY	MONDAY	TUESDAY	WEDNESDAY	THURSDAY	FRIDAY	SATURDAY
1	2	3	4 Women's BB at Butler CC 5:30 p.m. \$3 Movie Night, Golden Belt Cinema 6	5 Financial Aid Payout	6 Women's BB vs Ancilla College 5:30 p.m., Trenton, MO	7 Women's BB at North Central Missouri College 3 p.m.
8	9 Summer 2014 Registration Begins Final Examination Day Women's BB vs Hesston 5:30 p.m. Men's BB vs Hesston 7:30 p.m. Free Late Night Breakfast 9:30-10:30 p.m., Union Barton Music Holiday Concert	10 Final Examination Day Financial Aid Payout	11 Final Examination Day Free Massages 6-9 p.m., Union	12 Final Examination Day Close of Fall 2013 Semester	13 No Classes/Offices Open	14 Airport Transportation to Wichita - Sign Up Required, Depart at 10 a.m.
15	16 No Classes/Offices Open	17 No Classes/Offices Open	18 No Classes/Offices Open	19 Campus Closed	20 Campus Closed	21 Winter Begins Campus Closed
22 Campus Closed	23 Campus Closed	24 Christmas Eve Campus Closed	25 Christmas Day Campus Closed	26 Campus Closed	27 Campus Closed	28 Campus Closed
29 Campus Closed	30 Campus Closed	31 New Year's Eve Campus Closed				



WHAT DRIVES YOU?
Undecided students are encouraged to contact Barton's Career Center.

Getting you to the next level

HEALTH, PHYSICAL EDUCATION, RECREATION

- Athletic Training (AS)
- Exercise Science (AS)
- Physical Education (AS)
- Sports Management (AS)

HUMANITIES AND SOCIAL SCIENCES

- Anthropology Cultural Studies (AA)
- History (AA, ONLINE)
- Philosophy (AA)
- Political Science (AA, ONLINE)
- Psychology (AS, ONLINE)
- Religion (AA)
- Sociology (AA)

INDUSTRIAL & ENERGY TECHNOLOGY

- Computer Aided Drafting (CERT1)
- Gas Measurement (CERT2)
- Manufacturing Skills Cert (SAPP)
- Natural Gas Trans/Distrib Tech (CERT2, AAS)

LIBERAL STUDIES

- Liberal Studies (AA, AS, ONLINE)

MILITARY STUDIES/LEADERSHIP

- Military Technology (CERT2)
- Military Logistics (CERT2)
- Military Dangerous Materials Handling (CERT2)

PRE-PROFESSIONAL

- Architectural Engineering (AS)
- Architecture (AS)
- Chiropractic (AS)
- Dental Hygiene (AS)
- Dentistry (AS)
- Engineering Tech (AS)
- Health Information Management (AS)
- Law (AA)
- Medicine (AS)
- Mortuary Science (AS)
- Occupational Therapy (AS)
- Optometry (AS)
- Physical Therapy (AS)
- Physical Therapy Assistant (AS)
- Physicians Assistant (AS)
- Radiology Tech (AS)
- Respiratory Therapy (AS)
- Social Work (AA)
- Veterinary Medicine (AS)
- Wildlife Science (AS)

PUBLIC SAFETY, CORRECTIONS AND SECURITY

- Advanced Emergency Med Tech AEMT (SAPP)
- Corrections (CERT1, AAS)
- Criminal Justice (AS, AAS, CERT3, ONLINE)
- Emerg Mgmt/Homeland Security (AAS, CERT2, ONLINE)
- EMT (SAPP)
- Hazardous Materials Mgmt (AAS, CERT2, ONLINE)
- Law Enforcement - Transfer (AS)
- Paramedic (AAS)

SCIENCE AND MATH

- Biology (AS)
- Chemistry (AS)
- Engineering (AS)
- Geology (AS)
- Mathematics (AS)
- Physical Sciences (AS)
- Physics (AS)
- Wildlife Science (AS)

PROGRAMS OF STUDY

Transfer programs are designed to prepare you for transferring to a four-year college or university.

Career programs offer you an opportunity to pursue certificate and degree programs designed to prepare you for employment in the workplace and/or transfer to a university.

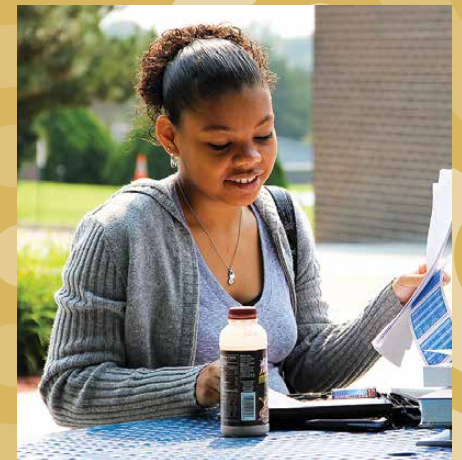

2014

January

December 2013						
S	M	T	W	T	F	S
1	2	3	4	5	6	7
8	9	10	11	12	13	14
15	16	17	18	19	20	21
22	23	24	25	26	27	28
29	30	31				

February 2014						
S	M	T	W	T	F	S
						1
2	3	4	5	6	7	8
9	10	11	12	13	14	15
16	17	18	19	20	21	22
23	24	25	26	27	28	

SUNDAY	MONDAY	TUESDAY	WEDNESDAY	THURSDAY	FRIDAY	SATURDAY
		<p><i>CollegeNEWS</i> news.bartonccc.edu</p> <p>Catch up on all the latest campus news and happenings!</p>	1 New Year's Day Campus Closed	2 No Classes/Offices Open	3	4 Men's BB at Brown Mackie 2 p.m. Women's BB at Cowley CC
5	6	7	8	9	10 Spring 2014 Registration Ends	11 Women's BB vs Pratt CC 5:30 p.m. Men's BB vs Pratt CC 7:30 p.m.
12	13 Spring 2014 Classes Begin Spring 2014 Late Registration Free Bingo 6 p.m., Union	14 Spring 2014 Late Registration	15 Spring 2014 Late Registration Women's BB vs Dodge City CC 5:30 p.m. Men's BB vs Dodge City CC 7:30 p.m.	16 Spring 2014 Late Registration \$3 Movie Night, Golden Belt Cinema 6	17 Spring 2014 Late Registration	18 Women's BB at Cloud CC 5:30 p.m. Men's BB at Cloud CC 7:30 p.m.
19	20 Martin Luther King Jr. Day (No Classes/Offices Closed)	21	22 Women's BB vs Seward CC 5:30 p.m. Men's BB vs Seward CC 7:30 p.m.	23 Free Bowling 7:30-10 p.m. Walnut Bowl	24 Last Day for Refund	25
26 Women's BB at Colby CC 2 p.m. Men's BB at Colby CC 4 p.m.	27 \$3 Movie Night, Golden Belt Cinema 6	28	29 Women's BB vs Hutchinson CC 5:30 p.m. Men's BB vs Hutchinson CC 7:30 p.m.	30	31	

Supporting you when you need it

Barton offers a wide variety of Student Services dedicated to assisting you in achieving greatness.

- **Academic Advising:** A student-centered system designed to increase student success and retention
- **Campus Security:** Text messaging, surveillance cameras and 24-hour security officers to help support a safe campus life experience
- **TRiO:** Free services for eligible students to help in meeting educational goals
- **Tutoring:** FREE peer and professional tutoring
- **Counseling Services:** Professional and personal counseling
- **Health Services:** FREE basic services by a full-time registered nurse

FINDING WHAT DRIVES YOU

Barton's Career Center provides resources to help you find part-time jobs, internships, and prepare you for life beyond college. More importantly, we want to help you **DISCOVER YOUR POTENTIAL.**



2014

February

January 2014						
S	M	T	W	T	F	S
			1	2	3	4
5	6	7	8	9	10	11
12	13	14	15	16	17	18
19	20	21	22	23	24	25
26	27	28	29	30	31	

March 2014						
S	M	T	W	T	F	S
						1
2	3	4	5	6	7	8
9	10	11	12	13	14	15
16	17	18	19	20	21	22
23	24	25	26	27	28	29
30	31					

SUNDAY MONDAY TUESDAY WEDNESDAY THURSDAY FRIDAY SATURDAY

						 <p>Priority Deadline to Apply for Spring 2014 Graduation Women's BB at Garden City CC 5:30 p.m. Men's BB at Garden City CC 7:30 p.m.</p>
 <p>Super Bowl Party, Commons/Cottonwood</p>			 <p>Free Massages 6-9 p.m., Union Women's BB at Dodge City CC 5:30 p.m. Men's BB at Dodge City CC 7:30 p.m.</p>			 <p>SENIOR DAY! Women's BB vs Cloud CC 5:30 p.m. Men's BB vs Cloud CC 7:30 p.m. Softball at Pratt CC Baseball at Odessa College</p>
 <p>Baseball at Odessa College</p>	 <p>Homecoming Elections 9 a.m.-1:30 p.m., Union \$3 Movie Night, Golden Belt Cinema 6</p>	 <p>Softball at Lamar CC</p>	 <p>Homecoming Finalist Elections 9 a.m.-1:30 p.m., Union Women's BB at Pratt CC 6 p.m. Men's BB at Pratt CC 8 p.m.</p>		 <p>Valentine's Day Softball vs Hutchinson CC</p>	 <p>Baseball vs Western Nebraska 1 p.m. Women's BB vs Colby CC 5:30 p.m. Homecoming 7 p.m., Gym Men's BB vs Colby CC 7:30 p.m.</p>
 <p>Baseball vs Western Nebraska 1 p.m.</p>	 <p>President's Day Meet & Greet 8 p.m., Commons/Housing</p>	 <p>Softball at Fort Scott CC 1 p.m.</p>	 <p>Baseball at Fort Hays State JV 3 p.m. Women's BB at Seward CC 6 p.m. Men's BB at Seward CC 8 p.m.</p>	 <p>Softball at Neosho CC 2 p.m. Free Bowling 7:30-10 p.m. Walnut Bowl</p>		 <p>Women's BB at Hutchinson CC 5:30 p.m. Men's BB at Hutchinson CC 7:30 p.m.</p>
	 <p>Baseball vs Midland JV 3 p.m.</p>	 <p>Financial Aid Payout Softball at Bethany 3 p.m.</p>	 <p>Baseball vs Bethany JV 4 p.m. Women's BB vs Garden City CC 5:30 p.m. Men's BB vs Garden City CC 7:30 p.m.</p>	 <p>Softball at Allen CC 2 p.m. \$3 Movie Night, Golden Belt Cinema 6</p>		 <p>Industrial/Mechanical/Construction, etc. and Manufacturing... ...the AMERICAN ECONOMY... ...the AMERICAN ECONOMY... ...the AMERICAN ECONOMY...</p>

Make your dreams happen

The scholarship deadline is March 15 for the fall semester and November 15 for the spring semester.



Barton is driven to help make college affordable for everyone. With low tuition rates and various ways to help students, Barton wants to ensure your focus is on your future.

With more than \$10 million paid last year, opportunities exist to help ease your financial burden. Barton offers awards based on your academic achievement, involvement in student activities and organizations, as well as, offering student employment opportunities.

Students interested in applying for academic scholarships, activity scholarships, departmental scholarships, and federal financial aid are encouraged to apply early. Barton's academic scholarship deadline is March 15 for the fall semester and November 15 for the spring semester so don't delay... apply today!

For more information about financial opportunities at Barton, see our Financial Aid brochure or contact the Financial Aid Office at (620) 792-9270.

Campus employment

Campus employment provides employment opportunities that enable you to earn money to fund your education. Campus-based, Federal Work Study awards are based on documented need and availability of funds. To the extent possible, Barton will do its best to provide employment that complements and reinforces your educational and vocational career goals. For additional information, contact the Career Center at (620) 792-9349.

2013-2014 COST INFORMATION



PLANNING TIP: *Cost should not be a reason to rule out college!*

- Fill out the free application for Federal Student Aid at fafsa.ed.gov (Barton's Code: 004608)
- Payment options also available

The scholarship deadline is March 15 for the fall semester and November 15 for the spring semester.

Legal Residence in Kansas	
Cost per credit hour	\$91
Legal Residence Outside of Kansas*	
Cost per credit hour	\$122

*Subject to change by the State of Kansas

Annual Cost Estimates (Kansas resident)	
Tuition	\$2,912 *based on 16 credit hours per semester x 2 semesters
Books	\$ 830 (estimated)
Housing	\$5,173 (19 meals per week)
Total Cost**	\$8,915

The Barton Board of Trustees has the right to change tuition without notice. *A scholarship of \$7 per credit hour applies to Barton County residents. **Cost is estimated based on basic charges and do not include other personal costs or costs associated with various classes nor cost of online courses.

FINANCIAL OPPORTUNITIES

 In addition to Barton, check with your local high school counselor, chamber of commerce, churches and civic organizations for additional scholarship opportunities.

 Barton's Academic Scholarships will be available for six full-time semesters. They will annually renew with your most current Barton GPA.

 Payment options available.

 Over \$1 million awarded annually in scholarships.

 Everyone should take the time to fill out the Free Application for Federal Student Aid. You may find out you qualify for federal grants, loans, and/or student employment. Simply go to www.fafsa.gov. Barton's FAFSA code is: 004608

Academic Scholarships

You must be a Kansas High School graduate (or a Kansas resident with a GED) to be eligible for the Academic Scholarship. The award is based upon the higher of your high school GPA or ACT score. To be awarded a scholarship, you must complete and submit a Barton Admissions & Scholarship Application by March 15 for the fall semester and November 15 for the spring semester for the 2013-14 aid year.

The scholarship will be available for six full-time semesters and will renew annually with your most current Barton GPA.

Jayhawk Conference rules state that if you are receiving an athletic books and tuition scholarship, you must meet a 3.5 GPA criteria upon high school graduation to accept a Barton Academic Scholarship in addition to the Barton Athletic Scholarship.

Activity and Departmental Scholarships

Activity and Departmental Scholarships are offered by instructors or staff from various Barton programs. Selection is made for special skills and/or performing abilities

with the student expected to complete specified obligations. The sponsor administering the award determines contract obligations and award amounts. Areas offering Activity and Departmental awards include: Band, Vocal, Agriculture, Drama, Journalism, Forensics, Student Government, Admissions, Athletic Student Trainers, Dance Line and Cheerleading.

Foundation Scholarships

As part of its mission, the Barton Community College Foundation provides and funds a large number of scholarships to traditional or non-traditional students attending Barton for educational opportunities or training. Thanks to the generosity of many donors, endowments and annually funded scholarships with a wide variety of criteria are available to assist students. Scholarship application priority deadline is June 1 prior to the academic year. The application can be found at bartonccfoundation.org.

There are many options for campus jobs such as an office worker, bookstore employee, art gallery attendant, lifeguard, maintenance worker, computer lab monitor and more!



BARTON'S ACADEMIC SCHOLARSHIPS

**Additional Activity and Performance scholarships are available! Automatic award if admissions application is received by March 15 for the fall semester and November 15 for the spring semester.*

Award	Award Amount	Kansas HS GPA	GED Score	ACT Score
Excellence Award	\$1,000	3.5 and above	3500+	26+
Honor Award	\$800	3.0 - 3.49	3250 - 3490	24 - 25
Achievement Award	\$500	2.5 - 2.99	3000 - 3240	22 - 23
Merit Award	\$250	2.0 - 2.49	2750 - 2990	20 - 21

235 students were awarded a total of \$239,000 in scholarships from the Barton Foundation.



More than \$10 million in financial aid was paid to Barton Students during the 2012-13 school year.

Building a community of friendships

Nothing spells fun like than living in a community of more than 300 of your fellow classmates from all across the world. You will have the opportunity to meet new people, begin life-long friendships, and develop life learning skills.

Barton considers Student Housing an important part of your total education. Comfortable living conditions have a major influence on your academics, habits, attitudes and ideals. Your social life, loyalty to the college, attitude toward others, and your sense of belonging evolve from the community you'll join in Student Housing.



FREE wireless Internet!
♥
FREE unlimited laundry service for our housing students!

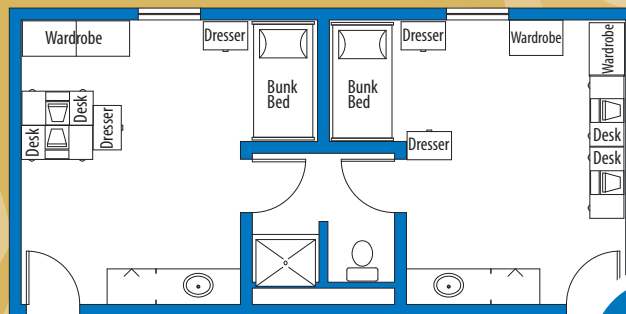

Bluestem Hall: Projected floor layout

Opening Fall 2014!

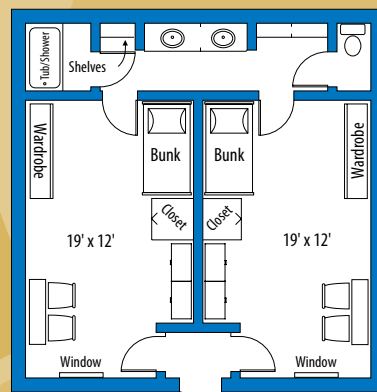

Sunflower Halls:
Two rooms, double occupancy
"Apartment Style" (2 people per room)

All three unique layout designs offer the benefit of relaxed living while maintaining your privacy.

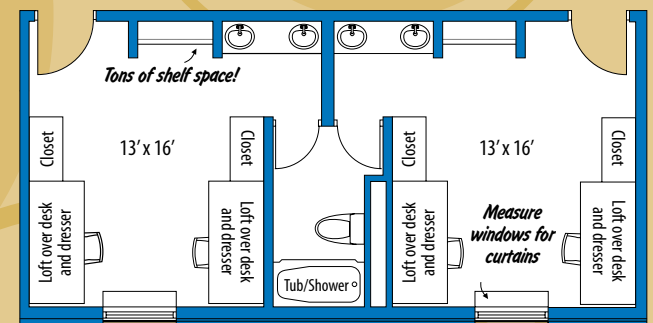

Cottonwood Hall: Handicap accessible rooms available
"Traditional Style" (2 people per room)

Features

- Wireless internet campus-wide including student housing
- Two FREE Laundromats
- Meal plan includes 19 meals per week
- FREE cable available in each room including free movie channels
- FREE parking
- Tennis courts
- Vending machines for snacks, beverages and laundry supplies
- A study desk and wardrobe area as well as extra long twin beds, bunked or lofted, in each room
- Community meeting room with big-screen color television and a Wii game console
- Special accommodations for students with disabilities
- Do-it-yourself kitchen areas available with stove, microwave, refrigerator and ice machine
- Housing complex area storm shelter
- 24-hour security and camera surveillance
- Two Eco-friendly drinking water stations
- Sand volleyball pit

2014 March

February 2014						
S	M	T	W	T	F	S
						1
2	3	4	5	6	7	8
9	10	11	12	13	14	15
16	17	18	19	20	21	22
23	24	25	26	27	28	

April 2014						
S	M	T	W	T	F	S
	1	2	3	4	5	
6	7	8	9	10	11	12
13	14	15	16	17	18	19
20	21	22	23	24	25	26
27	28	29	30			

SUNDAY	MONDAY	TUESDAY	WEDNESDAY	THURSDAY	FRIDAY	SATURDAY
						
2 Baseball at Seward CC 1 p.m.	3 Free Bingo 6 p.m., Union	4 Mardi Gras 11 a.m.-1:15 p.m., Union Baseball at Kansas Wesleyan JV 5 p.m.	5 Softball vs Bethany 2 p.m.	6 Free Bowling 7:30-10 p.m. Walnut Bowl	7 Last Day of 1st 8-Week Session Barton Theatre Musical	8 Baseball vs Colby CC 1 p.m. Softball vs Independence CC 4 p.m. Barton Theatre Musical
9 Daylight Saving Time Begins Baseball vs Colby CC 1 p.m. Barton Theatre Musical	10 First Day of 2nd 8-Week Session Meet & Greet 8 p.m., Commons/Housing	11 Financial Aid Payout	12 Baseball vs Bethany JV 5 p.m. Softball vs Colby CC \$3 Movie Night, Golden Belt Cinema 6	13	14 Softball at Seward CC	15 Priority deadline for Barton Academic Scholarship for Fall 2014 Semester Baseball at Cloud CC 1 p.m.
16 Baseball at Cloud CC 1 p.m.	17 Spring Break (No Classes/Offices Open)	18 Spring Break (No Classes/Offices Open)	19 Spring Break (No Classes/Offices Open) Softball vs Garden City CC	20 Spring Break (No Classes/Offices Closed) Baseball vs Brown Mackie 4 p.m.	21 Spring Break (No Classes/Offices Closed) Softball vs Kansas Wesleyan JV 1:30 p.m.	22 Baseball vs Butler CC 1 p.m.
23 Baseball vs Butler CC 1 p.m.	24 Men's Golf at Salina Municipal 8 a.m.	25 Financial Aid Payout	26 Baseball at Brown Mackie 4 p.m. Softball at Butler CC	27 \$3 Movie Night, Golden Belt Cinema 6	28	29 Baseball vs MCC-Longview 2 p.m. Softball vs Pratt CC
30 Baseball vs MCC-Longview 12 p.m. Women's Golf at StoneRidge 8 a.m., Great Bend	31 Women's Golf at StoneRidge 8 a.m., Great Bend					

Student Activities & Organizations

- Campus Christian Fellowship
- Cheer Squad
- Collegiate Farm Bureau
- Collegiate Music Educators National Conference
- Community Student Organization
- Computer Club
- Concert Band
- Concert Choir
- Cougar Dance Team
- Da Capo
- Debate
- Dolce
- Forensics
- Hispanic American Leadership Organization (HALO)
- International and Multicultural Society
- Jazz Band
- Journalism Crew
- Lambda Alpha Epsilon
- National Honor Societies
- Nursing Club
- Orchestra
- Pep Band
- Phi Theta Kappa
- St. Justa Pottery Guild
- Student Ambassadors
- Student Government Association
- The Hilltop Singers
- The Interrobang

College is what you make of it

Enhance
your college
experience!



Have fun!



Meet new people!



Get involved!



2014

April

March 2014						
S	M	T	W	T	F	S
						1
2	3	4	5	6	7	8
9	10	11	12	13	14	15
16	17	18	19	20	21	22
23	24	25	26	27	28	29
30	31					

May 2014						
S	M	T	W	T	F	S
						1 2 3
4	5	6	7	8	9	10
11	12	13	14	15	16	17
18	19	20	21	22	23	24
25	26	27	28	29	30	31

SUNDAY	MONDAY	TUESDAY	WEDNESDAY	THURSDAY	FRIDAY	SATURDAY
	<p><i>CollegeNEWS</i> news.bartonccc.edu</p> <p>Catch up on all the latest campus news and happenings!</p>	1	2 Softball at KCKCC 2 p.m. Baseball at Tabor JV 4 p.m.	3	4	5 Baseball at Dodge City CC 1 p.m.
6 Baseball at Dodge City CC 1 p.m. Softball vs McPherson College JV	7 Men's Golf at Rolling Meadows 8 a.m., Junction City \$3 Movie Night, Golden Belt Cinema 6	8 Financial Aid Payout	9 Last Day to Drop with Courses Recorded as "W" on Transcript Softball at Garden City CC	10 Student Government Elections 10 a.m.-1:30 p.m., Union Baseball vs Brown Mackie 6 p.m., Junction City Free Bowling 7:30-10 p.m. Walnut Bowl	11 Hilltop Singers Tour	12 Baseball vs Garden City CC 1 p.m. Softball at Colby CC Hilltop Singers Tour
13 Women's Golf at Emporia Municipal 8 a.m. Baseball vs Garden City CC 1 p.m. Softball at Colby CC Hilltop Singers Tour	14 Fall 2014 Registration Begins Women's Golf at Emporia Municipal 8 a.m. Meet & Greet 8 p.m., Commons/Housing Hilltop Singers Tour	15 Advisement Day (No Day Classes) Baseball at Hesston 5 p.m.	16 Softball at Colby CC Free Massages 6-9 p.m., Union	17 Baseball at Hutchinson CC 6 p.m.	18 Good Friday (No Classes/Offices Closed) Baseball at Hutchinson CC 1 p.m.	19 Baseball at Hutchinson CC 1 p.m.
20 Easter Sunday	21 Easter Monday (No Classes/Offices Closed) Women's Golf at Salina Municipal 8 a.m.	22 Women's Golf at Salina Municipal 8 a.m. Men's Golf at Sand Creek Station 8 a.m., Newton Free Bingo 6 p.m., Union	23 Financial Aid Payout Men's Golf at Sand Creek Station 8 a.m., Newton Baseball vs Kansas Wesleyan JV 5 p.m. Softball vs Butler CC	24 Hawaiian Night, Union	25 Softball vs Seward CC	26 Baseball vs Pratt CC 1 p.m.
27 Women's Golf at Carey Park 8 a.m., Hutchinson Baseball vs Pratt CC 1 p.m. Softball at McCook CC 2 p.m.	28 Women's Golf at Carey Park 8 a.m., Hutchinson Men's Golf at Sand Creek Station 8 a.m., Newton Softball at North Platte CC 2 p.m.	29 Men's Golf at Sand Creek Station 8 a.m., Newton	30 \$3 Movie Night, Golden Belt Cinema 6			



Learning wherever you are

BARTonline and EduKan offer seven sessions and more than 400 course selections per semester for your online degree.

HIGH SCHOOL "JUMP START" COURSES

Barton provides high school sophomores, juniors, seniors, and gifted underclassmen college classes while in high school.

Dual Credit/Concurrent Classes (College Advantage Program) -

Barton offers college classes in your high school (within Barton's seven county service area).

Get Ahead Program (GAP) - Barton's on-campus afternoon college courses are designed to give high school students a sneak peek of what to expect in a college class environment and coursework.



BARTonline: (877) 620-6606
\$137 per semester credit hour

BARTonline.org provides you the opportunity to earn or complete an Associate Degree online. Courses taken at other colleges and universities, plus any military and work experience, may be applied towards degree completion requirements at Barton.



EduKan: (877) 433-8526
\$135 per semester credit hour

EduKan.org is an online consortium consisting of Barton and five other community colleges. EduKan provides you another opportunity within the Barton family to obtain your Associate Degree online.

ONLINE LEARNING

We think you will find the overall cost very reasonable when compared to traveling and living on-campus at some colleges. Remember, you can be employed and study at the same time, because online courses can be taken around your busy schedule.

Costs for online courses are subject to change.



K-STATE AT BARTON

The Kansas State University Wildcats and the Barton Community College Cougars have joined together to form a K-State at Barton partnership.

The K-State at Barton Partnership brings education closer by:

- Offering distance education courses, bachelor's degree and master's degree programs to Central Kansas
- Developing transfer and articulation agreements between Barton and K-State
- Assisting current Barton students with admission to Kansas State University
- Providing area residents with opportunities for certification and degree completion as well as professional development

For more information, contact Jennifer Pfortmiller at (620) 786-1188 or bartondce@ksu.edu, or visit the K-State at Barton website at dce.k-state.edu/affiliations/2+2/barton.

2014

May

April 2014						
S	M	T	W	T	F	S
			1	2	3	4
6	7	8	9	10	11	12
13	14	15	16	17	18	19
20	21	22	23	24	25	26
27	28	29	30			

June 2014						
S	M	T	W	T	F	S
1	2	3	4	5	6	7
8	9	10	11	12	13	14
15	16	17	18	19	20	21
22	23	24	25	26	27	28
29	30					

SUNDAY	MONDAY	TUESDAY	WEDNESDAY	THURSDAY	FRIDAY	SATURDAY
		<p><i>CollegeNEWS</i> news.bartonccc.edu</p> <p>Catch up on all the latest campus news and happenings!</p>		1	2	Softball – Region VI Playoffs 3 Baseball – Region VI First Round
4 Baseball – Region VI First Round	5 Cinco de Mayo 11 a.m.-1:15 p.m., Union Free Bingo 6 p.m., Union Barton Music Endowment Concert	6 Financial Aid Payout	7	8 \$3 Movie Night, Golden Belt Cinema 6	9 Baseball – Region VI Championship	10 Baseball – Region VI Championship
11 Men's Golf – NJCAA Men's Golf National Championship Baseball – Region VI Championship	12 Final Examination Day Women's Golf – NJCAA Women's Golf National Championship Men's Golf – NJCAA Men's Golf National Championship Free Late Night Breakfast 9-10 p.m., Union	13 Final Examination Day Women's Golf – NJCAA Women's Golf National Championship Men's Golf – NJCAA Men's Golf National Championship	14 Final Examination Day Women's Golf – NJCAA Women's Golf National Championship Men's Golf – NJCAA Men's Golf National Championship Free Massages 6-9 p.m., Union	15 Final Examination Day Close of Spring 2014 Semester Women's Golf – NJCAA Women's Golf National Championship Men's Golf – NJCAA Men's Golf National Championship	16 Commencement	17 Airport Transportation to Wichita – Sign Up Required, Depart at 10 a.m.
18	19 Summer Hours Begin Offices Open 7:30 a.m.-5 p.m. Monday-Thursday – Closed Fridays	20	21	22	23 Campus Closed, Summer Hours	24
25	26 Memorial Day (Offices Closed)	27	28	29 Summer 2014 Registration Ends	30 Campus Closed, Summer Hours	31



Admissions

The Admissions Office, located in the Kirkman Visitor Center, has been recently updated with new furniture in the Welcome Area, new offices, and a Welcome Room for prospective students to enjoy on their tours.

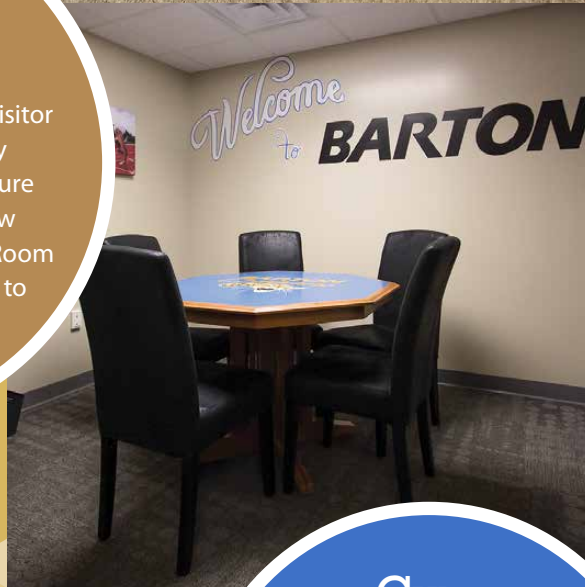

Gym

The Kirkman gym has also seen improvements over the past year. Not only has it received a fresh coat of paint, but an electronic scores table has also been added to make the gym have a more dynamic atmosphere.

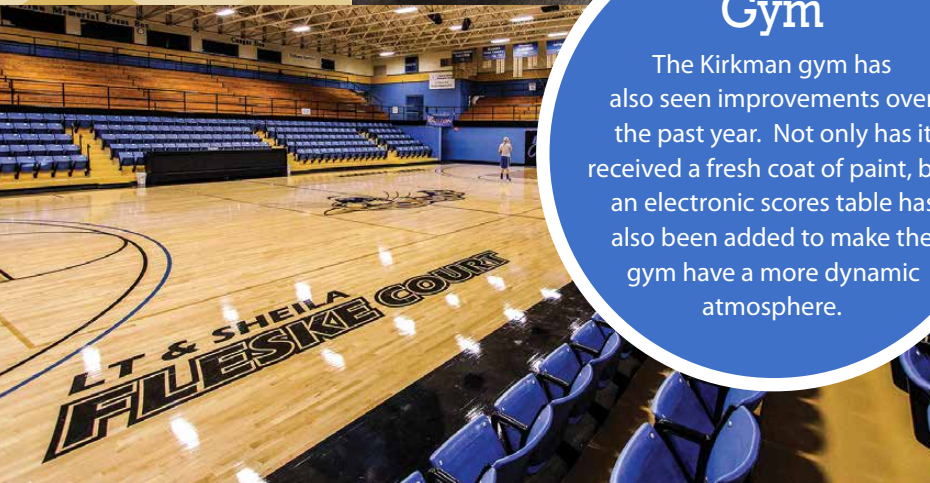

Tennis Courts

Newly surfaced tennis courts are located outside the Kirkman Activity Center provide a better practice facility for our students.

Campus Improvements



Housing

A new three floor dorm is currently being built and will be ready to open for the Fall semester of 2014!

Fine Arts Auditorium

Phase I, which included the remodeling of the theatre, is now complete and Phase II, which includes a new sound system and major upgrades to the lighting and rigging systems on stage are still to come! We are also in the planning process to remodel the Fine Arts lobby and add artwork to the center of the circle drive.



2014

June

May 2014						
S	M	T	W	T	F	S
			1	2	3	
4	5	6	7	8	9	10
11	12	13	14	15	16	17
18	19	20	21	22	23	24
25	26	27	28	29	30	31

July 2014						
S	M	T	W	T	F	S
			1	2	3	4
5	6	7	8	9	10	11
12	13	14	15	16	17	18
19	20	21	22	23	24	25
26	27	28	29	30	31	

SUNDAY	MONDAY	TUESDAY	WEDNESDAY	THURSDAY	FRIDAY	SATURDAY
1 Priority Deadline to Apply for Summer 2014 Graduation	2 Summer 2014 Classes Begin	3	4 Last Day for Late Registration for 1st 4-Week & 8-Week Sessions	5 Last Day for Refund for 1st 4-Week & 8-Week Sessions	6 Campus Closed, Summer Hours	7
8	9	10	11	12	13 Campus Closed, Summer Hours	14
15	16	17	18	19	20 Campus Closed, Summer Hours	21 Summer Begins
22	23 No Drops/Withdrawals for 1st 4-Week Session	24 Financial Aid Payout	25	26 Last Day of Classes for 1st 4-Week Session	27 Campus Closed, Summer Hours	28
29	30 First Day of Classes for 2nd 4-Week Session					

CollegeNEWS
news.bartonccc.edu

Catch up on all the latest campus news and happenings!



Local Opportunities

Our campus and community are growing and improving!

Great places ...
Great people ...
Great Bend!



City of Great Bend

Listed as a "Best Places" city by *U.S. News & World Report*, come spend a day with great people in a great place ... Great Bend!!

With more than 15,000 residents, visit Great Bend and find a wide variety of things to do while enjoying a small town with all the amenities of a small city.



www.freedom4uphotos.com

COMMUNITY EVENTS

- Cinco de Mayo Celebration
- Championship Drag Racing
- The Barton County Fair
- June Jaunt
- Polka Days
- Community Theatre in the historic Crest Theatre
- Barton County Historical Museum and Village
- Big Bend Bike Rally

BRIT SPAUGH PARK

- Brit Spaugh Zoo
- Skateboard park
- BMX bike park
- Baseball and softball diamonds
- Tennis courts
- Horseshoe pits
- Wetlands Aquatic Park

VETERAN'S MEMORIAL PARK

- Fishing lake
- Limited boating: canoe, kayak
- Ball field complex
- Baseball and softball fields
- Tennis courts
- Physical fitness trail
- Walking trail with floating bridge
- Floating fishing dock
- Argonne Forest
- Assorted play equipment
- Sand beach
- Sand beach volleyball
- Dog park

OTHER

Wetlands Aquatic Park

Zoom down the slides, soak in the sun, or kick back and relax in the shade at the Wetlands Aquatic Park. The Wetlands features 8 slides, 39 spray "features," a 10,000 sq. foot swimming pool, Water Wars, and ONE BIG BUCKET dropping more than 300 gallons of water over the top of anyone daring to stand below.

Trail of Lights

The award-winning Trail of Lights holiday displays are like coming home to a perfect little Midwestern Christmas village.

Cheyenne Bottoms Wildlife Refuge

Designated a "Wetland of International Importance," the refuge is a 41,000-acre basin-like lowland and is considered the largest marsh in the interior of the United States.



The L. E. "Gus" and Eva Shafer Memorial Art Gallery has been referred to as the "Gem of the Campus" at Barton. With 7,700 square feet of exhibit space, the gallery sees more than 7,000 annual visitors. Including the works of Shafer, the exhibit displays art from various artists, students, and exhibits from around the country.

2014

July

June 2014

S	M	T	W	T	F	S
1	2	3	4	5	6	7
8	9	10	11	12	13	14
15	16	17	18	19	20	21
22	23	24	25	26	27	28
29	30					

August 2014

S	M	T	W	T	F	S
						1
2	3	4	5	6	7	8
9	10	11	12	13	14	15
16	17	18	19	20	21	22
23	24	25	26	27	28	29
30	31					

SUNDAY	MONDAY	TUESDAY	WEDNESDAY	THURSDAY	FRIDAY	SATURDAY
	<i>CollegeNEWS</i> <small>news.bartonccc.edu</small> <i>Catch up on all the latest campus news and happenings!</i>	1	2	3	4 Independence Day (No Classes/Offices Closed)	5
6	7 Last Day for Late Registration for 2nd 4-Week Session Last Day for Refund for 2nd 4-Week Session	8	9	10	11 Campus Closed, Summer Hours	12
13	14	15	16	17 No Drops/Withdrawals for 8-Week Session Financial Aid Payout	18 Campus Closed, Summer Hours	19
20	21	22 No Drops/Withdrawals for 2nd 4-Week Session	23	24 Last Day of Classes for 8-Week Session Last Day of Classes for 2nd 4-Week Session	25 Campus Closed, Summer Hours	26
27	28	29	30	31 Financial Aid Payout		

Living the Dream

Succeeding in class is important but so is succeeding in life. At Barton, the knowledge you learn in the classroom will help you apply it to what really matters... real life.

The Barton Experience is flexible, agile and ready to accommodate students from all walks of life!



Barton provides opportunities to get involved, perhaps even "RE-INVENT ONESELF." With more than 30 clubs, organizations, and performance groups there is something for everyone to live the dream!

Whether you want face-to-face **TRADITIONAL CLASSROOM SETTINGS, ONLINE CLASSES** that adapt to your busy schedule, or **HYBRID CLASSES** which blend classroom and online instruction, Barton has classes to fit your needs and schedule.



The faculty and staff at Barton **TRULY CARE ABOUT YOU AS A PERSON** first and foremost.



Get job training quickly to help you either **GET TO THE WORKFORCE OR IMPROVE YOUR SKILLS** at your current workplace.

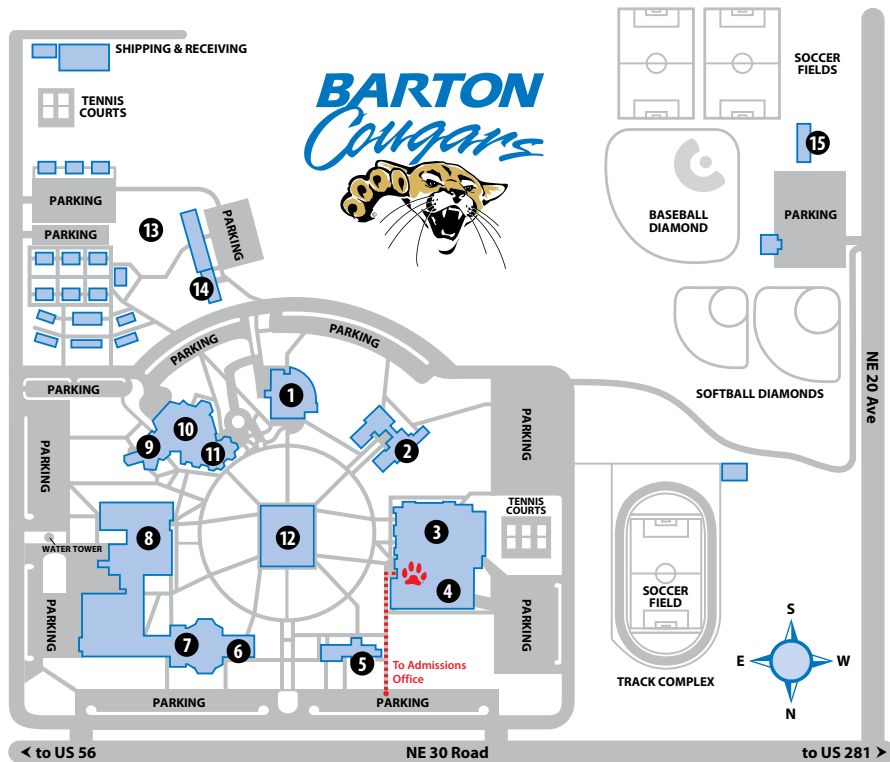

- | | |
|-----------------------------------|---|
| 1 U-Building, Union | 9 F-30, Seminar Room |
| 2 C-Building, Classroom | 10 F-Building, Fine Arts |
| 3 P-Building, Physical Education | 11 Shafer Gallery |
| 4 Kirkman Student Activity Center | 12 L-Building, Learning Resources Center |
| 5 A-Building, Administration | 13 Student Housing |
| 6 Planetarium | 14 Child Development Center |
| 7 S-Building, Science & Math | 15 Midwest Utility Pipeline Training Center |
| 8 T-Building, Technical Education | |

The Mission of Barton Community College is to provide quality educational opportunities that are accessible, affordable, continuously improving and student focused. Barton is driven to provide an educational system that is learning-centered, innovative, meets workforce needs, and strengthens communities.

BARTON
COMMUNITY COLLEGE

245 NE 30 RD • Great Bend, KS 67530-9251
(800) 722-6842 • GoBarton.com



About our campuses

Great Bend Campus

bartonccc.edu

Barton's main campus is located high atop a hill on 160 acres three miles northeast of Great Bend. The main campus includes eight primary buildings, four phases of student housing, the Cougar fields, and the Midwest Utility Pipeline Training Center.

Fort Riley Campus

fr.bartonccc.edu

Barton's proud association with Fort Riley and the U.S. Army began in 1984 with a single training contract. The Fort Riley campus administration building is located in Building 217 on the main post of Fort Riley. The campus also provides instructional services for Troop School, BSEP and LSEC, which are located on Custer Hill.

In addition, BARTonline, Barton's premier site for online courses, is administered from

the Fort Riley campus.







Courses also are offered at a nearby outreach site located at Grandview Plaza, which is home to the Hazardous Materials Handling and Emergency Management, Emergency Medical Technician, and Paramedic programs.

Fort Leavenworth Campus

fl.bartonccc.edu

Barton opened a campus on Fort Leavenworth in 2012. With nearly three decades of experience operating a military-based campus at Fort Riley, Barton was well-equipped to hit the ground running. The Fort Leavenworth campus office is located in the basement of the Army Education Center at 120 Dickman Ave. Fort Leavenworth, KS 66027. The campus also provides instructional services for BSEP and LSEC and a criminal justice program.

COUGAR CHECKLIST

-  **Campus Tour** - A great way to see if Barton is the place for you!
-  **Admissions/Scholarship Application** - Remember Barton's academic scholarship deadline is March 15 for the fall semester and November 15 for the spring semester. Application available online.
-  **Submit ACT Scores or ASSET test scores** - Haven't taken either of these assessment tests? No problem! Just give us a call and we'll get you taken care of.
-  **Submit completed transcript(s)** - Completed transcripts must be mailed directly to the Barton Admissions Office to be official. Unofficial transcripts can be used for advising and obtaining academic information (GPA, ACT Scores, etc.)
-  **Housing Application** - Submit application and deposit early to get your first choice! Application available online.
-  **Financial Aid** - Cost should not be a reason to rule out college! Visit fafsa.ed.gov for federal assistance or call us for even more options!

SEE Y♥U SOON!

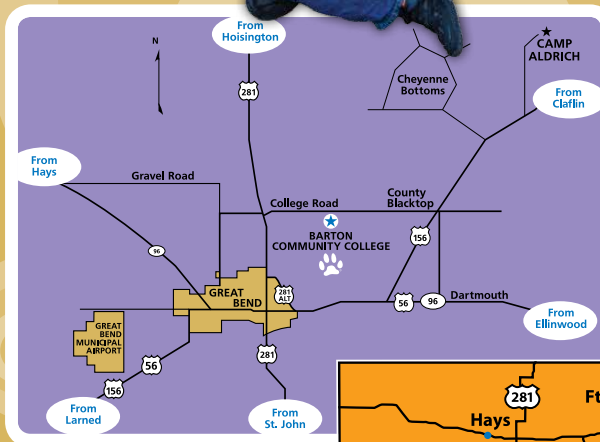

DIRECTORY INFORMATION

-  **WEB ADDRESS**
GoBarton.com
-  **BARTON COUNTY CAMPUS (main campus)**
Local: (620) 792-2701
Toll-Free: (800) 748-7594
Address:
245 NE 30 RD
Great Bend, KS 67530
-  **FORT RILEY CAMPUS**
Local: (785) 784-6606
Toll-Free: (877) 620-6606
Address:
P.O. Box 2463, Building 217
Fort Riley, KS 66442
fr.bartonccc.edu
-  **FORT LEAVENWORTH CAMPUS**
Local: (913) 684-9384
Toll-Free: (855) 509-3374
Address:
120 Dickman Ave.
Fort Leavenworth, KS 66027
fl.bartonccc.edu
-  **GRANDVIEW PLAZA OUTREACH SITE**
Local: (785) 238-8550
Toll-Free: (877) 771-0255
Address:
100 Continental Avenue
Grandview Plaza, KS 66441
-  **ONLINE LEARNING OPPORTUNITIES**
BARTonline.org
(877) 620-6606

edukan.org
(877) 433-8526

For more information, call the Admissions Office at (800) 722-6842 or (620) 792-9286



Want to get started?

Non-Discrimination Notice: To provide equal employment, advancement and learning opportunities to all individuals, employment and student admission decisions at Barton will be based on merit, qualifications, and abilities. Barton County Community College does not discriminate on the basis of any characteristic protected by law in all aspects of employment and admission in its education programs or activities. Any person having inquiries concerning Barton County Community College's non-discrimination compliance policy, including the application of Equal Opportunity Employment, Titles IV, VI, VII, IX, Section 504 and the implementing regulations, is directed to contact the College's Compliance Officer, Barton County Community College, Room A-123, Great Bend, Kansas 67530, (620) 792-2701. Any person may also contact the Director, Office of Civil Rights, U.S. Department of Education, Washington, DC 20201.

For more information about our graduation rates, the median debt of students who completed the program, and other important information, please visit our website at ge.bartonccc.edu

